



**LOW IMPACT  
INDUSTRY  
TRANSPORT DEPOT**

**MAINTENANCE SHED**  
300 sq.metres containing  
Office  
Amenities and Lunch Room  
Workshop and Storage  
Work area with service pit

**STORAGE FACILITIES**  
180 sq. m Storage Facilities

**COVERED BUSPARK**  
600 sq.metres

**ADMINISTRATION BLDG**  
366 sq.metres containing  
Reception  
General Offices  
Private Offices x 5  
Meeting Rooms x 2  
Lunch room  
Amenities  
Carparking spaces provided - 13

**TRAIN DISPLAY SHELTER**  
300 sq.metres

**STORAGE SHED**  
40 sq.metres

A 29-06-21 ISSUED FOR COUNCIL APPROVAL  
REVISIONS  
DRAWING

**MASTER SITE PLAN**

**PROJECT**  
NEW INFRASTRUCTURE  
FACILITIES  
95 EAGLE STREET  
LONGREACH  
QUEENSLAND

FOR  
OUTBACK AUSSIE TOURS



**GREENWAY**  
GREENWAY (S.C.) PTY. LTD.  
A.C.N. 067 535 068  
PO BOX 648, MOOLOOLABA 4557  
PH: 07 54446211 MOB: 0411 286 154  
E: support@greenwayarchitects.com

CONTRACTORS ARE TO VERIFY ALL DIMENSIONS ON THE JOB BEFORE COMMENCING ANY WORK OR MAKING SHOP DRAWINGS

DRAWN	DATE
TW SMITH	9 JUNE 2021

SCALE	CHECKED
AS SHOWN	

PROJECT	SHEET	REVISION
M20.001	CP 1.01	A

**LONGREACH REGIONAL COUNCIL**  
**DIGITALLY STAMPED**  
**APPROVED PLAN**  
**Development Application: Minor Change to Development Permit DA19/20-006 for Material Change of Use for Low Impact Industry and Transport Depot**  
**Lot: Lot 1651 on SP309934**  
Referred to in Council's Decision Notice  
**Approval Date:** 15 July 2021  
**Application Number:** DA 20/21-011

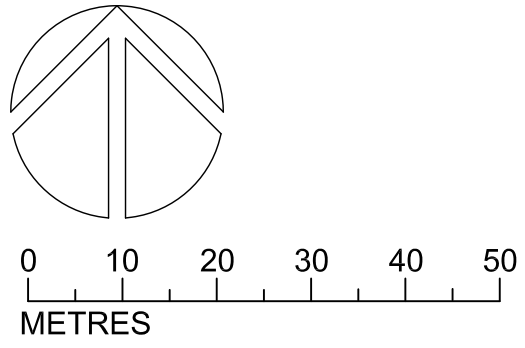

# LOW IMPACT INDUSTRY TRANSPORT DEPOT

**MAINTENANCE SHED**  
300 sq.metres containing  
Office  
Amenities and Lunch Room  
Workshop and Storage  
Work area with service pit

**STORAGE FACILITIES**  
180 sq. m Storage Facilities

**COVERED BUSPARK**  
600 sq.metres

**ADMINISTRATION BLDG**  
366 sq.metres containing  
Reception  
General Offices  
Private Offices x 5  
Meeting Rooms x 2  
Lunch room  
Amenities  
Carparking spaces provided - 13

**TRAIN DISPLAY SHELTER**  
300 sq.metres

**STORAGE SHED**  
40 sq.metres

A 29-06-21 ISSUED FOR COUNCIL APPROVAL

REVISIONS

DRAWING

## MASTER SITE PLAN STAGING

PROJECT  
**NEW INFRASTRUCTURE  
FACILITIES**  
95 EAGLE STREET  
LONGREACH  
QUEENSLAND

FOR

**OUTBACK AUSSIE TOURS**



**GREENWAY**

GREENWAY (S.C.) PTY. LTD.

A.C.N. 067 535 068  
PO BOX 648, MOOLOOLABA 4557  
PH: 07 54446211 MOB: 0411 286 154  
E: support@greenwayarchitects.com

CONTRACTORS ARE TO VERIFY ALL DIMENSIONS ON THE JOB  
BEFORE COMMENCING ANY WORK OR MAKING SHOP DRAWINGS

DRAWN	DATE
TW SMITH	9 JUNE 2021

SCALE	CHECKED
AS SHOWN	

PROJECT	SHEET	REVISION
M20.001	CP 1.02	A

**LONGREACH REGIONAL COUNCIL**  
**DIGITALLY STAMPED**  
**APPROVED PLAN**

Development Application: Minor Change to Development Permit DA19/20-006 for Material Change of Use for Low Impact Industry and Transport Depot  
Lot: Lot 1651 on SP309934

Referred to in Council's Decision Notice

Approval Date: 15 July 2021  
Application Number: DA 20/21-011

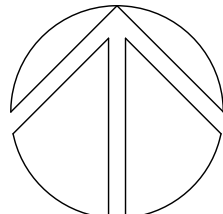
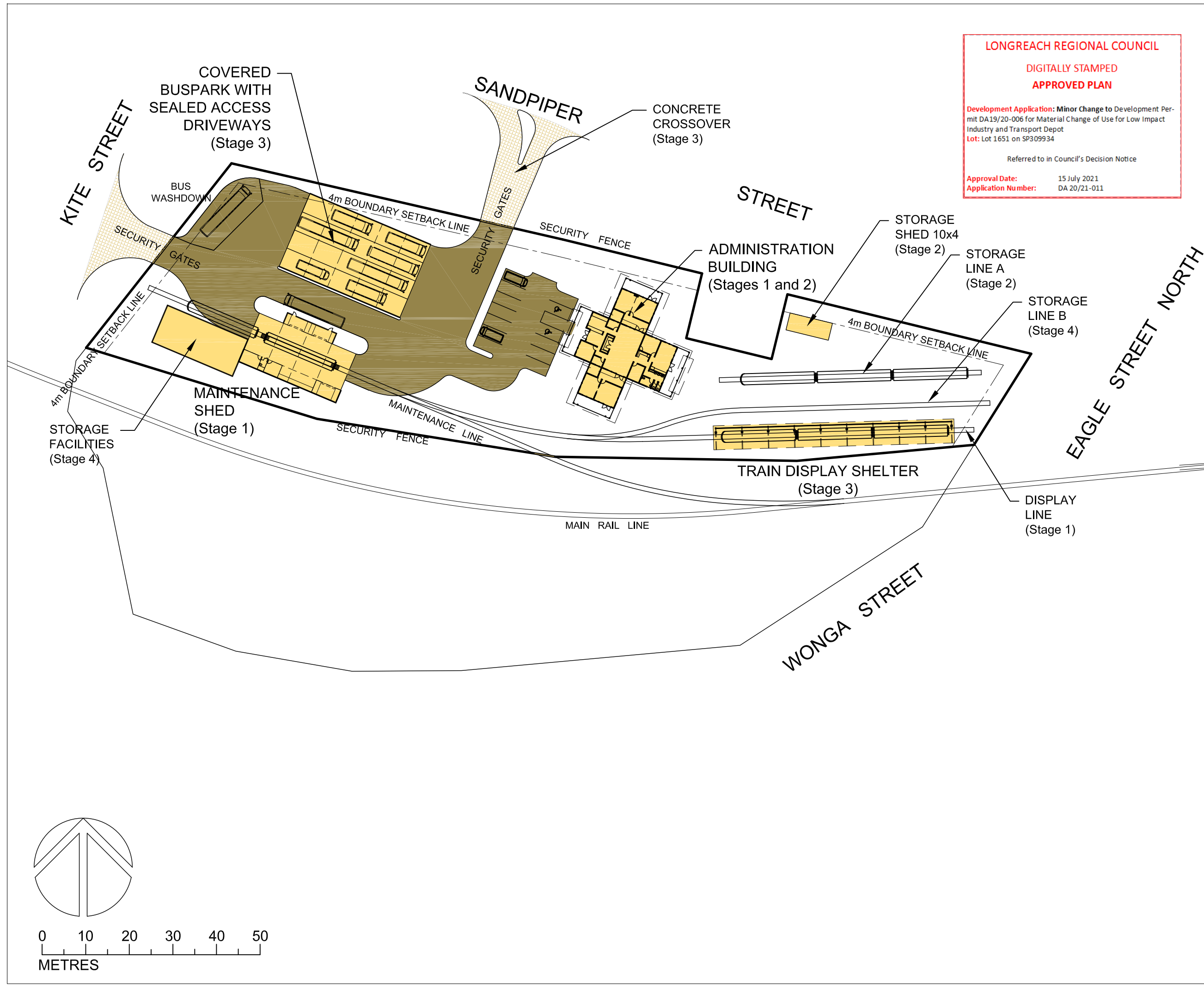

0 10 20 30 40 50  
METRES

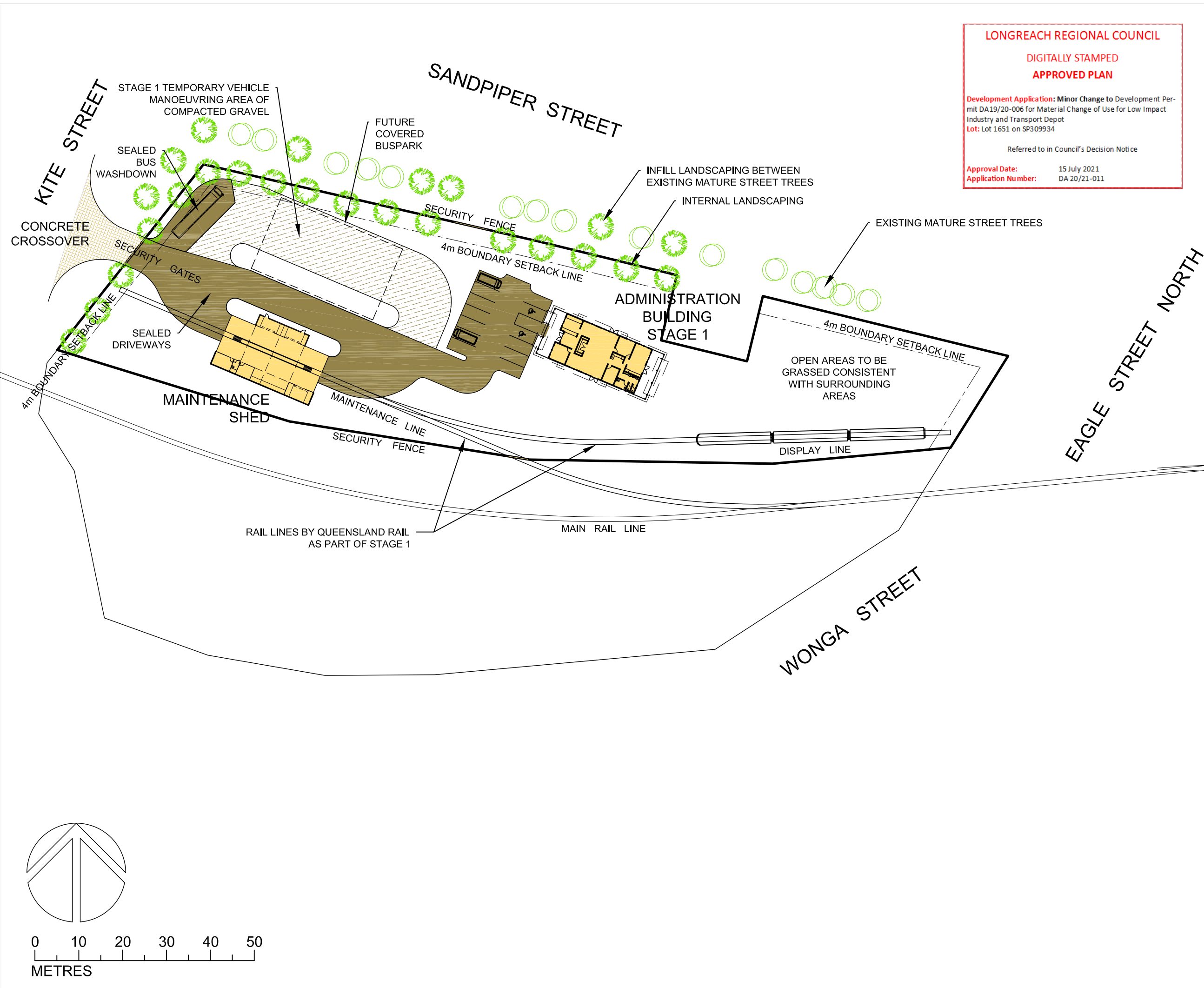

**LONGREACH REGIONAL COUNCIL**  
 DIGITALLY STAMPED  
**APPROVED PLAN**

Development Application: Minor Change to Development Permit DA19/20-006 for Material Change of Use for Low Impact Industry and Transport Depot  
 Lot: Lot 1651 on SP309934

Referred to in Council's Decision Notice

Approval Date: 15 July 2021  
 Application Number: DA 20/21-011

**LOW IMPACT INDUSTRY TRANSPORT DEPOT**

**MAINTENANCE SHED**  
 300 sq.metres

**ADMINISTRATION BLDG**  
 231 sq.metres

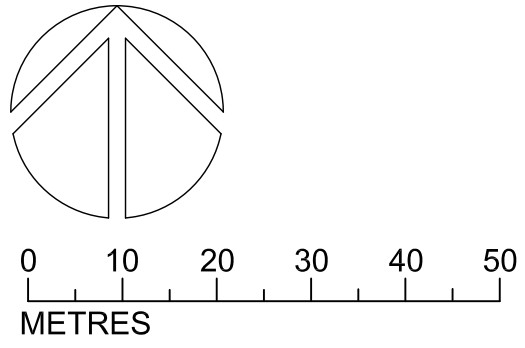

A 29-06-21 ISSUED FOR COUNCIL APPROVAL  
 REVISIONS  
 DRAWING

**CONCEPT SITE PLAN  
 STAGE 1**

PROJECT  
**NEW INFRASTRUCTURE FACILITIES**  
 95 EAGLE STREET  
 LONGREACH  
 QUEENSLAND

FOR  
**OUTBACK AUSSIE TOURS**

**GREENWAY**  
 GREENWAY (S.C.) PTY. LTD.  
A.C.N. 067 535 068  
 PO BOX 648, MOOLOOLABA 4557  
 PH: 07 54446211 MOB: 0411 286 154  
 E: support@greenwayarchitects.com

CONTRACTORS ARE TO VERIFY ALL DIMENSIONS ON THE JOB BEFORE COMMENCING ANY WORK OR MAKING SHOP DRAWINGS

<small>DRAWN</small>	<small>DATE</small>
TW SMITH	9 JUNE 2021
<small>SCALE</small>	<small>CHECKED</small>
AS SHOWN	
<small>PROJECT</small>	<small>SHEET</small>
M20.001	CP 1.03
	<small>REVISION</small>
	A

KITE STREET

SANDPIPER STREET

EAGLE STREET NORTH

WONGA STREET

**LONGREACH REGIONAL COUNCIL**  
**DIGITALLY STAMPED**  
**APPROVED PLAN**

Development Application: Minor Change to Development Permit DA19/20-006 for Material Change of Use for Low Impact Industry and Transport Depot  
 Lot: Lot 1651 on SP309934

Referred to in Council's Decision Notice

Approval Date: 15 July 2021  
 Application Number: DA 20/21-011

LOW IMPACT INDUSTRY TRANSPORT DEPOT

ADMINISTRATION BLDG  
135 sq.metres

STORAGE SHED  
40 sq.metres

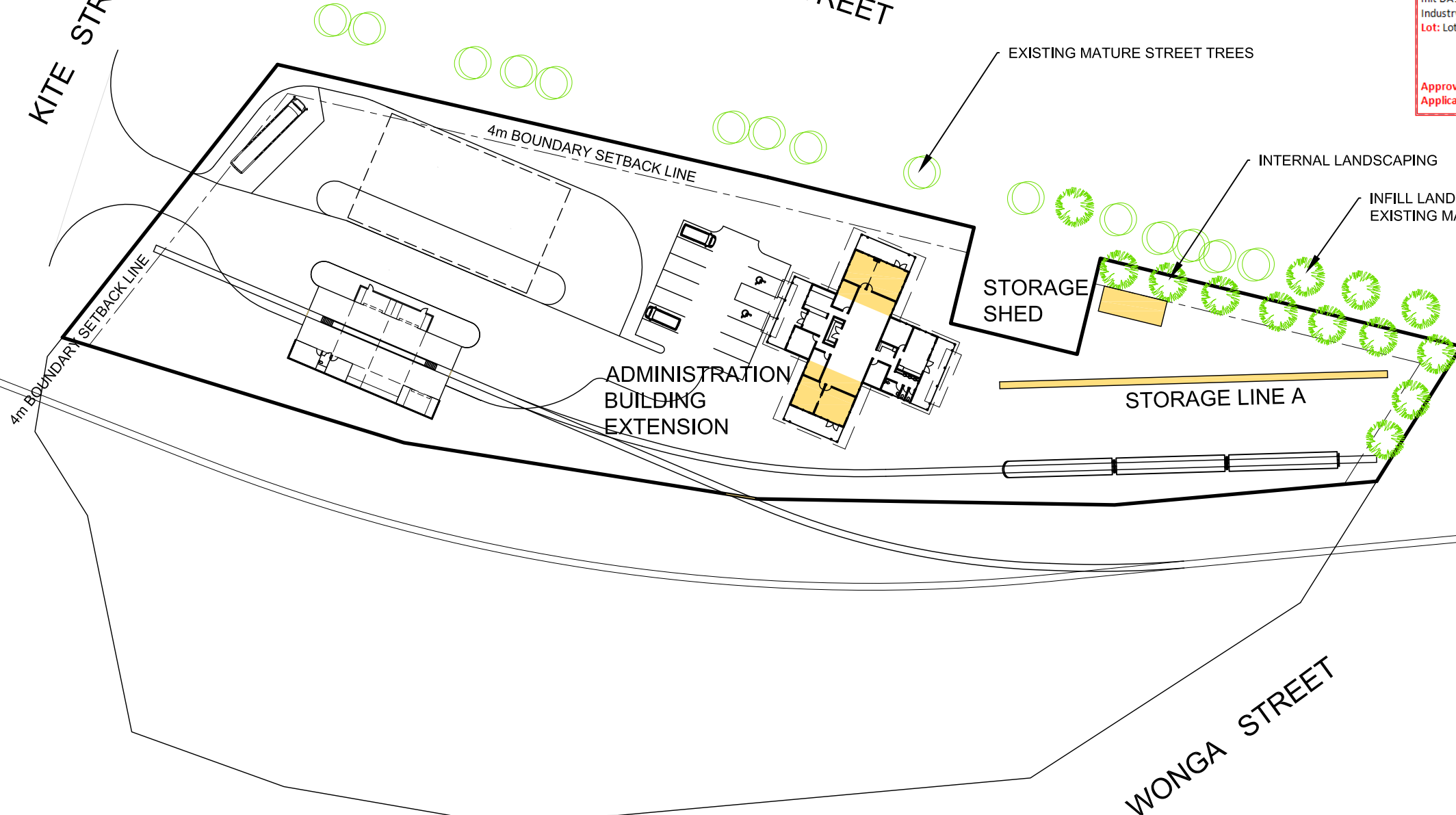

A 29-06-21 ISSUED FOR COUNCIL APPROVAL  
REVISIONS

CONCEPT SITE PLAN  
STAGE 2

PROJECT  
NEW INFRASTRUCTURE FACILITIES  
95 EAGLE STREET  
LONGREACH  
QUEENSLAND

FOR  
OUTBACK AUSSIE TOURS

**GREENWAY**  
 GREENWAY (S.C.) PTY. LTD.  
 A.C.N. 067 535 068  
 PO BOX 648, MOOLOOLABA 4557  
 PH: 07 54446211 MOB: 0411 286 154  
 E: support@greenwayarchitects.com

CONTRACTORS ARE TO VERIFY ALL DIMENSIONS ON THE JOB BEFORE COMMENCING ANY WORK OR MAKING SHOP DRAWINGS

DRAWN	DATE
TW SMITH	9 JUNE 2021

SCALE	CHECKED
AS SHOWN	

PROJECT	SHEET	REVISION
M20.001	CP 1.04	A

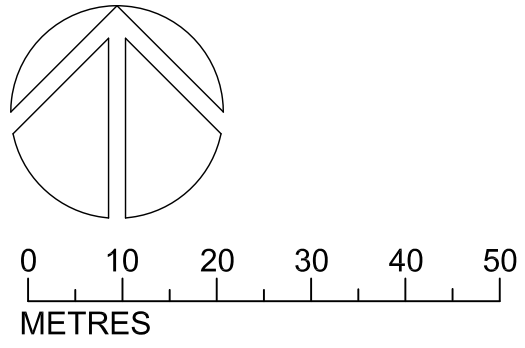

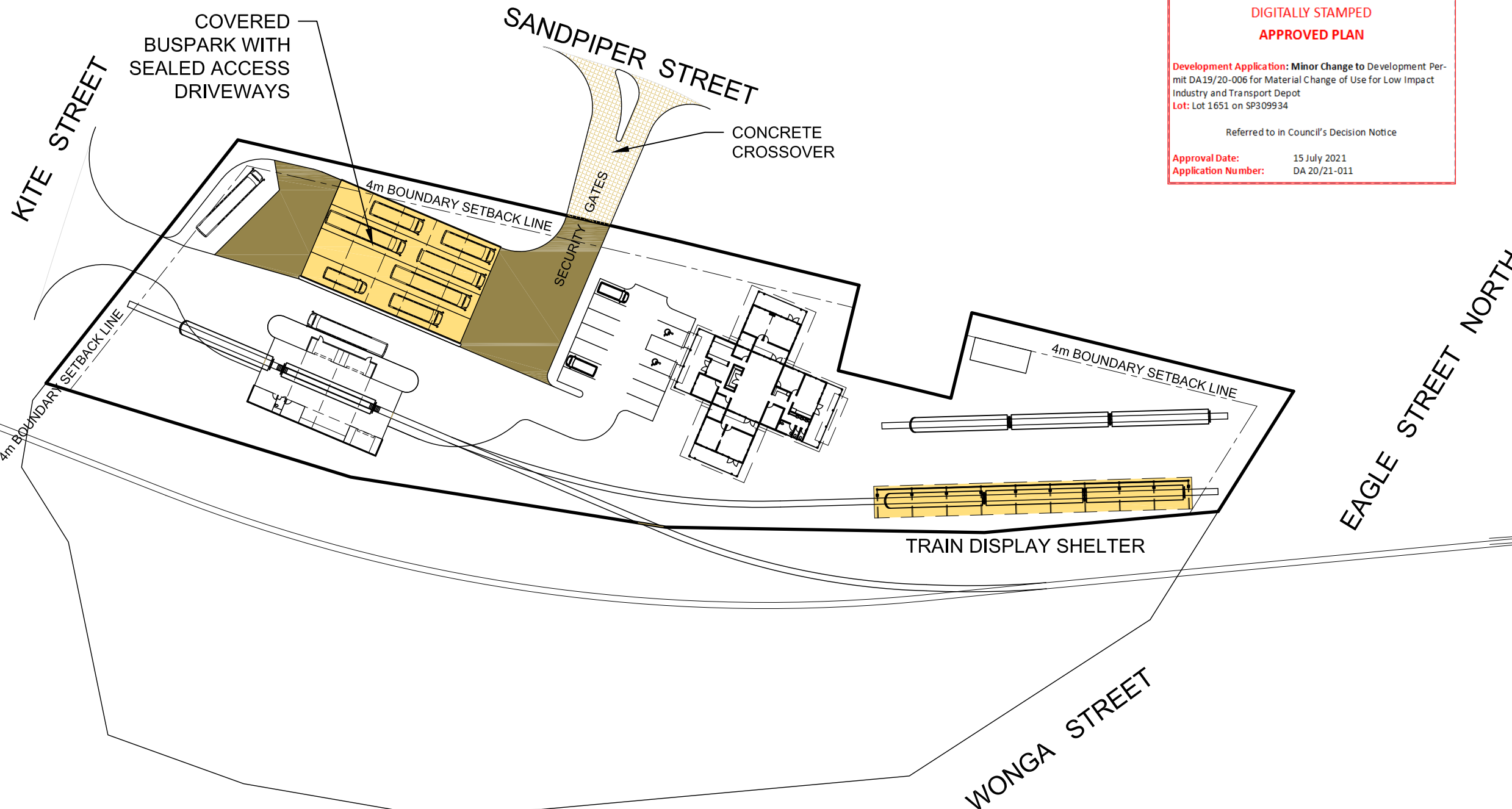

**LONGREACH REGIONAL COUNCIL**  
**DIGITALLY STAMPED**  
**APPROVED PLAN**

Development Application: Minor Change to Development Permit DA19/20-006 for Material Change of Use for Low Impact Industry and Transport Depot  
 Lot: Lot 1651 on SP309934

Referred to in Council's Decision Notice

Approval Date: 15 July 2021  
 Application Number: DA 20/21-011

**LOW IMPACT  
 INDUSTRY  
 TRANSPORT DEPOT**

**COVERED BUSPARK**  
 600 sq.metres

**TRAIN DISPLAY SHELTER**  
 300 sq.metres

A 29-06-21 ISSUED FOR COUNCIL APPROVAL  
 REVISIONS

DRAWING  
**CONCEPT SITE PLAN  
 STAGE 3**

PROJECT  
**NEW INFRASTRUCTURE  
 FACILITIES**  
 95 EAGLE STREET  
 LONGREACH  
 QUEENSLAND

FOR  
**OUTBACK AUSSIE TOURS**

**GREENWAY**  
 GREENWAY (S.C.) PTY. LTD.  
A.C.N. 067 535 068  
 PO BOX 648, MOOLOOLABA 4557  
 PH: 07 54446211 MOB: 0411 286 154  
 E: support@greenwayarchitects.com

CONTRACTORS ARE TO VERIFY ALL DIMENSIONS ON THE JOB  
 BEFORE COMMENCING ANY WORK OR MAKING SHOP DRAWINGS

DRAWN	DATE
TW SMITH	9 JUNE 2021

SCALE	CHECKED
AS SHOWN	

PROJECT	SHEET	REVISION
M20.001	CP 1.05	A

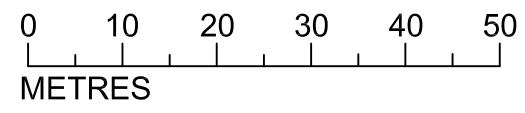
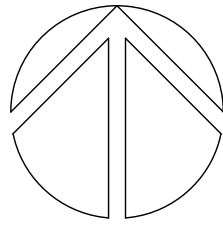

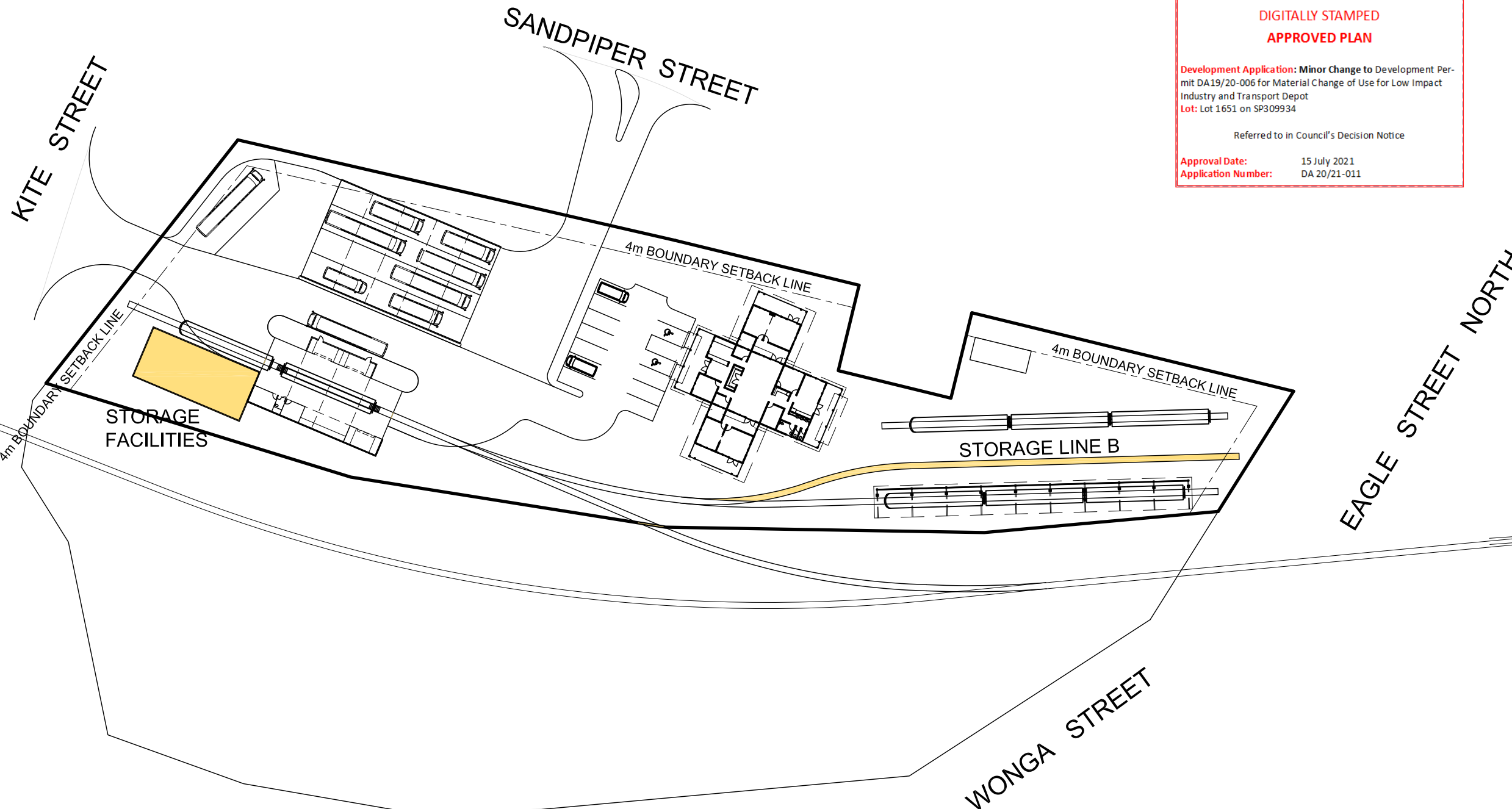

**LONGREACH REGIONAL COUNCIL**  
 DIGITALLY STAMPED  
**APPROVED PLAN**

**Development Application: Minor Change to Development Permit DA19/20-006 for Material Change of Use for Low Impact Industry and Transport Depot**  
**Lot: Lot 1651 on SP309934**

Referred to in Council's Decision Notice

**Approval Date:** 15 July 2021  
**Application Number:** DA 20/21-011

**LOW IMPACT  
 INDUSTRY  
 TRANSPORT DEPOT**

**STORAGE FACILITIES**  
 180 sq. m

A 29-06-21 ISSUED FOR COUNCIL APPROVAL  
 REVISIONS

DRAWING  
**CONCEPT SITE PLAN  
 STAGE 4**

PROJECT  
**NEW INFRASTRUCTURE  
 FACILITIES**  
 95 EAGLE STREET  
 LONGREACH  
 QUEENSLAND

FOR  
**OUTBACK AUSSIE TOURS**



**GREENWAY**  
 GREENWAY (S.C.) PTY. LTD.  
 A.C.N. 067 535 068  
 PO BOX 648, MOOLOOLABA 4557  
 PH: 07 54446211 MOB: 0411 286 154  
 E: support@greenwayarchitects.com

CONTRACTORS ARE TO VERIFY ALL DIMENSIONS ON THE JOB  
 BEFORE COMMENCING ANY WORK OR MAKING SHOP DRAWINGS

DRAWN	DATE
TW SMITH	9 JUNE 2021

SCALE	CHECKED
AS SHOWN	

PROJECT	SHEET	REVISION
M20.001	CP 1.06	A

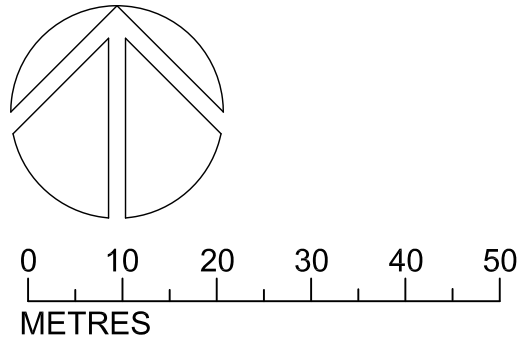

**LONGREACH REGIONAL COUNCIL**

**DIGITALLY STAMPED  
APPROVED PLAN**

**Development Application:** Minor Change to Development Permit DA19/20-006 for Material Change of Use for Low Impact Industry and Transport Depot  
**Lot:** Lot 1651 on SP309934

Referred to in Council's Decision Notice

**Approval Date:** 15 July 2021  
**Application Number:** DA 20/21-011

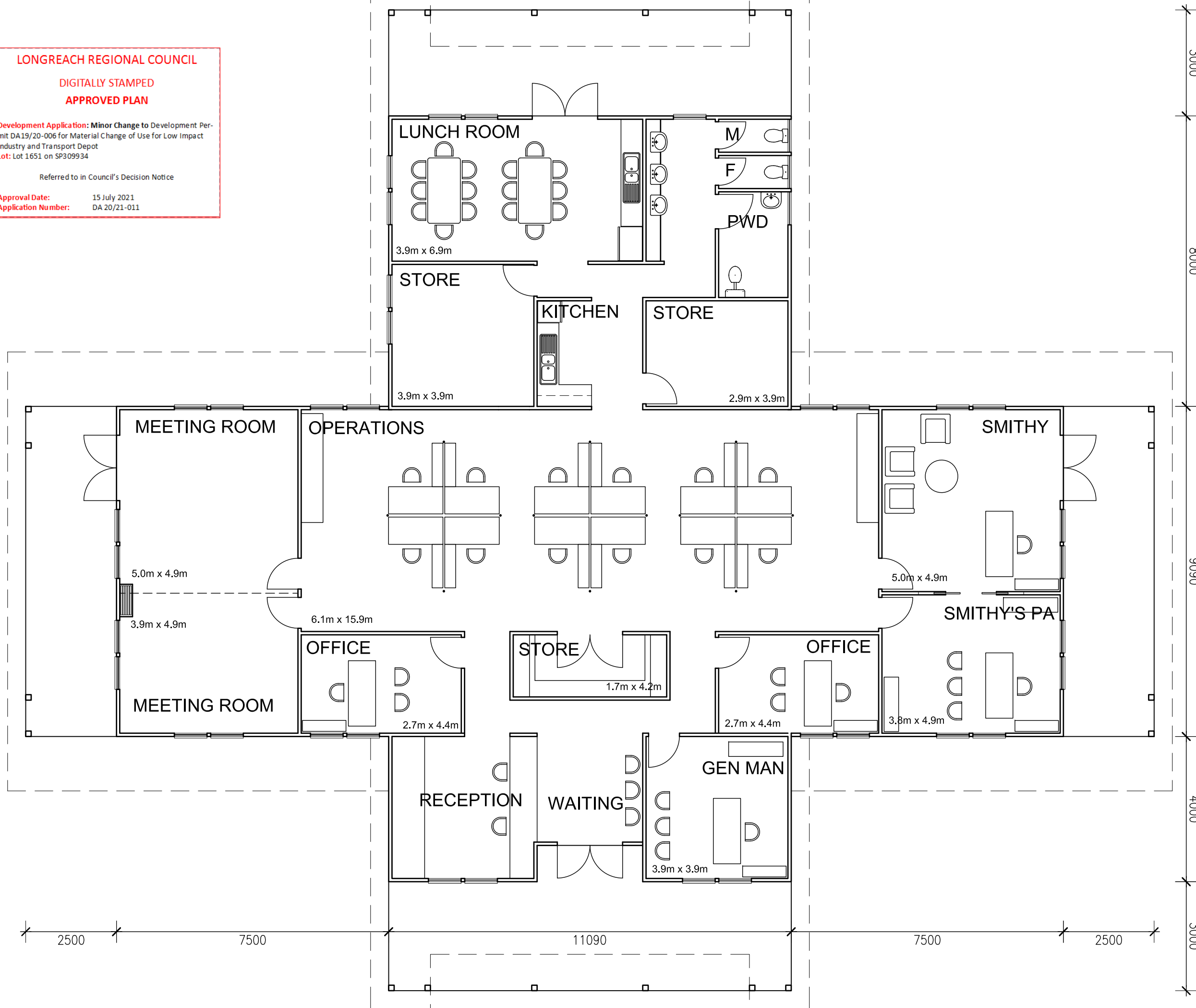
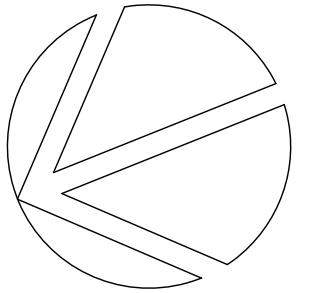

A 29-06-21 ISSUED FOR COUNCIL APPROVAL  
REVISIONS

**DRAWING**  
CONCEPT FLOOR PLAN  
NEW ADMIN BUILDING  
STAGES 1 and 2

**PROJECT**  
NEW INFRASTRUCTURE  
FACILITIES  
95 EAGLE STREET  
LONGREACH  
QUEENSLAND

FOR  
OUTBACK AUSSIE TOURS



A: PO Box 648 | Mooloolaba 4557 | QLD | Australia  
T: +61 (0) 7 5444 6211 | M: +61 (0) 411 286 154 | ABN: 68 067 535 068  
E: support@greenwayarchitects.com | W: www.greenwayarchitects.com

CONTRACTORS ARE TO VERIFY ALL DIMENSIONS ON THE JOB  
BEFORE COMMENCING ANY WORK OR MAKING SHOP DRAWINGS

DRAWN	DATE	
TW SMITH	9 JUNE 2021	
SCALE	CHECKED	
1 : 100 @A3		
JOB	SHEET	REVISION
M20.001	CP 2.01	A

**LONGREACH REGIONAL COUNCIL**

**DIGITALLY STAMPED  
APPROVED PLAN**

**Development Application:** Minor Change to Development Permit DA19/20-006 for Material Change of Use for Low Impact Industry and Transport Depot  
**Lot:** Lot 1651 on SP309934

Referred to in Council's Decision Notice

**Approval Date:** 15 July 2021  
**Application Number:** DA 20/21-011

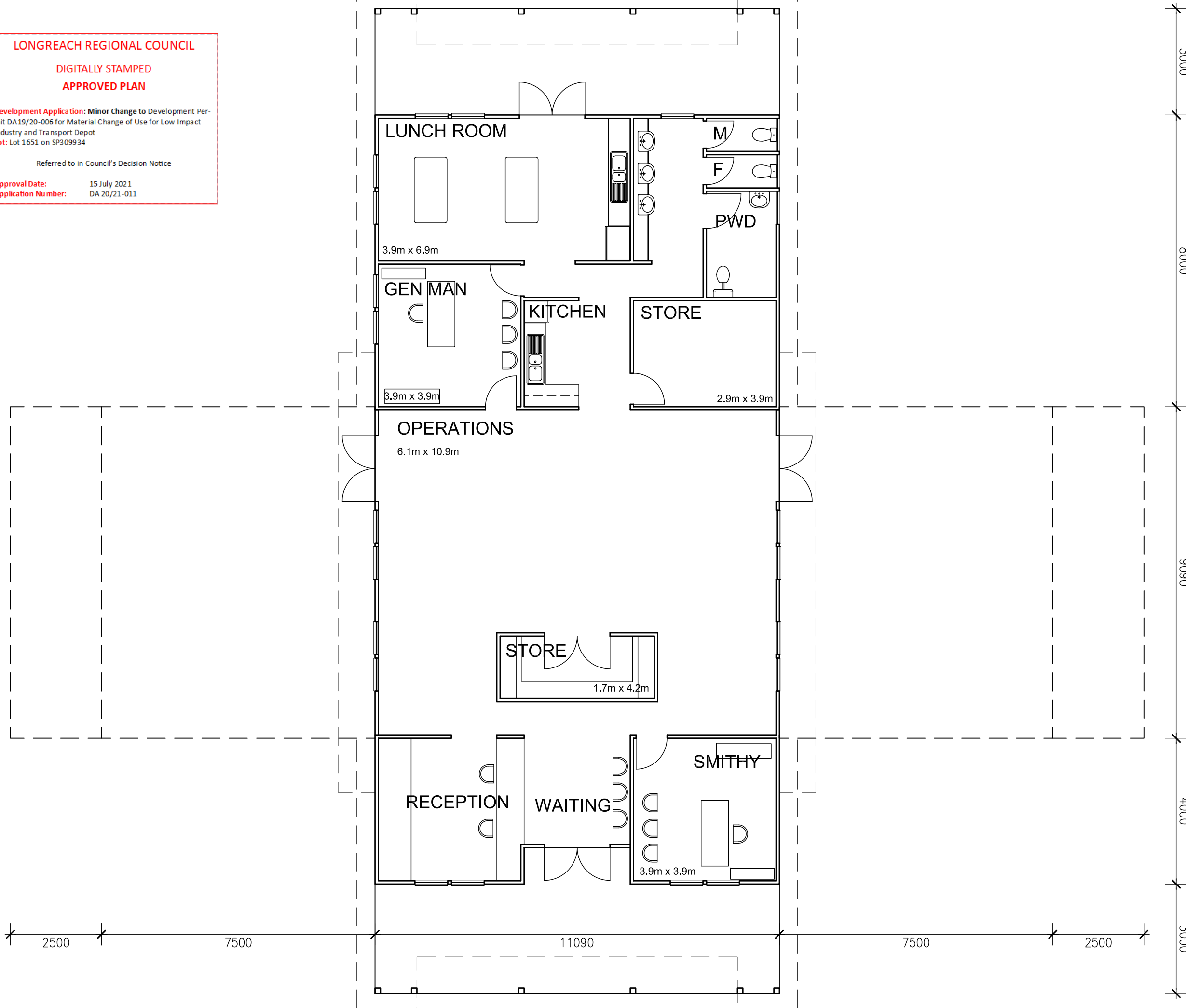
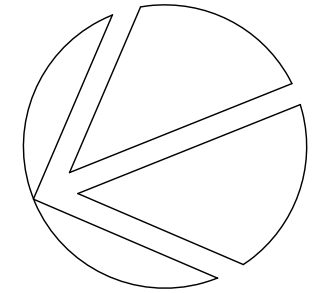

A 29-06-21 ISSUED FOR COUNCIL APPROVAL  
REVISIONS

**DRAWING**  
CONCEPT FLOOR PLAN  
NEW ADMIN BUILDING  
STAGE 1

**PROJECT**  
NEW INFRASTRUCTURE  
FACILITIES  
95 EAGLE STREET  
LONGREACH  
QUEENSLAND

FOR  
OUTBACK AUSSIE TOURS



A: PO Box 648 | Mooloolaba 4557 | QLD | Australia  
T: +61 (0) 7 5444 6211 | M: +61 (0) 411 286 154 | ABN: 68 067 535 068  
E: support@greenwayarchitects.com | W: www.greenwayarchitects.com

CONTRACTORS ARE TO VERIFY ALL DIMENSIONS ON THE JOB  
BEFORE COMMENCING ANY WORK OR MAKING SHOP DRAWINGS

DRAWN	DATE
TW SMITH	9 JUNE 2021

SCALE	CHECKED
1 : 100 @A3	

JOB	SHEET	REVISION
M20.001	CP 2.02	A





## FRONT (WEST) ELEVATION

LONGREACH REGIONAL COUNCIL

DIGITALLY STAMPED

APPROVED PLAN

**Development Application:** Minor Change to Development Permit DA19/20-006 for Material Change of Use for Low Impact Industry and Transport Depot  
**Lot:** Lot 1651 on SP309934

Referred to in Council's Decision Notice

**Approval Date:** 15 July 2021  
**Application Number:** DA 20/21-011

A 29-06-21 ISSUED FOR COUNCIL APPROVAL  
 REVISIONS

**DRAWING**  
 CONCEPT ELEVATIONS  
 NEW ADMIN BUILDING  
 STAGES 1 and 2

**PROJECT**  
 NEW INFRASTRUCTURE  
 FACILITIES  
 95 EAGLE STREET  
 LONGREACH  
 QUEENSLAND

FOR

OUTBACK AUSSIE TOURS



**GREENWAYARCHITECTS**  
 A: PO Box 648 | Mooloolaba 4557 | QLD | Australia  
 T: +61 (0) 7 5444 6211 | M: +61 (0) 411 286 154 | ABN: 68 067 535 068  
 E: support@greenwayarchitects.com | W: www.greenwayarchitects.com

CONTRACTORS ARE TO VERIFY ALL DIMENSIONS ON THE JOB  
 BEFORE COMMENCING ANY WORK OR MAKING SHOP DRAWINGS

DRAWN	DATE
TW SMITH	9 JUNE 2021

SCALE	CHECKED
1 : 100, @A3	

JOB	SHEET	REVISION
M20.001	CP 2.03	A

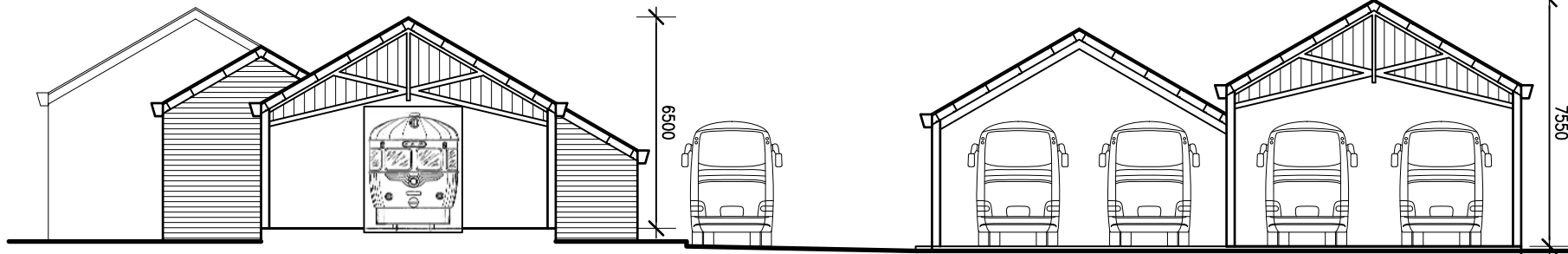
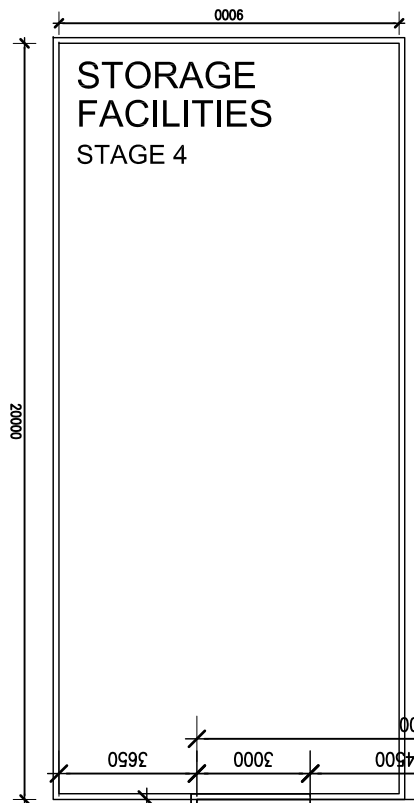
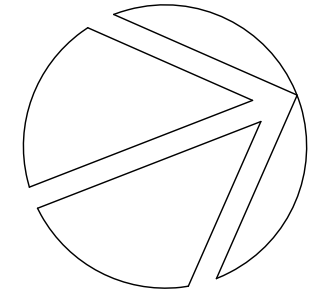

**EAST ELEVATION**

**LONGREACH REGIONAL COUNCIL**  
**DIGITALLY STAMPED**  
**APPROVED PLAN**

**Development Application: Minor Change to Development Permit DA19/20-006 for Material Change of Use for Low Impact Industry and Transport Depot**  
**Lot: Lot 1651 on SP309934**

Referred to in Council's Decision Notice

**Approval Date:** 15 July 2021  
**Application Number:** DA 20/21-011

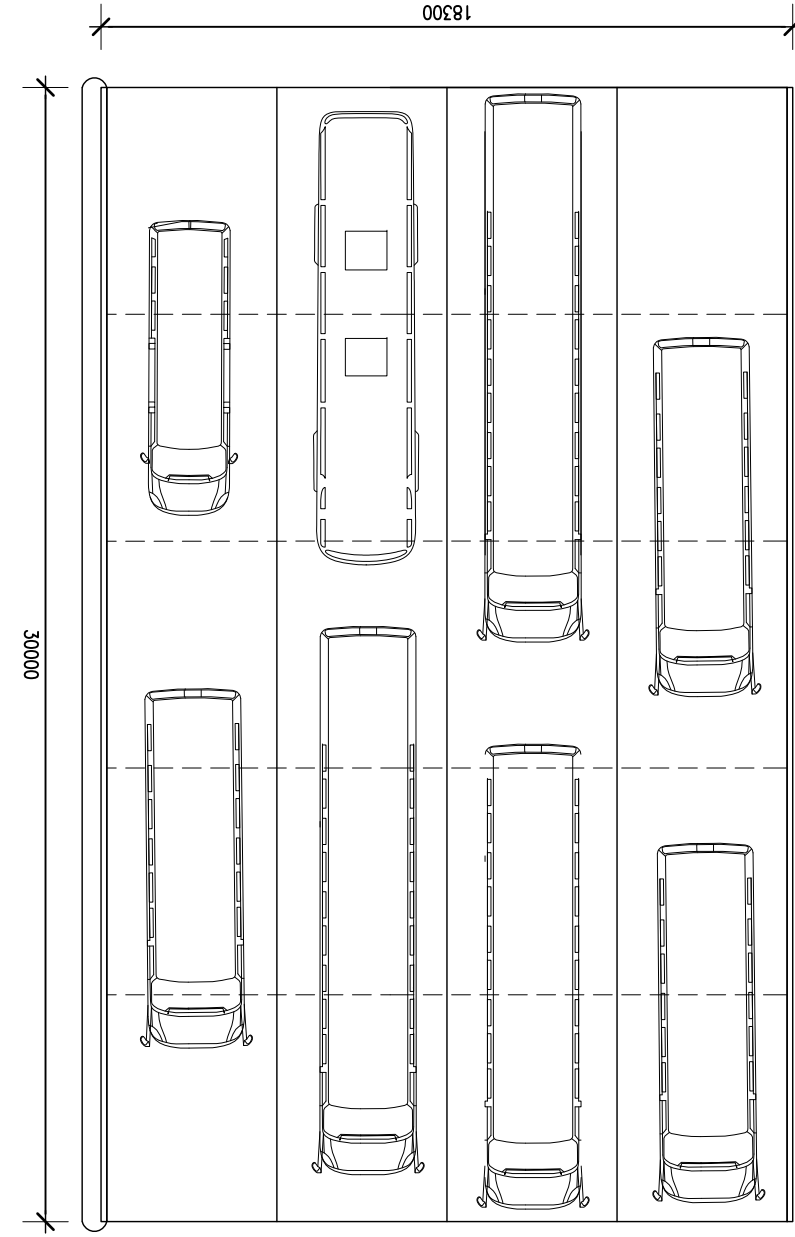
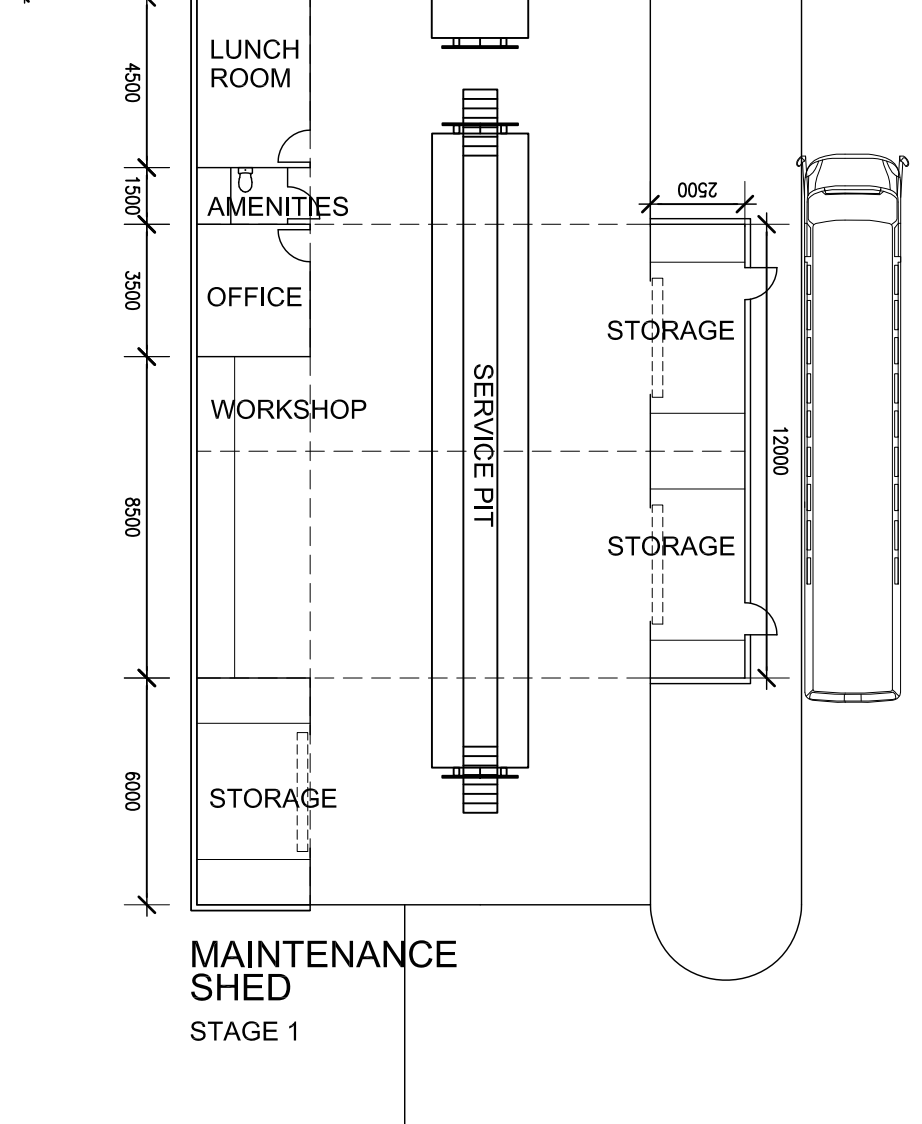

**COVERED BUSPARK**  
**STAGE 3**

A 29-06-21 ISSUED FOR COUNCIL APPROVAL  
 REVISIONS

**DRAWING**  
 CONCEPT DESIGN  
 NEW MAINTENANCE SHED  
 AND BUSPARK

**PROJECT**  
 NEW INFRASTRUCTURE  
 FACILITIES  
 95 EAGLE STREET  
 LONGREACH  
 QUEENSLAND

FOR  
**OUTBACK AUSSIE TOURS**



A: PO Box 648 | Mooloolaba 4557 | QLD | Australia  
 T: +61 (0) 7 5444 6211 | M: +61 (0) 411 286 154 | ABN: 68 067 535 068  
 E: support@greenwayarchitects.com | W: www.greenwayarchitects.com

CONTRACTORS ARE TO VERIFY ALL DIMENSIONS ON THE JOB  
 BEFORE COMMENCING ANY WORK OR MAKING SHOP DRAWINGS

DRAWN	DATE
TW SMITH	9 JUNE 2021

SCALE	CHECKED
1 : 100	

JOB	SHEET	REVISION
M20.001	CP 3.01	A

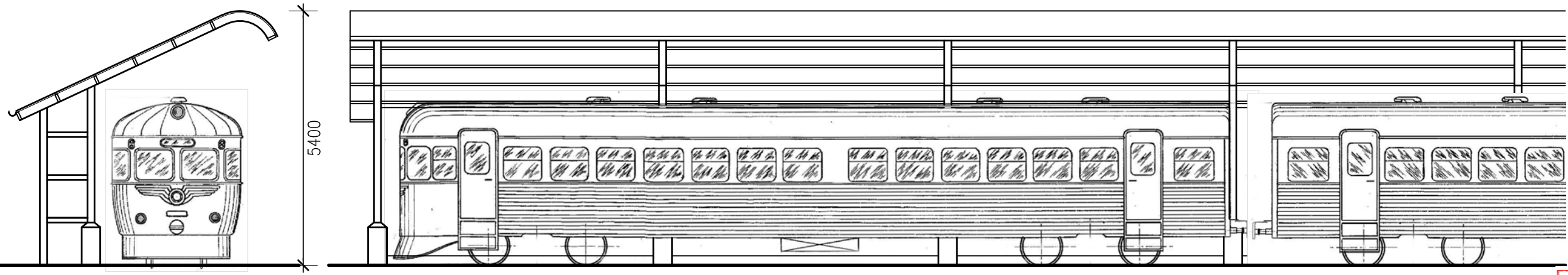
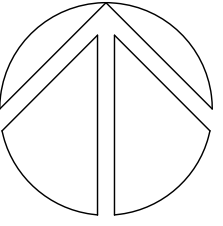

WITH TRAIN ON DISPLAY

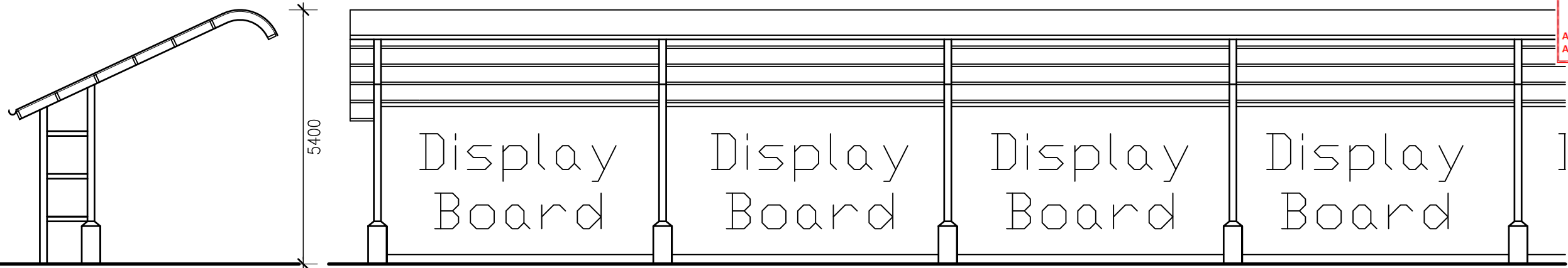

WITHOUT TRAIN ON DISPLAY

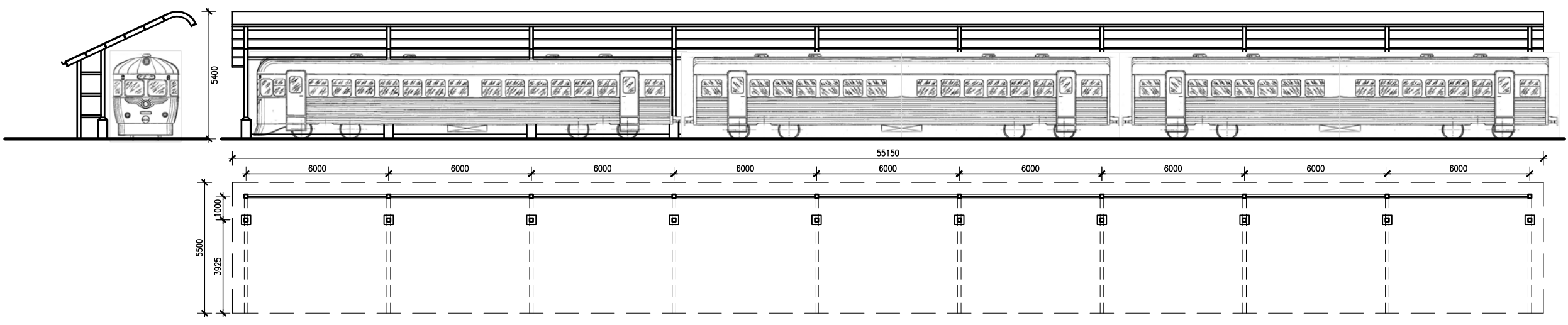

**LONGREACH REGIONAL COUNCIL**

**DIGITALLY STAMPED**  
**APPROVED PLAN**

Development Application: Minor Change to Development Permit DA19/20-006 for Material Change of Use for Low Impact Industry and Transport Depot  
Lot: Lot 1651 on SP309934

Referred to in Council's Decision Notice

Approval Date: 15 July 2021  
Application Number: DA 20/21-011

A 29-06-21 ISSUED FOR COUNCIL APPROVAL

REVISIONS  
DRAWING  
CONCEPT DESIGN  
NEW DISPLAY SHELTER

PROJECT  
NEW INFRASTRUCTURE FACILITIES  
95 EAGLE STREET  
LONGREACH  
QUEENSLAND

FOR  
OUTBACK AUSSIE TOURS



A: PO Box 648 | Mooloolaba 4557 | QLD | Australia  
T: +61 (0) 7 5444 6211 | M: +61 (0) 411 286 154 | ABN: 68 067 535 068  
E: support@greenwayarchitects.com | W: www.greenwayarchitects.com

CONTRACTORS ARE TO VERIFY ALL DIMENSIONS ON THE JOB BEFORE COMMENCING ANY WORK OR MAKING SHOP DRAWINGS

DRAWN	DATE
TW SMITH	9 JUNE 2021

SCALE	CHECKED
1 : 100, 200 @A3	

JOB	SHEET	REVISION
M20.001	CP 4.01	A