



96A Eagle Street  
Longreach QLD 4730

# LONGREACH REGIONAL COUNCIL

## 44 LARK STREET DRIVEWAY & CARPARK

LONGREACH REGIONAL COUNCIL

DIGITALLY STAMPED  
APPROVED PLAN

**Development Application:** Development Permit for Operational Work

**Lot:** Lot 28 on L35712  
Referred to in Council's Decision Notice

**Approval Date:** 19 November 2020

**Application Number:** DA20/21-005

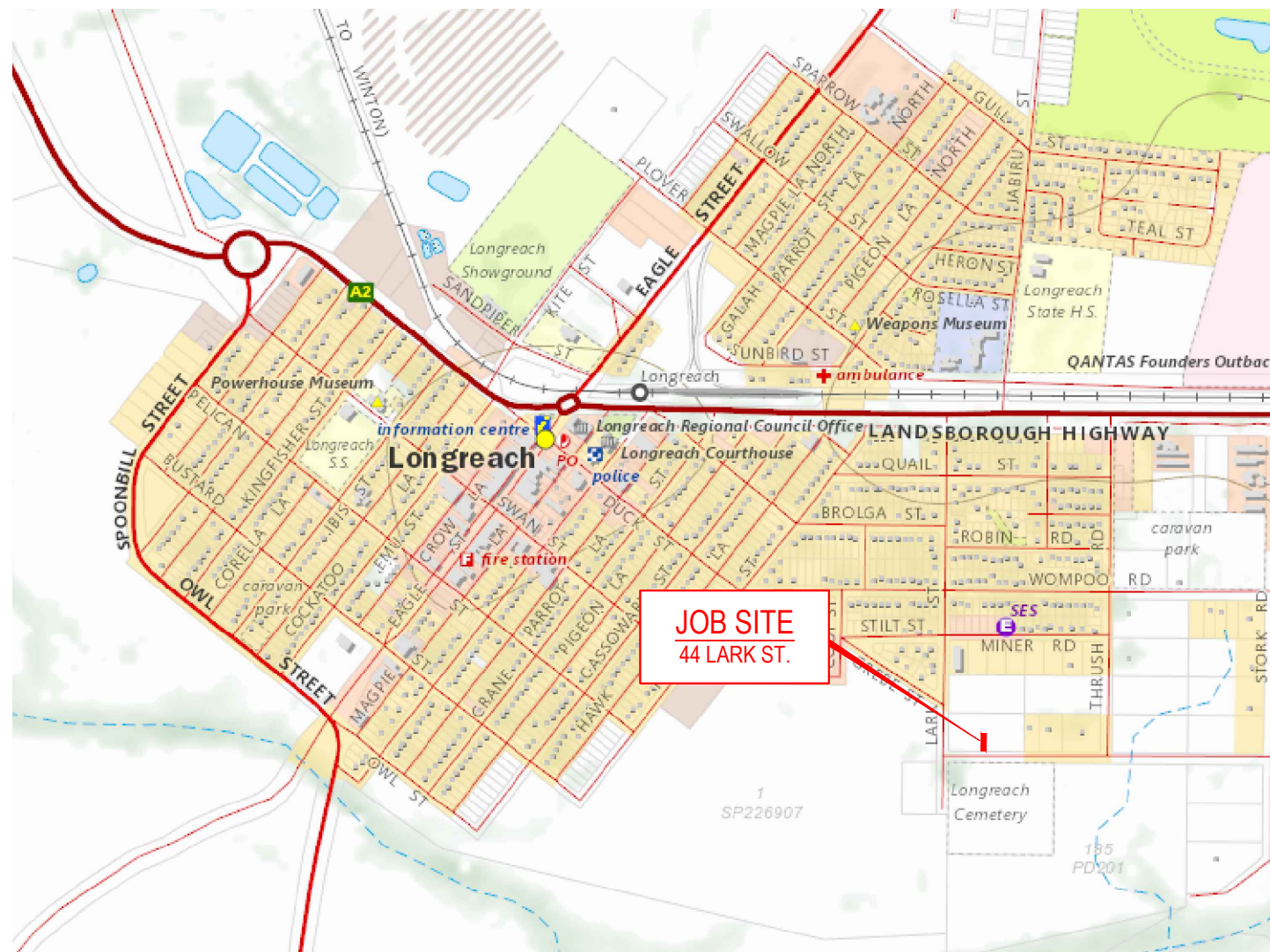

LOCALITY PLAN  
NOT TO SCALE

### DRAWING REGISTER

ISSUE 02

DRAWING No.	REVISION	DATE	DRAWING SHEET DESCRIPTION
200235-1/01	B	28/10/2020	LOCALITY PLAN & DRAWING INDEX
200235-1/02	A	01/10/2020	LAYOUT PLAN & TYPICAL CROSS SECTION
200235-1/03	A	01/10/2020	WORKING PLAN & TABLE SETOUT
200235-1/04	A	01/10/2020	DRIVEWAY SETOUT & CARPARK DETAILS
200235-1/05	B	28/10/2020	EARTHWORKS / STORMWATER MANAGEMENT
200235-1/06	A	01/10/2020	DRIVEWAY CROSS SECTION 1 OF 2
200235-1/07	A	01/10/2020	DRIVEWAY CROSS SECTION 2 OF 2
200235-1/08	A	01/10/2020	VEHICLE PATH

This document set is produced by George Bourne & Associates solely for the benefit of and use by the client in accordance with the terms of the agreement. George Bourne & Associates does not and shall not assume any responsibility or liability whatsoever to any third party arising out of any use or reliance by third parties on the content of this document set. Information contained herein is the intellectual property of George Bourne & Associates and will not be copied without written authorisation from George Bourne & Associates.

Date Printed: 28/10/2020 13:07:11 M-Files ID: 364970

		Drawn: Moises Barrera Designed: Moises Barrera Checked: Jason Ricks Survey: Hoffmann Surveyors		Client: SAUNDERS ELECTRICS Project: PVT LONGREACH - 44 LARK STREET Title: LOCALITY PLAN & DRAWING INDEX	Category: BUILDINGS Drawing No. <b>200235-1/01</b> Units: -      Scale: AS SHOWN Rev. <b>B</b> Size: A3
B DRAWING INDEX UPDATED A ORIGINAL ISSUE Rev. Revision Description	ZR 28/10/2020 MB 01/10/2020 By Date	George Bourne & Associates 73 Elm Street, Barcaladne Q 4725 Ph 07 4651 5177 Unit 4/5 Church Lane, Emerald Q 4720 Ph 07 4982 1826 Email: admin@gbassoc.com.au	J Ricks RPEQ No. 8499		

TBM 01  
SE

44 LARK STREET

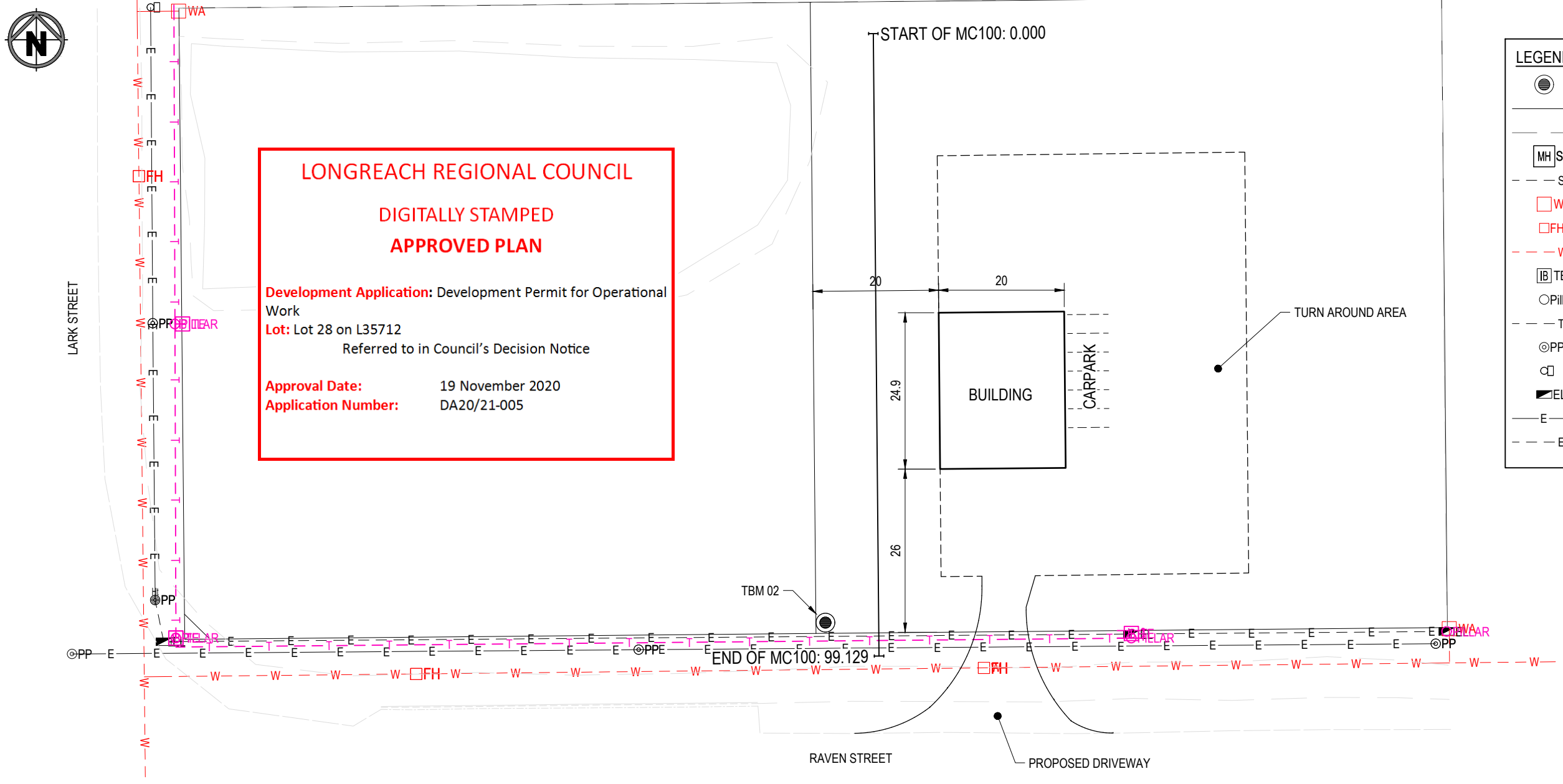

**LEGEND**

- SURVEY MARK
- BOUNDARY
- EXIST. FENCE
- EXIST. SEWER MANHOLE
- EXIST. SEWER MAIN
- EXIST. WATER METER
- EXIST. HYDRANT
- EXISTING WATER MAIN
- EXIST. TELECOM BOX
- EXIST. TELECOM PILLAR
- EXIST. TELECOM U/GROUND
- EXIST. POWER POLE
- EXIST. TRANSFORMER POLE
- EXIT. ELECTRICITY MARKER
- EXIST. ELECTRICITY MAIN
- EXIST. ELECTRICITY U/GROUND

**LONGREACH REGIONAL COUNCIL**  
**DIGITALLY STAMPED**  
**APPROVED PLAN**

**Development Application:** Development Permit for Operational Work  
**Lot:** Lot 28 on L35712  
Referred to in Council's Decision Notice

**Approval Date:** 19 November 2020  
**Application Number:** DA20/21-005



LAYOUT PLAN  
SCALE 1:750

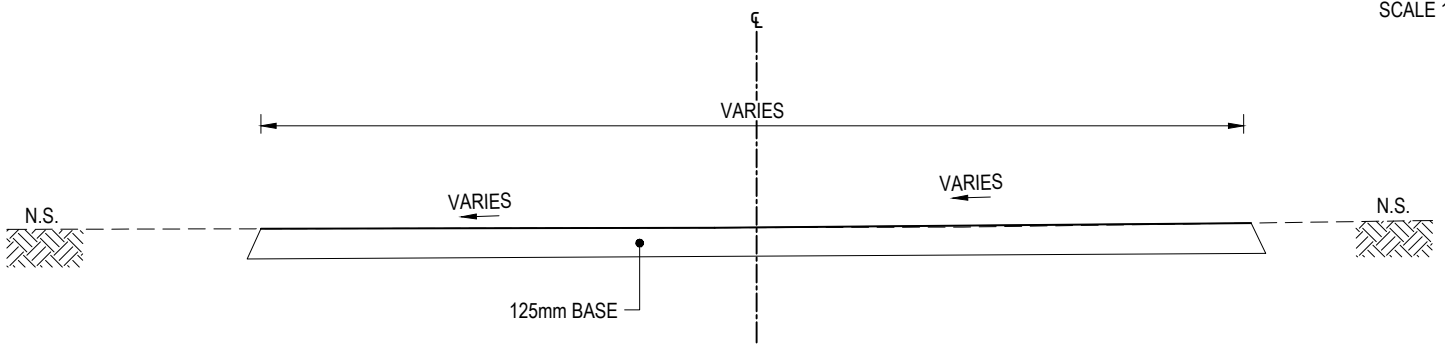

TYPICAL CROSS SECTION  
NOT TO SCALE

SETOUT			
POINT NO.	EASTING	NORTHING	LEVEL
TBM 01	220089.687	7404246.801	185.057
TBM 02	220186.925	7404143.113	184.440

**NOTES**

1. ALL MATERIALS AND WORKS TO COMPLY WITH RELEVANT REGIONAL COUNCIL SPECIFICATIONS.
2. ALL SERVICES ARE TO BE LOCATED PRIOR TO CONSTRUCTION
3. THE CONTRACTORS SHALL ENSURE THAT THE WORKS ARE CARRIED OUT IN ACCORDANCE WITH ALL REQUIREMENTS OF ACTS, REGULATIONS AND LOCAL LAWS.
4. FOR ALIGNMENT SETOUT DETAILS REFER TO DRG 200235-1/02
5. FOR DRIVEWAY SETOUT AND CARPARK DETAIL REFER TO DRG 200235-1/03

**ALL DIMENSIONS ARE TO BE  
CONFIRMED ON SITE PRIOR  
TO COMMENCING ANY WORKS**

**APPROVED  
FOR CONSTRUCTION**

J Ricks  
RPEQ No. 8499

Date Printed: 28/10/2020 13:07:13 M-Files ID: 364970

Rev.	Revision Description	By	Date
A	ORIGINAL ISSUE	MB	01/10/2020

**GBA CONSULTING ENGINEERS**

George Bourne & Associates  
73 Elm Street, Barcaldine Q 4725 Ph 07 4651 5177  
Unit 4/5 Church Lane, Emerald Q 4720 Ph 07 4982 1826  
Email: admin@gbassoc.com.au

Drawn: Moises Barrera  
Designed: Moises Barrera  
Checked: Jason Ricks  
Survey: Hoffmann Surveyors

Date: 28 October 2020

Client: SAUNDERS ELECTRICS		Category: BUILDINGS	
Project: PVT LONGREACH - 44 LARK STREET		Drawing No. 200235-1/02	
Title: LAYOUT PLAN & TYPICAL CROSS SECTION		Rev. A	Size: A3
Units: m (UNO)	Scale: 1:750		

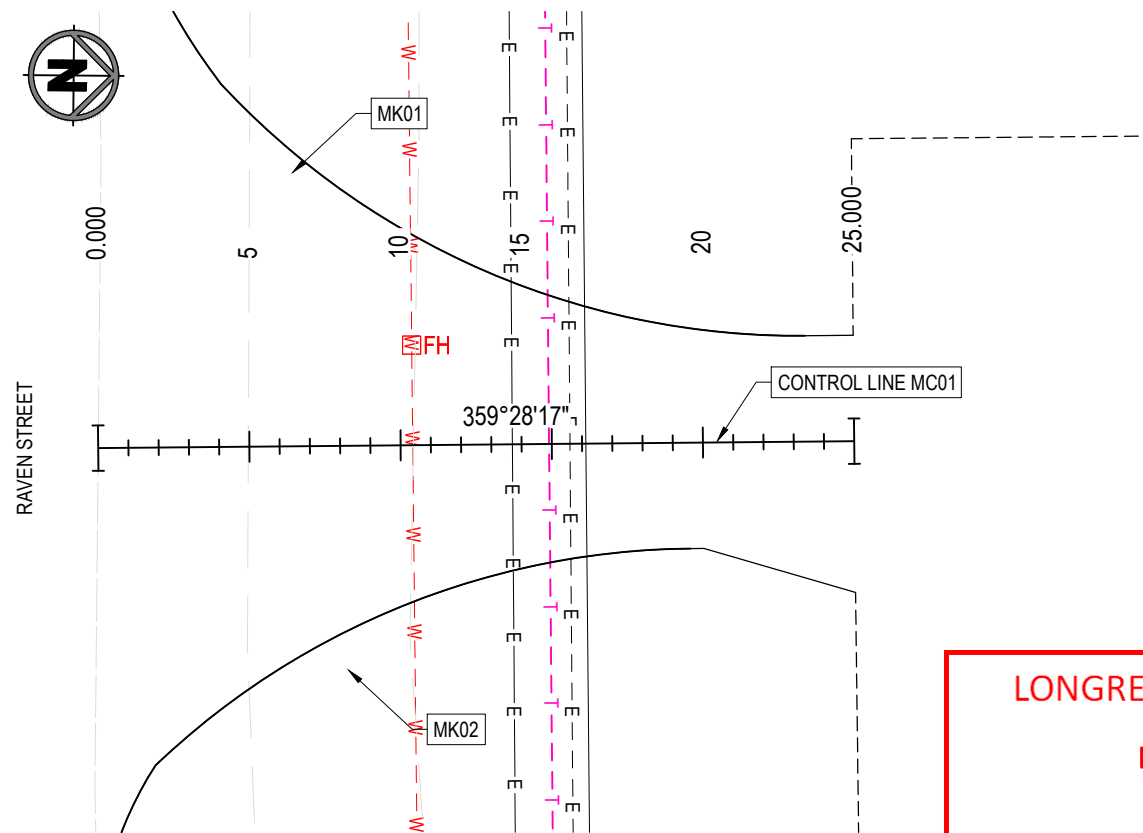

**LEGEND**

- SURVEY MARK
- BOUNDARY
- EXIST. FENCE
- EXIST. SEWER MANHOLE
- EXIST. SEWER MAIN
- EXIST. WATER METER
- EXIST. HYDRANT
- EXISTING WATER MAIN
- EXIST. TELECOM BOX
- EXIST. TELECOM PILLAR
- EXIST. TELECOM U/GROUND
- EXIST. POWER POLE
- EXIST. TRANSFORMER POLE
- EXIT. ELECTRICITY MARKER
- EXIST. ELECTRICITY MAIN
- EXIST. ELECTRICITY U/GROUND

**LONGREACH REGIONAL COUNCIL**

**DIGITALLY STAMPED**

**APPROVED PLAN**

**Development Application:** Development Permit for Operational Work  
**Lot:** Lot 28 on L35712  
 Referred to in Council's Decision Notice

**Approval Date:** 19 November 2020  
**Application Number:** DA20/21-005

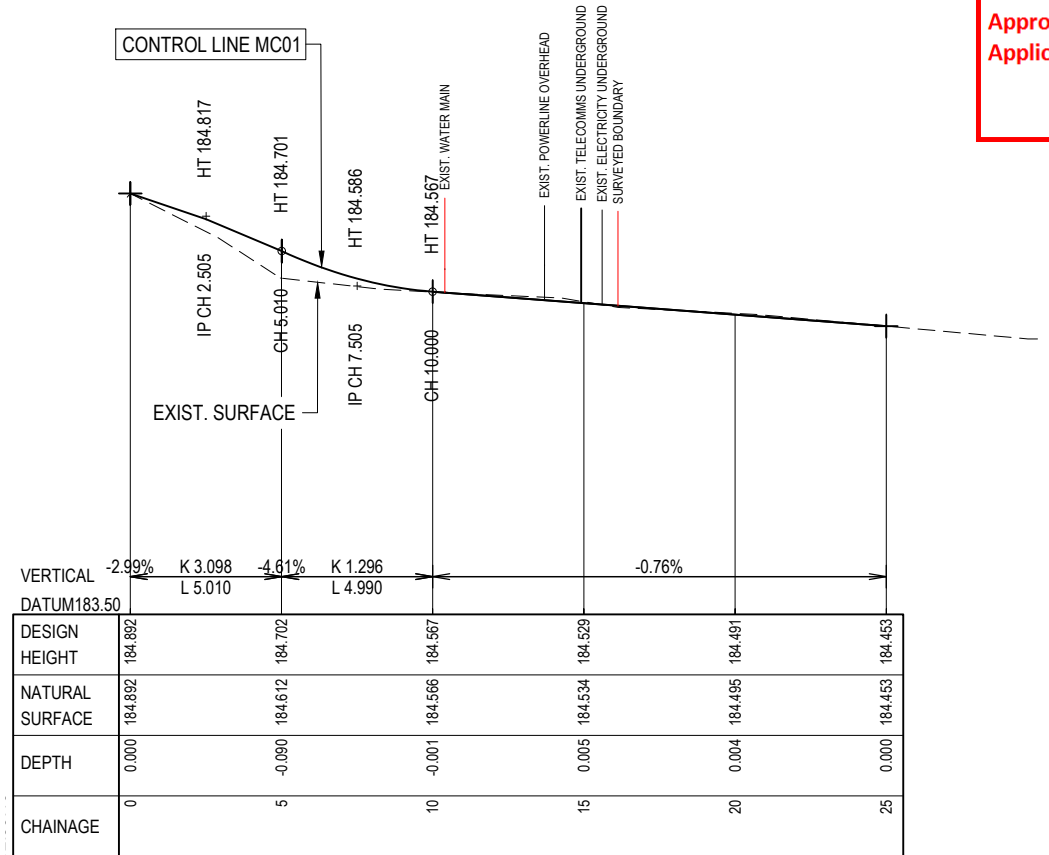

MC01 CONTROL LINE SETOUT							
PT	CHAINAGE	EASTING	NORTHING	HEIGHT	BEARING	DEP.SEG	DEP.LEN
S	0.000	220215.572	7404125.546	184.892	359°28'17.00"	LINE	25.000
E	25.000	220215.342	7404150.544	184.453	359°28'17.00"		

Date Printed: 28/10/2020 13:07:15 M-Files ID: 364970

	Drawn: Moises Barrera	<b>APPROVED FOR CONSTRUCTION</b> J Ricks RPEQ No. 8499	Client: SAUNDERS ELECTRICS		Category: BUILDINGS		
Designed: Moises Barrera	Project: PVT LONGREACH - 44 LARK STREET		Drawing No. 200235-1/03		Rev. A		
Checked: Jason Ricks	Title: WORKING PLAN & SETOUT TABLE		Units: m (UNO)	Scale: H :250 V:25	Size: A3		
Survey: Hoffmann Surveyors	Date: 28 October 2020						
George Bourne & Associates 73 Elm Street, Barcaldine Q 4725 Ph 07 4651 5177 Unit 4/5 Church Lane, Emerald Q 4720 Ph 07 4982 1826 Email: admin@gbassoc.com.au	By: MB	Date: 01/10/2020					
Rev. A	ORIGINAL ISSUE						
Rev.	Revision Description						

**LONGREACH REGIONAL COUNCIL**

**DIGITALLY STAMPED  
APPROVED PLAN**

**Development Application:** Development Permit for Operational Work

**Lot:** Lot 28 on L35712  
Referred to in Council's Decision Notice

**Approval Date:** 19 November 2020

**Application Number:** DA20/21-005

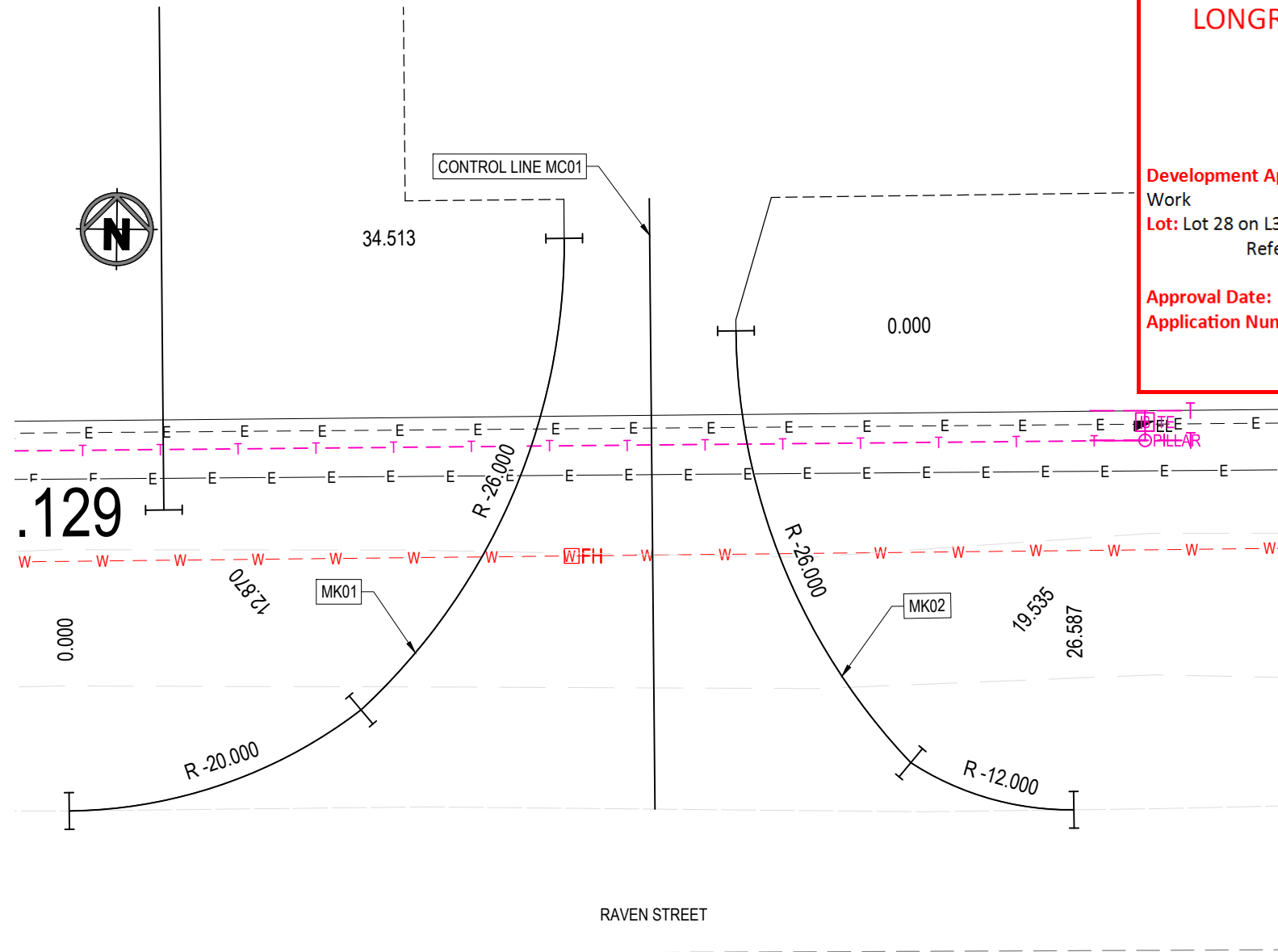

**DRIVEWAY SETOUT**  
SCALE 1:250

MK01 CONTROL LINE SETOUT								
PT	CHAINAGE	EASTING	NORTHING	HEIGHT	BEARING	DEP.SEG	DEP.RAD	DEP.LEN
S	0.000	220191.581	7404125.470	184.916	52°28'11.62"	ARC	-20.000	12.870
DIS	12.870	220203.534	7404129.608	184.683	47°09'59.04"	ARC	-26.000	21.643
E	34.513	220211.856	7404148.914	184.468	359°28'17.00"			

MK02 CONTROL LINE SETOUT								
PT	CHAINAGE	EASTING	NORTHING	HEIGHT	BEARING	DEP.SEG	DEP.RAD	DEP.LEN
S	0.000	220218.892	7404145.128	184.507	136°25'20.31"	ARC	-26.000	19.535
DIS	19.535	220226.055	7404127.445	184.758	122°55'25.01"	ARC	-12.000	7.052
E	26.587	220232.733	7404125.518	184.863	89°15'17.60"			

Date Printed: 28/10/2020 13:07:17 M-Files ID: 364970

		<p>George Bourne &amp; Associates 73 Elm Street, Barcaldine Q 4725 Ph 07 4651 5177 Unit 4/5 Church Lane, Emerald Q 4720 Ph 07 4982 1826 Email: admin@gbassoc.com.au</p>		Drawn: Moises Barrera		<p><b>APPROVED FOR CONSTRUCTION</b></p> <p>J Ricks RPEQ No. 8499</p>		Client: SAUNDERS ELECTRICS		Category: BUILDINGS	
				Designed: Moises Barrera				Project: PVT LONGREACH - 44 LARK STREET		Drawing No. 200235-1/04	
A ORIGINAL ISSUE		MB 01/10/2020		Checked: Jason Ricks		Date: 28 October 2020		Title: DRIVEWAY SETOUT & CARPARK DETAILS		Units: m (UNO) Scale: H:250 V:25 Size: A3	
Rev. Revision Description		By Date		Survey: Hoffmann Surveyors							



CONTROL LINE MC100 SETOUT (STORMWATER MANAGEMENT)							
PT	CHAINAGE	EASTING	NORTHING	HEIGHT	BEARING	DEP.SEG	DEP.LEN
S	0.000	220194.606	7404230.154	184.500	179°28'17.00"	LINE	92.363
E	92.363	220195.458	7404137.795	184.500	179°28'17.00"		

**NOTE:**  
REGRADE LAND PARCEL TO FILL LOCALISED DE

**LONGREACH REGIONAL COUNCIL**

**DIGITALLY STAMPED  
APPROVED PLAN**

**Development Application:** Development Permit for Operational Work

**Lot:** Lot 28 on L35712

Referred to in Council's Decision Notice

**Approval Date:** 19 November 2020

**Application Number:** DA20/21-005

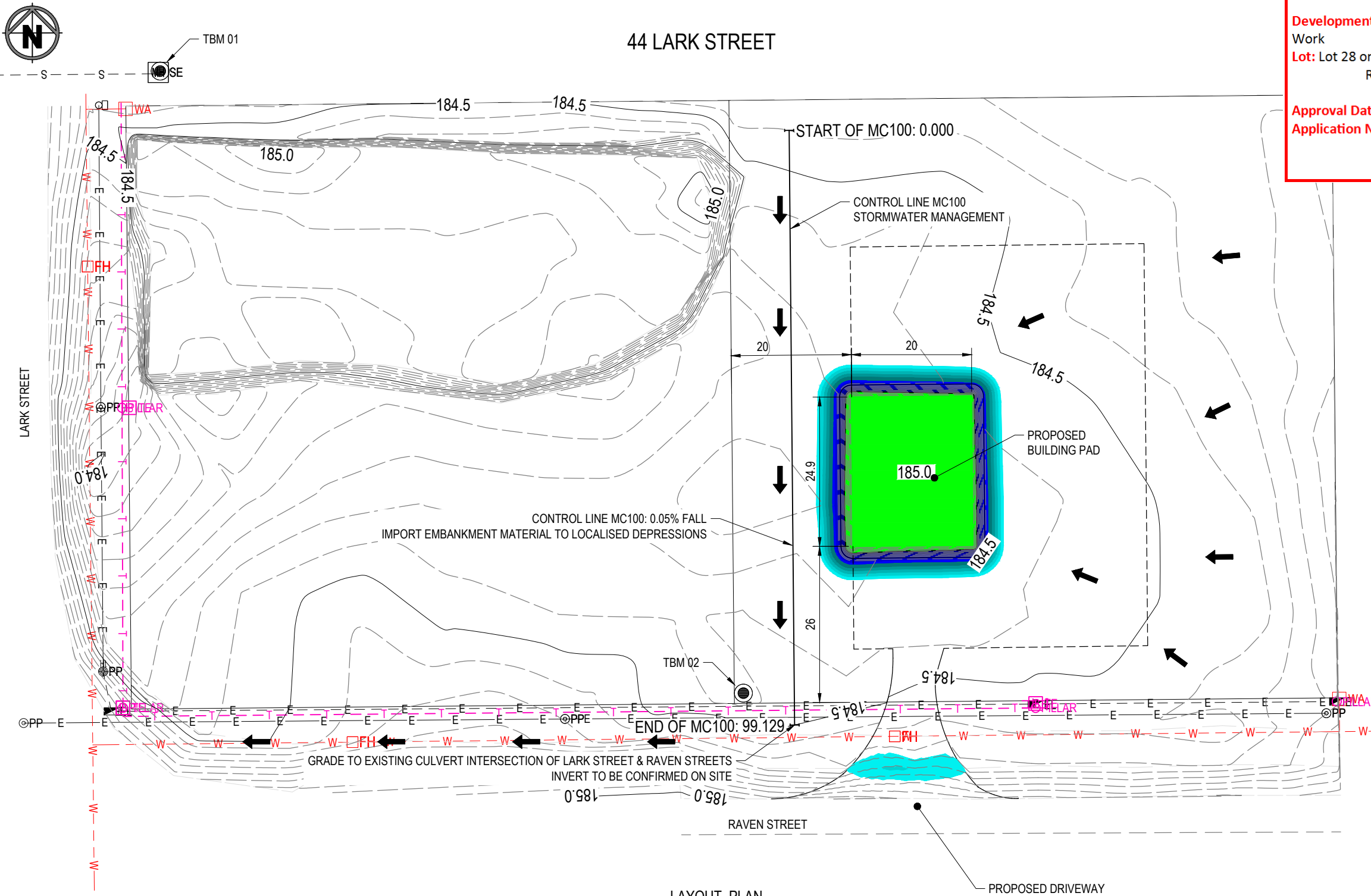

- FH EXIST. HYDRANT
- - - W - EXISTING WATER MAIN
- TE EXIST. TELECOM BOX
- Pillar EXIST. TELECOM PILLAR
- - - T - EXIST. TELECOM U/GROUND
- ⊙ PP EXIST. POWER POLE
- EXIST. TRANSFORMER POLE
- E L EXIT. ELECTRICITY MARKER
- E - EXIST. ELECTRICITY MAIN
- - - E - EXIST. ELECTRICITY U/GROUND

50 MILLIMETER DEPTH RANGE (MILLIMETERS)			
FROM	TO	COLOUR	
-0.501	-100	RGB (255,1,255)	
-0.451	-0.05	RGB (152,0,0)	
-0.401	-0.45	RGB (176,0,0)	
-0.351	-0.4	RGB (200,0,0)	
-0.301	-0.35	RGB (224,0,0)	
-0.251	-0.3	RGB (112,112,0)	
-0.201	-0.25	RGB (138,138,0)	
-0.151	-0.2	RGB (165,165,0)	
-0.101	-0.15	RGB (247,247,0)	
-0.05	-0.1	RGB (0,240,240)	
0.05	0.1	RGB (0,255,255)	
0.101	0.15	RGB (0,210,210)	
0.151	0.2	RGB (0,180,180)	
0.201	0.25	RGB (0,150,150)	
0.251	0.3	RGB (0,120,120)	
0.301	0.35	RGB (0,0,248)	
0.351	0.4	RGB (0,0,210)	
0.401	0.45	RGB (0,0,172)	
0.451	0.5	RGB (0,0,134)	
0.501	100	RGB (5,250,5)	

SETOUT			
POINT NO.	EASTING	NORTHING	LEVEL
TBM 01	220089.687	7404246.801	185.057
TBM 02	220186.925	7404143.113	184.440

Date Printed: 28/10/2020 13:07:18 M-Files ID: 364970

<b>GBA CONSULTING ENGINEERS</b> George Bourne & Associates 73 Elm Street, Barcaldine Q 4725 Ph 07 4651 5177 Unit 4/5 Church Lane, Emerald Q 4720 Ph 07 4982 1826 Email: admin@gbassoc.com.au	Drawn: Moises Barrera Designed: Moises Barrera Checked: Jason Ricks Survey: Hoffmann Surveyors	<b>APPROVED FOR CONSTRUCTION</b> J Ricks RPEQ No. 8499	Client: SAUNDERS ELECTRICS Project: PVT LONGREACH - 44 LARK STREET Title: EARTHWORKS / STORMWATER MANAGEMENT	Category: BUILDINGS Drawing No. <b>200235-1/05</b> Units: m (UNO)   Scale: 1:750   Size: A3
	Revision Description B CONTROL LINE MC100 ADDED A ORIGINAL ISSUE	By: ZR Date: 28/10/2020 MB Date: 01/10/2020	Date: 28 October 2020	Rev. <b>B</b>

LONGREACH REGIONAL COUNCIL

DIGITALLY STAMPED

APPROVED PLAN

Development Application: Development Permit for Operational Work

Lot: Lot 28 on L35712

Referred to in Council's Decision Notice

Approval Date: 19 November 2020

Application Number: DA20/21-005

MC01  
X = 220215.535  
Y = 7404129.545  
Z = 184.745

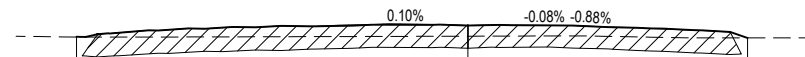

Datum 184.00

Design Height			184.671				184.745			184.663	
Existing Surface		184.674	184.669			184.675	184.745		184.663	184.664	
OFFSETS		-14.944	-12.944			0.000			9.248	11.248	

CHAINAGE 4.000

MC01  
X = 220215.480  
Y = 7404135.545  
Z = 184.568

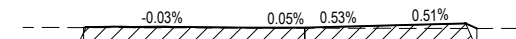

Datum 184.00

Design Height											
Existing Surface		184.570	184.569	184.569		184.568	184.568		184.563	184.563	
OFFSETS		-9.314	-7.314			0.000			5.693	7.693	

CHAINAGE 10.000

MC01  
X = 220215.554  
Y = 7404127.545  
Z = 184.824

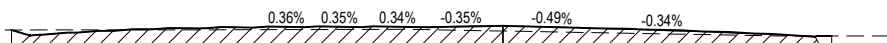

Datum 184.00

Design Height											
Existing Surface		184.797	184.798	184.798		184.791	184.824		184.758	184.758	
OFFSETS		-18.253	-16.253			0.000			10.873	12.873	

CHAINAGE 2.000

MC01  
X = 220215.498  
Y = 7404133.545  
Z = 184.601

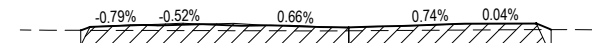

Datum 184.00

Design Height											
Existing Surface		184.584	184.581	184.581		184.578	184.601		184.586	184.586	
OFFSETS		-10.864	-8.864			0.000			6.694	8.694	

CHAINAGE 8.000

MC01  
X = 220215.572  
Y = 7404125.546  
Z = 184.892

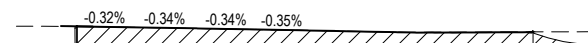

Datum 184.00

Design Height											
Existing Surface		184.892	184.892	184.892		184.892			184.855	184.855	
OFFSETS		-2.000		0.000					15.085	17.085	

CHAINAGE 0.000

MC01  
X = 220215.517  
Y = 7404131.545  
Z = 184.661

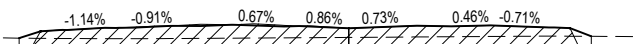

Datum 184.00

Design Height											
Existing Surface		184.600	184.596	184.596		184.600	184.661		184.608	184.608	
OFFSETS		-12.900	-10.900			0.000			8.024	10.024	

CHAINAGE 6.000

Date Printed: 28/10/2020 13:07:20 M-Files ID: 364970

Rev.	A	ORIGINAL ISSUE	MB	01/10/2020
Rev.		Revision Description	By	Date



George Bourne & Associates  
73 Elm Street, Barcaldine Q 4725 Ph 07 4651 5177  
Unit 4/5 Church Lane, Emerald Q 4720 Ph 07 4982 1826  
Email: admin@gbassoc.com.au

Drawn:	Moises Barrera
Designed:	Moises Barrera
Checked:	Jason Ricks
Survey:	Hoffmann Surveyors

**APPROVED FOR CONSTRUCTION**

J Ricks  
RPEQ No. 8499

Date: 28 October 2020

Client:	SAUNDERS ELECTRICS
Project:	PVT LONGREACH - 44 LARK STREET
Title:	DRIVEWAY 1 CROSS SECTIONS 1 OF 2

Category:	BUILDINGS				
Drawing No.	200235-1/06	Rev.	A		
Units:	m (UNO)	Scale:	AS SHOWN	Size:	A3

LONGREACH REGIONAL COUNCIL

DIGITALLY STAMPED  
APPROVED PLAN

Development Application: Development Permit for Operational Work

Lot: Lot 28 on L35712

Referred to in Council's Decision Notice

Approval Date: 19 November 2020

Application Number: DA20/21-005

MC01  
X = 220215.425  
Y = 7404141.545  
Z = 184.521

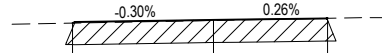

Datum 184.00					
Design Height			184.500	184.521	184.533
Existing Surface	184.492	184.500	184.517	184.531	184.536
OFFSETS	-6.661	-4.661	0.000	3.771	5.771

CHAINAGE 16.000

MC01  
X = 220215.369  
Y = 7404147.545  
Z = 184.476

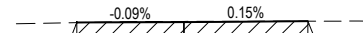

Datum 184.00					
Design Height			184.473	184.476	184.482
Existing Surface	184.464	184.472	184.480	184.482	184.482
OFFSETS	-5.543	-3.543	0.000	4.100	6.100

CHAINAGE 22.000

MC01  
X = 220215.443  
Y = 7404139.545  
Z = 184.537



Datum 184.00					
Design Height			184.530	184.537	184.546
Existing Surface	184.523	184.530	184.547	184.545	184.544
OFFSETS	-7.314	-5.314	0.000	4.143	6.143

CHAINAGE 14.000

MC01  
X = 220215.388  
Y = 7404145.545  
Z = 184.491

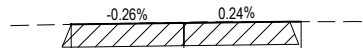

Datum 184.00					
Design Height			184.482	184.491	184.500
Existing Surface	184.474	184.481	184.495	184.500	184.500
OFFSETS	-5.726	-3.726	0.000	3.874	5.874

CHAINAGE 20.000

MC01  
X = 220215.462  
Y = 7404137.545  
Z = 184.552

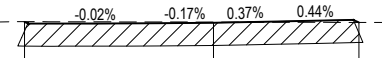

Datum 184.00					
Design Height			184.552	184.554	
Existing Surface	184.552	184.559	184.556	184.554	184.553
OFFSETS	-8.252	-6.252	0.000	4.808	6.808

CHAINAGE 12.000

MC01  
X = 220215.406  
Y = 7404143.545  
Z = 184.506

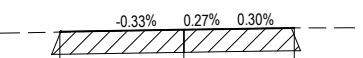

Datum 184.00					
Design Height			184.490	184.506	184.517
Existing Surface	184.483	184.490	184.506	184.518	184.518
OFFSETS	-6.101	-4.101	0.000	3.648	5.648

CHAINAGE 18.000

MC01  
X = 220215.351  
Y = 7404149.545  
Z = 184.461

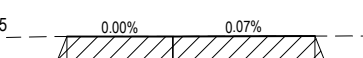

Datum 184.00					
Design Height			184.461	184.461	184.464
Existing Surface	184.454	184.461	184.462	184.464	184.464
OFFSETS	-5.500	-3.500	0.000	4.700	6.700

CHAINAGE 24.000

Date Printed: 28/10/2020 13:07:22 M-Files ID: 364970

Rev.	Revision Description	By	Date
A	ORIGINAL ISSUE	MB	01/10/2020



George Bourne & Associates  
73 Elm Street, Barcaldine Q 4725 Ph 07 4651 5177  
Unit 4/5 Church Lane, Emerald Q 4720 Ph 07 4982 1826  
Email: admin@gbassoc.com.au

Drawn: Moises Barrera  
Designed: Moises Barrera  
Checked: Jason Ricks  
Survey: Hoffmann Surveyors

**APPROVED FOR CONSTRUCTION**  
J Ricks  
RPEQ No. 8499  
Date: 28 October 2020

Client: SAUNDERS ELECTRICS  
Project: PVT LONGREACH - 44 LARK STREET  
Title: DRIVEWAY 1  
CROSS SECTIONS 2 OF 2

Category: BUILDINGS		
Drawing No.	Rev.	
<b>200235-1/07</b>	<b>A</b>	
Units:	Scale:	Size:
m (UNO)	AS SHOWN	A3

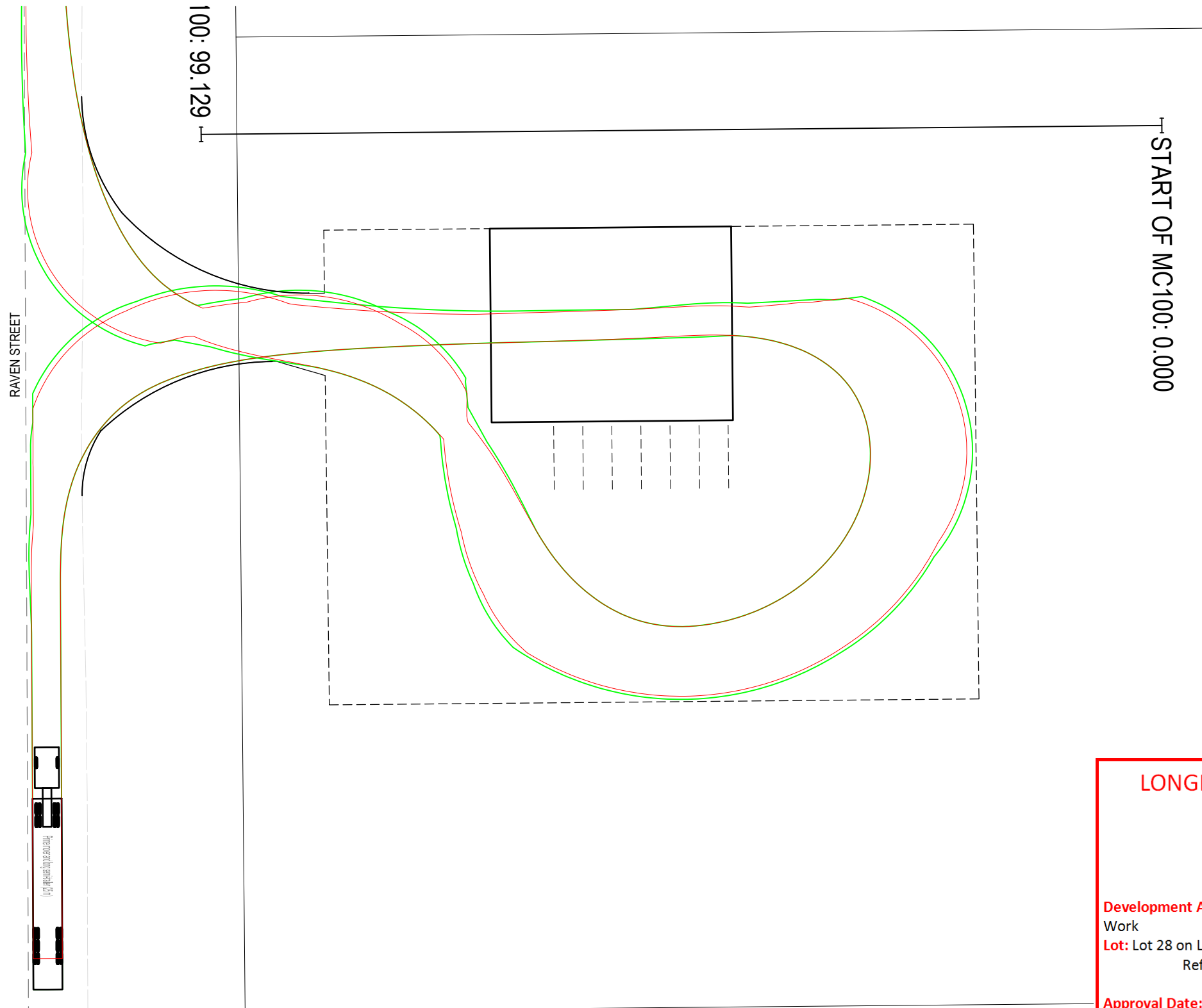

**LONGREACH REGIONAL COUNCIL**  
**DIGITALLY STAMPED**  
**APPROVED PLAN**

**Development Application:** Development Permit for Operational Work  
**Lot:** Lot 28 on L35712  
 Referred to in Council's Decision Notice

**Approval Date:** 19 November 2020  
**Application Number:** DA20/21-005

**PRIME MOVER AND LONG SEMI-TRAILER (25 m)**  
 OVERALL LENGTH 25.000m  
 OVERALL WIDTH 3.000m  
 OVERALL BODY HEIGHT 4.300m  
 MIN BODY GROUND CLEARANCE 0.540m  
 MAX TRACK WIDTH 3.000m  
 LOCK TO LOCK TIME 6.00s  
 KERB TO KERB TURNING RADIUS 15.000m

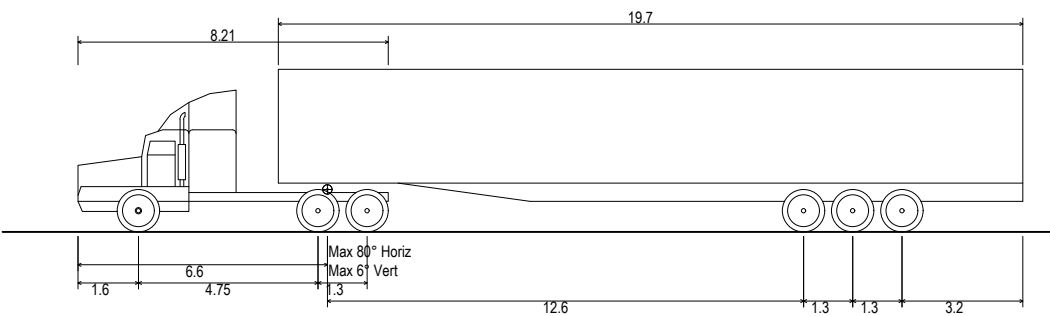

Date Printed: 28/10/2020 13:07:23 M-Files ID: 364970

Rev.	Description	By	Date
A	ORIGINAL ISSUE	MB	01/10/2020

**GBA CONSULTING ENGINEERS**  
 George Bourne & Associates  
 73 Elm Street, Barcaldine Q 4725 Ph 07 4651 5177  
 Unit 4/5 Church Lane, Emerald Q 4720 Ph 07 4982 1826  
 Email: admin@gbassoc.com.au

Drawn: Moises Barrera  
 Designed: Moises Barrera  
 Checked: Jason Ricks  
 Survey: Hoffmann Surveyors

**APPROVED FOR CONSTRUCTION**

J Ricks  
 RPEQ No. 8499

Date: 28 October 2020

Client: SAUNDERS ELECTRICS  
 Project: PVT LONGREACH - 44 LARK STREET  
 Title: VEHICLE PATH

Category: BUILDINGS  
 Drawing No. 200235-1/08  
 Rev. A  
 Units: m (UNO) Scale: AS SHOWN Size: A3