

IMPORTANT NOTE
 DIMENSIONS AND AREAS ARE APPROXIMATE
 ONLY AND ARE SUBJECT TO FINAL SURVEY
 AND LOCAL AUTHORITY APPROVAL.

LONGREACH REGIONAL COUNCIL
 DIGITALLY STAMPED
 APPROVED PLAN

Development Application: Development Permit for Material
 Change of Use for Low Impact Industry and Reconfiguring a Lot
Lot: Lot 28 on L35712

Referred to in Council's Decision Notice

Approval Date: 17 September 2020
Application Number: DA19/20-007

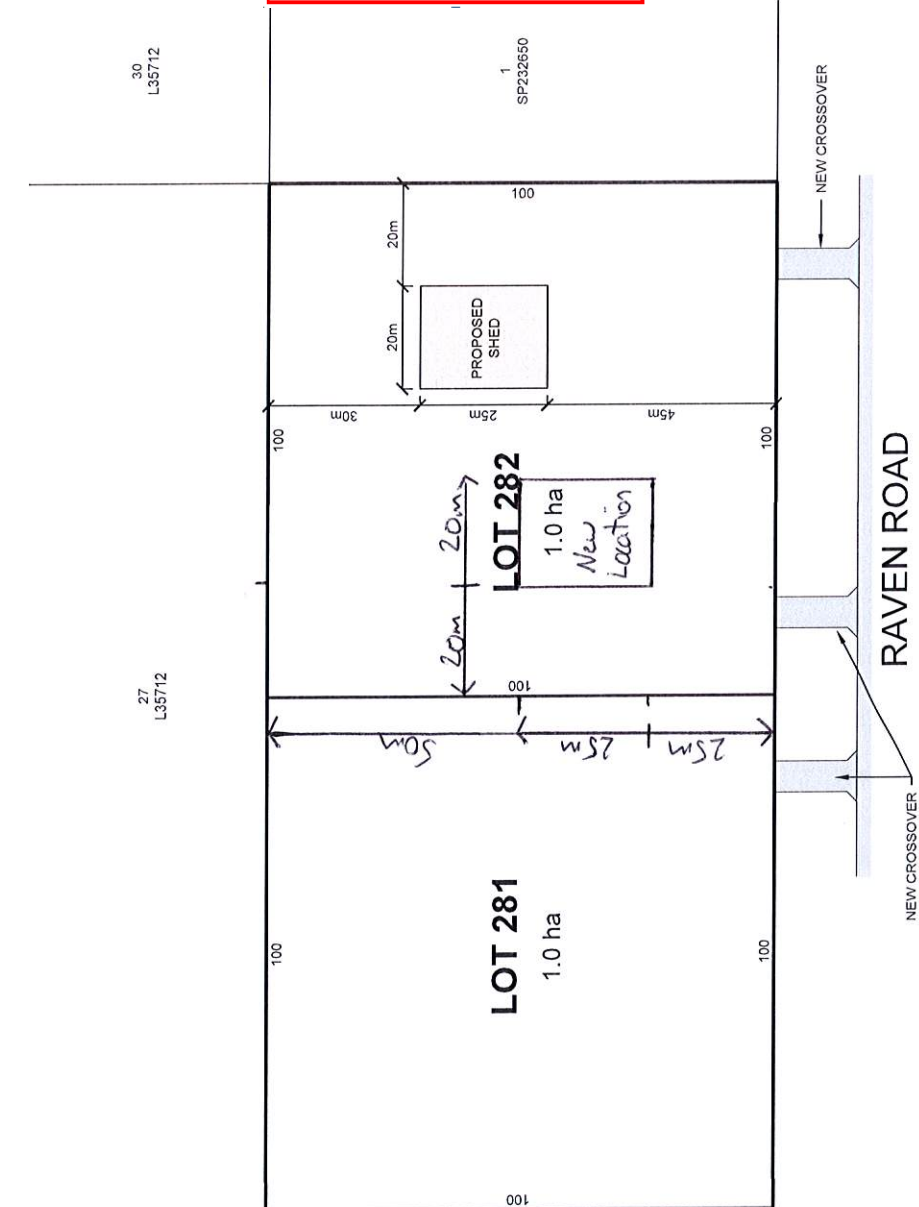

NOTES
 The title boundaries shown hereon were not marked at the time of survey, and
 have been determined by plan dimensions provided by Graham Lloyd Architect
 only and not by field measurement.

PRELIMINARY

Scale 1:1000 - Lengths are in Metres.

PROPOSAL PLAN			
PROJECT: MCJ - SUBDIVISION (1 LOT INTO 2 LOTS)			
LOCATION: 44 LARK STREET, LONGREACH			
Real Property Description: LOT 28 ON L35712			
CLIENT: WALL PLANNING & ENVIRONMENTAL CONSULTING			
Horiz. Datum: MGA ZONE 55 VIDE DCDB			
Vert. Datum: N/A			
Local Authority: LONGREACH REGIONAL			
Rev	Description	AD	DW
0	Preliminary issue for comment	Drawn	Checked
			Date
			5/05/2020
This plan was prepared as a proposed subdivision and should not be used for any other purpose. The dimensions, areas and total number of lots shown hereon are subject to field survey and also to the requirements of Council and any other authority which may have requirements under any relevant legislation. In particular, no reliance should be placed on this plan for any financial dealing involving the land. This note is an integral part of the plan.			
Scale: 1 : 1000 @ A3		Drawing No: 20247-PP-01	
Drawn: AD		Sheet: 1 OF 1	
Surveyor: N/A		Revision: 0	



Airle Beach | Mackay | Townsville | Rockhampton | Brisbane | Gold Coast
 E : admin@visionsurveysqld.com.au P : 13000VISION



MultiBuild 2 - Details - Default - NCC 2019

File View App Quotes Reminders Shed Type BOM Pricing Delivery Options Records Calc Options Help

Customer Details
 Job Details
 Job No: 12721
 Shed Type: None
 Span: 20
 End Bays: 4
 Height: 5
 Length: 24.6
 Side Bays: 6
 Automatic End Bays:

Price: **\$ 75433**

Building For:
 Sam Nisbet
 12731 Ark Street Longreach
 Produced by:
 Longreach Bolted Sheds
 Phone: 07 4982 4057

Placement Location:
 MAIN
 UPPER FLOOR (RHS)

QUOTED DEPOSIT PAID ORDERED DELIVERED BUILT

Admin Actions

MultiBuild 2 - Details - Default - NCC 2019

File View App Quotes Reminders Shed Type BOM Pricing Delivery Options Records Calc Options Help

Customer Details
 Job Details
 Job No: 12721
 Shed Type: None
 Span: 20
 End Bays: 4
 Height: 5
 Length: 24.6
 Side Bays: 6
 Automatic End Bays:

Price: **\$ 0**

Building For:
 Sam Nisbet
 12731 Ark Street Longreach
 Produced by:
 Longreach Bolted Sheds
 Phone: 07 4982 4057

Placement Location:
 MAIN
 UPPER FLOOR (RHS)

QUOTED DEPOSIT PAID ORDERED DELIVERED BUILT

Admin Actions

LONGREACH REGIONAL COUNCIL

DIGITALLY STAMPED

APPROVED PLAN

Development Application: Development Permit for Material Change of Use for Low Impact Industry and Reconfiguring a Lot
Lot: 28 on L35712

Referred to in Council's Decision Notice

Approval Date: 17 September 2020
Application Number: DA19/20-007

Shop 3/23 Hospital Rd, Emerald QLD 4720
 P: 07 4982 4057 E: andy_58@bigpond.net.au

Rest assured we are **SHED SAFE** ACCREDITED

We use **Colorbond** genuine Australian steel provided by **STEEL SUPPLY**

Shop 3/23 Hospital Rd, Emerald QLD 4720
 P: 07 4982 4057 E: andy_58@bigpond.net.au