

PF-1 FOOTING SECTION
SCALE 1:20

GROUND FLOOR PLAN

LEGEND

	DENOTES EXISTING SHED
	DENOTES EXISTING STEEL POST WITH EXISTING FOOTING
	DENOTES PROPOSED STEEL POST, REFER SCHEDULE
	DENOTES PROPOSED FOOTING, REFER SCHEDULE

LONGREACH REGIONAL COUNCIL
DIGITALLY STAMPED
APPROVED PLAN

STEEL POST SCHEDULE

TAG	SIZE
SP-1	SHS 100 x 5

PAD FOOTING SCHEDULE

TAG	SIZE (A x B x D mm)	REINFORCEMENT	f _c '
PF-1	500 x 500 x 900	—	25MPa

Development Application: Development Permit for Building Work for an Extension to a Shed

Address and RP Description: 41 Curlew Street, Longreach (Lot 45 on L35712)

Referred to in Council's Decision Notice

Approval Date: 21 April 2022
Application Number: DA 21/22-016

PROPOSED SHED EXTENSION		REVISION	DESCRIPTION	INITIALS	DATE	REVISION	DESCRIPTION	INITIALS	DATE
GERARD BELL	DRAWN BY:	GS							
	CHECKED BY:	JB							

SHEET TITLE: GROUND FLOOR PLAN	
DATE:	31/01/22
SCALE:	1:100@A3
SHEET No.:	ST-03
REVISION NO.:	0

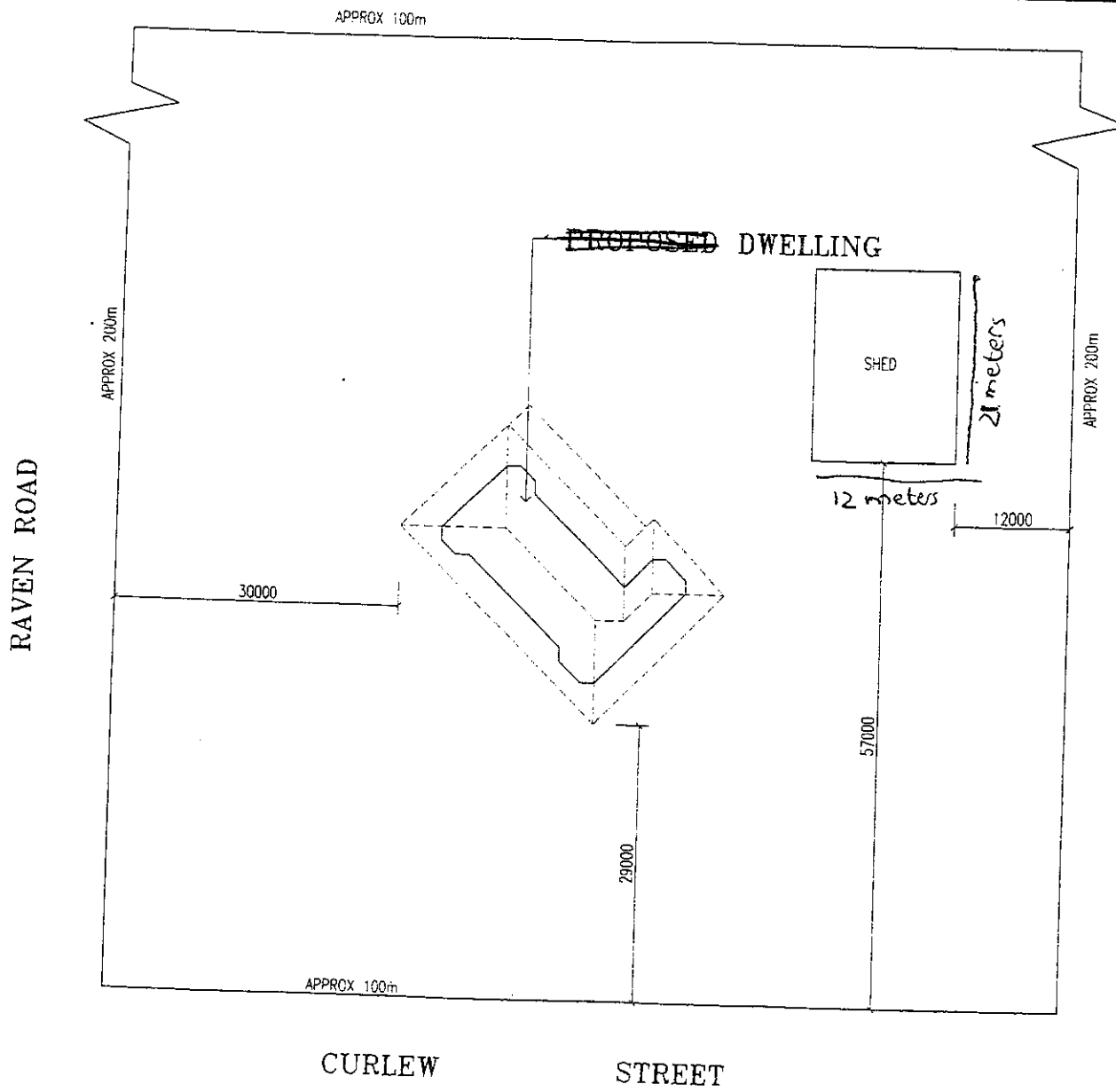

LOT NUMBER: 45
 REGISTERED PLAN NUMBER: L35712
 PARISH: LONGREACH
 COUNTY: PORTLAND

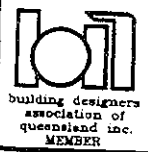

ROCKHAMPTON DRAFTING SERVICES
 David Mills
 Lic No. 61700
 Lic. under
 OBSA Act 1991
 PHONE: (07) 49212410 FAX: (07) 49213679
 2/30 MAIN ST. NORTH ROCKHAMPTON.

DO NOT SCALE
 ALL DIMENSIONS IN
 MILLIMETRES U.N.O.
 This drawing shall not be
 reproduced in any manner
 and shall remain the property
 of Rockhampton Drafting Services

PROPOSED DWELLING
 FOR: - G. & T. BELL
 AT: - CNR CURLEW ST & RAVEN ROAD.

SCALES - 1:500		SIGNED	
DATE - 27/11/00		SIGNED	
DRAWN D.M.	CHECKED D.M.		
SIZE A3	REV	ORIG No.	
SH. 7 of 7		D20069	