

TOURIST DEVELOPMENT 95 EAGLE STREET LONGREACH QLD 4730

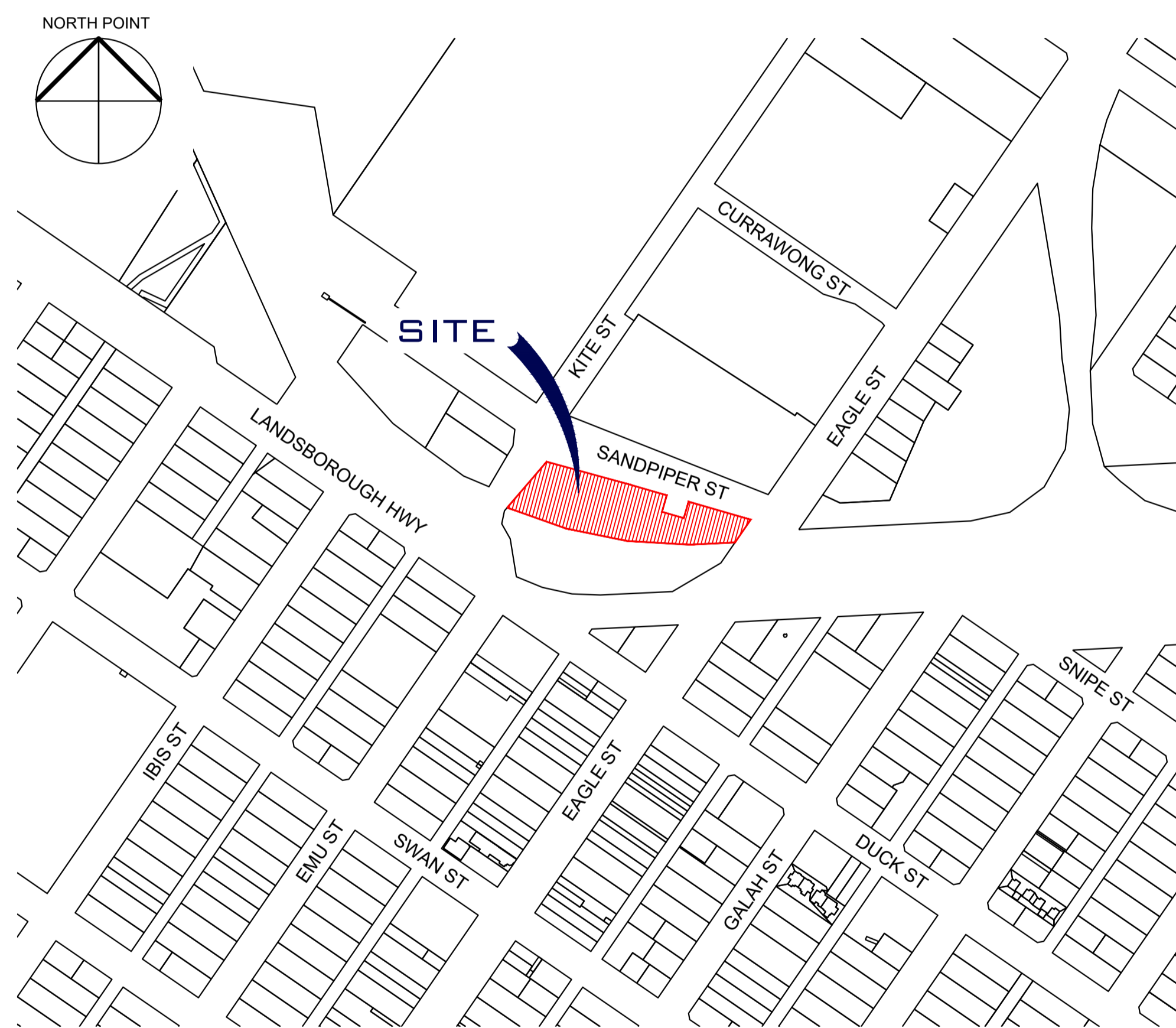

Operational Works Application OUTBACK AUSSIE TOURS



LOCALITY PLAN

DRAWING SCHEDULE

SHEET	TITLE
130-002-001	COVER SHEET
130-002-002	GENERAL NOTES
130-002-100	EXISTING FEATURE PLAN
130-002-101	STAGING LAYOUT PLAN
130-002-200	EARTHWORKS PLAN
130-002-300	STAGE 1 GRADING AND DRAINAGE LAYOUT PLAN
130-002-301	STAGE 1 SITE SECTIONS
130-002-302	STAGE 1 PAVEMENT JOINTING PLAN
130-002-305	STAGE 1 SETOUT PLAN
130-002-310	STAGE 2 LAYOUT PLAN & DETAILS
130-002-311	STAGE 3 LAYOUT PLAN & DETAILS
130-002-312	STAGE 4 LAYOUT PLAN & DETAILS
130-002-313	STAGE 5 LAYOUT PLAN & DETAILS
130-002-314	STAGE 6 LAYOUT PLAN & DETAILS
130-002-317	DETAIL OF RAIL AND ROAD
130-002-360	SWEPT PATH PLAN

DRAWING TO BE READ WITH QR PLAN SET. REFER QUEENSLAND RAIL DRAWING SET QR-C-D92578, QR-C-D92580 AND QR-C-D92581 FOR RAIL SET OUT DETAILS AND LEVELS

LONGREACH REGIONAL COUNCIL

**DIGITALLY STAMPED
APPROVED PLAN**

Development Application: Development Permit for Carrying Out Operational Work (Road Works, Access and Parking Works, Earthworks and Stormwater and Drainage Works)

Lot: Lot 1651 on SP309934

Referred to in Council's Decision Notice

Approval Date: 21 October 2021
Application Number: DA 21/22-007

PROPERTY DESCRIPTION

LOT:
1651
PLAN:
SP309934
LOCAL AUTHORITY:
LONGREACH REGIONAL COUNCIL
LOCAL AUTHORITY APPROVAL NO:
DA20/21-011

PROJECT DESCRIPTION

PROJECT NAME:
95 EAGLE STREET, LONGREACH
PROJECT NO:
130-002
REVISION DATE:
03.08.21

PLAN ISSUE:
FOR APPROVAL

GENERAL

1. CONTRACT SPECIFICATIONS
ALL DRAWINGS ARE TO BE READ IN CONJUNCTION WITH THE CONTRACT SPECIFICATION

2. SETOUT
SURVEY SETOUT INFORMATION HAS BEEN ESTABLISHED ON SITE BY THE PRINCIPAL'S SURVEYOR TO ENABLE THE CONTRACTOR TO ACCURATELY SETOUT THE WORKS TO THE CO-ORDINATES SHOWN. SETOUT INFORMATION SHALL NOT BE OBTAINED BY SCALING FROM THESE DRAWINGS.

3. DATUM
LEVELS SHOWN ARE TO A.H.D.
CONTRACTOR TO CONFIRM ALL LEVELS PRIOR TO THE COMMENCEMENT OF WORK.

4. EXISTING SERVICES
THE LOCATIONS OF ALL EXISTING SERVICES WITHIN THE WORK AREA SHALL BE CONFIRMED BY THE CONTRACTOR PRIOR TO CONSTRUCTION COMMENCING. IT IS THE CONTRACTOR'S RESPONSIBILITY TO CONTACT THE RELEVANT AUTHORITIES AND TO ENSURE THAT THE EXISTING SERVICES ARE NOT DAMAGED OR DISTURBED IN ANY WAY.

5. SPECIFICATIONS
ALL WORK TO CONFORM TO THE RELEVANT LOCAL AUTHORITY'S SPECIFICATIONS

6. MATERIALS
ALL SUITABLE CUT TO FILL MATERIALS GENERATED FROM EXCAVATIONS ASSOCIATED WITH THE PROJECT ARE TO BE COMPACTED TO FUTURE STAGES, OR IF DIRECTED BY THE SUPERINTENDENT REMOVED AND LAWFULLY DISPOSED OFF-SITE.

STORMWATER

1. ALL STORMWATER PIPE TYPES, BEDDING, BACKFILL AND STRUCTURES COMPLETE TO BE IN ACCORDANCE WITH THE LOCAL AUTHORITY'S SPECIFICATIONS AND STANDARD DRAWINGS.

2. ALL PIPES TO BE SOCKETED CONCRETE PIPES WITH RUBBER RING JOINTS. FLUSH JOINTS ARE NOT TO BE USED UNLESS AUTHORISED BY LOCAL AUTHORITY.

3. ALL ALLOTMENTS TO BE GRADED SUCH THAT ROOFWATER DRAINAGE DISCHARGES TO LINED SWALES OR TO THE PIPED DRAINAGE SYSTEM.

4. PVC PIPE AND KERB ADAPTORS TO BE USED WHERE ALLOTMENT DRAINAGE DISCHARGES TO THE KERB AND CHANNEL.

5. ALL PIPES GREATER THAN AND INCLUDING 300mm DIA. SHALL BE CONSTRUCTED USING SRC OR FRC PIPES. CONTRACTOR MAY ELECT TO USE PVC PIPES (RUBBER RING JOINTED OR SOLVENT WELDED JOINTED) WITHIN ALLOTMENTS FOR PIPES SMALLER THAN 300mm DIA.

6. UNLESS NOTED OTHERWISE, INTER-ALLOTMENT DRAINAGE IS TO BE LOCATED 0.5m FROM THE REAR AND SIDE BOUNDARIES OF THE ALLOTMENT SERVED. EASEMENTS 1.5m WIDE ARE TO BE CREATED OVER THE COMPLETED INTER-ALLOTMENT DRAINAGE.

7. LOTS DRAINING VIA OVERLAND FLOW TO THE ROAD RESERVE (WITHOUT FLOWING THROUGH ADJOINING PROPERTIES) ARE TO PROVIDE FOR Q100 OVERLAND FLOW.

8. ALL PIPES UNDER TRAFFICABLE AREAS TO BE CLASS '2' RCP MINIMUM, UNLESS NOTED OTHERWISE.

9. PIPES HAVE BEEN DESIGNED FOR SERVICE LOADS ONLY. THE PRINCIPAL CONTRACTOR SHALL ASSESS THE ALL CONSTRUCTION LOADS AND UPGRADE (AT THEIR OWN COST) IF NECESSARY. THE INCLUDED 'MINIMUM COMPACTION COVER TO PIPES' TABLE TO BE USED AS A GUIDE ONLY.

LINEMARKING

1. LINEMARKING AND SIGNAGE IS TO BE CONSTRUCTED IN ACCORDANCE WITH THE LATEST EDITION OF THE "MANUAL OF UNIFORM TRAFFIC CONTROL DEVICES".

2. EXTENT OF LINEMARKING IS TO BE VERIFIED ON SITE WITH THE SUPERINTENDENT PRIOR TO INSTALLATION.

3. EXACT LOCATION OF ALL SIGNS IS TO BE VERIFIED ON SITE WITH THE SUPERINTENDENT PRIOR TO INSTALLATION.

4. ALL SIGN POSTS & SIGN RAILS TO BE GALVANISED UNLESS OTHERWISE DIRECTED BY THE SUPERINTENDENT.

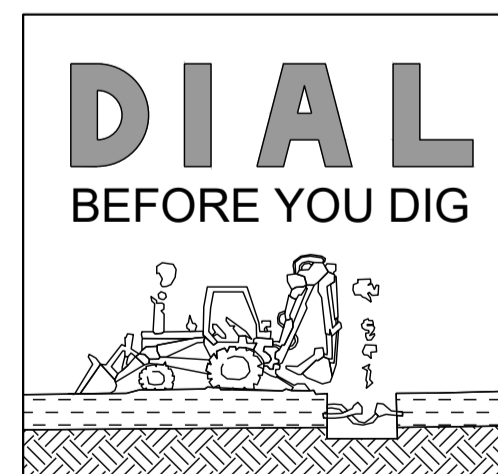

SERVICE LOCATIONS

IT IS THE RESPONSIBILITY OF THE PRINCIPAL CONTRACTOR TO CONTACT ALL RELEVANT SERVICE AUTHORITIES TO VERIFY THE LOCATION OF ALL EXISTING SERVICES PRIOR TO THE START OF CONSTRUCTION

ENERGY SERVICE PROVIDERS

NOTE: SERVICE LOCATIONS ARE APPROXIMATE ONLY FROM PROVIDERS PLANS. LOCATIONS ARE TO BE CONFIRMED PRIOR TO START OF CONSTRUCTION. PHONE DBYD SERVICE LOCATIONS ON 1100 FOR DETAILS.

TELECOMMUNICATIONS SERVICE PROVIDERS

NOTE: SERVICE LOCATIONS ARE APPROXIMATE ONLY FROM PROVIDERS PLANS. LOCATIONS ARE TO BE CONFIRMED PRIOR TO START OF CONSTRUCTION. PHONE DBYD SERVICE LOCATIONS ON 1100 FOR DETAILS.

WARNING: OPTIC FIBRE
EXTREME CARE TO BE TAKEN WHILE EXCAVATING IN THE VICINITY OF OPTIC FIBRE CABLES. LOCATIONS ARE TO BE CONFIRMED PRIOR TO START OF CONSTRUCTION.

Manual of Uniform Traffic Control Devices

NOTE: ALL SIGNS & LINE MARKING TO BE IN ACCORDANCE WITH THE MANUAL OF UNIFORM TRAFFIC CONTROL DEVICES.

EARTHWORKS/ROADWORKS

1. DEMOLITION
THE CONTRACTOR SHALL NOTIFY THE SUPERINTENDENT PRIOR TO THE REMOVAL OR DEMOLITION OF ANY EXISTING STRUCTURES WITH THE SITE CONFINES.

2. TOPSOIL STRIPPING
TOPSOIL (ALL ORGANIC MATERIAL) TO BE STRIPPED ACROSS THE LIMIT OF THE EARTHWORKS CUT AND FILL AREAS AND STOCKPILED IN A LOCATION APPROVED BY THE SUPERINTENDENT. THE EXISTING STRATA IS TO BE TREATED IN ACCORDANCE WITH THE SPECIFICATION PRIOR TO PLACING ANY FILL.

3. EARTHWORKS LEVELS
SURFACE LEVELS HAVE BEEN DERIVED FROM THE COMPUTER MODELLING OF FIELD SURVEY DATA. EARTHWORKS LEVELS SHOWN ON DRAWINGS ARE FINISHED SURFACE LEVELS AND INCLUDE 100mm OF TOPSOIL.

4. COMPACTION STANDARD
SITE FILLING AND TRENCH BACKFILL SHALL BE COMPACTED AND TESTED TO THE STANDARDS DESCRIBED IN AS3798-2007.

5. PAVEMENT DEPTHS
THE DESIGN PAVEMENT DEPTHS ARE BASED ON THE DEPTHS SHOWN IN THE SCHEDULE. THESE DEPTHS HAVE BEEN INCLUDED AS PART OF THE EARTHWORKS CALCULATIONS. SUBGRADE TESTS ARE TO BE UNDERTAKEN AND FORWARDED TO THE SUPERINTENDENT FOR EVALUATION OF ULTIMATE PAVEMENT DEPTHS. TESTING TO INCLUDE SOAKED CBR AND ANY OTHER ASSESSMENTS DETERMINED NECESSARY BY THE SUPERINTENDENT.

6. TESTING
ALL COMPACTION TESTING TO BE CARRIED OUT BY AN APPROVED N.A.T.A. TESTING AUTHORITY AND ARRANGED BY THE PRINCIPAL CONTRACTOR. ALL SITE FILLING TO BE TESTED AND CERTIFIED AS GEOTECHNICAL LEVEL 1, UNLESS NOTED OTHERWISE.

7. TOPSOIL REPLACEMENT
ALL FOOTPATHS, BATTERS AND ALLOTMENT CUT & FILL AREAS SHALL BE TOPSOILED (LIGHTLY COMPACTED) TO A MINIMUM DEPTH OF 100mm THICK USING TOPSOIL FROM ONSITE STOCKPILES. IF DIRECTED BY THE SUPERINTENDENT THE TOPSOIL SHALL BE A SCREENED PRIOR TO PLACING.

8. GRASSING
ALL CUT/FILL AND DISTURBED AREAS SHALL BE GRASSED (OR TURFED) TO THE SATISFACTION OF THE SUPERINTENDENT.

9. SUBSOIL DRAINS
SUBSOIL DRAINS ARE TO BE CONSTRUCTED UNDER ALL KERB STRUCTURES IN ACCORDANCE WITH THE LOCAL AUTHORITY GUIDELINES.

10. EARTHWORKS ZONE
THE FOLLOWING ACTIVITIES ARE PROHIBITED OUTSIDE THE EARTHWORKS ZONE:

- STORAGE AND MIXING OF MATERIALS AND LIQUID DISPOSAL
- VEHICLE PARKING
- MACHINERY REPAIRS/REFUELLING
- PLACEMENT OF SITE OFFICES OR SHEDS
- STOCKPILING OF SOIL, RUBBLE OR DEBRIS
- ANY FILLING OR EXCAVATION INCLUDING TRENCHES, TOPSOIL, SKIMMING AND OR SURFACE EXCAVATION (UNLESS APPROVED OTHERWISE)

11. STOCKPILES
ALL SUITABLE FILL CREATED FROM THE WORKS SHALL BE COMPACTED TO FUTURE FILL AREAS AS NOMINATED. NO STOCKPILES OF SURPLUS MATERIAL ARE TO BE CREATED UNLESS DIRECTED BY THE SUPERINTENDENT.

12. FOOTPATHS
ALL CONCRETE FOOTPATHS TO BE INSTALLED BY THE CIVIL CONTRACTOR UNLESS NOTED OTHERWISE. FOOTPATHS TO BE CONSTRUCTED IN ACCORDANCE WITH THE LOCAL AUTHORITY SPECIFICATIONS.

13. SERVICES
SERVICE ALLOCATIONS, COVER DETAILS AND PAVEMENT MARKINGS IN ACCORDANCE WITH THE RELEVANT AUTHORITY STANDARDS. CONDUITS UNDER HARDSTAND AREAS (DRIVEWAYS AND FOOTPATHS) TO BE PROVIDED AS DIRECTED.

SEDIMENT AND EROSION

1. THE EROSION AND SEDIMENT CONTROL DESIGN IS TO BE USED AS A GUIDE ONLY. THE PRINCIPAL CONTRACTOR SHALL INSTALL AND MAINTAIN ANY ADDITIONAL OR ALTERNATIVE MEASURES IN ORDER TO COMPLY WITH STATUTORY REQUIREMENTS.

2. THE CONTRACTOR IS TO TAKE ALL NECESSARY PRECAUTIONS TO CONTROL EROSION AND DOWNSTREAM SEDIMENT DURING THE WORKS AND MAINTENANCE PERIOD. ALL DEVICES ARE TO BE IMPLEMENTED USING BEST PRACTICES IN ORDER TO MINIMISE THE QUANTITY OF SEDIMENT LEAVING THE SITE.

3. WHERE SLASHING OF EXISTING VEGETATION IS REQUIRED, THE VEGETATION SHALL BE SLASHED TO A MINIMUM HEIGHT OF 75mm TO ASSIST WITH EROSION PREVENTION.

4. ANY DISTURBED AREAS WHERE WORKS ARE COMPLETED ARE TO BE TOPSOILED AND GRASS SEEDED/HYDROMULCHED WITHIN FIVE DAYS (OR EARLIER IF RAIN IS EXPECTED).

5. ALL CONSTRUCTION VEHICLES ARE TO ACCESS THE SITE VIA AN AGREED SINGLE POINT OF ACCESS IN ORDER TO LIMIT THE TRACKING OF DELETERIOUS MATERIALS ONTO THE SURROUNDING ROAD NETWORK.

6. PROVIDE GULLY INLET PROTECTION TO ALL GULLY INLET STRUCTURES LOCATED, DIRECTLY DOWNSTREAM OF THE PROPOSED DEVELOPMENT WORKS.

7. RESTRICTION OF GENERAL PUBLIC ACCESS TO THE SITE BY IS TO BE PROVIDED AT THE INTERFACE BETWEEN THE EXISTING SURROUNDS AND THE NEW CONSTRUCTION. THE PROVISIONS SHALL ADDRESS ALL WORKPLACE HEALTH AND SAFETY CONCERNS.

8. THE LOCATION OF THE CONSTRUCTION VEHICLE COMPOUND, SITE OFFICE AND THE VEHICLE SERVICING AREA ARE TO BE AGREED AND INSTALLED PRIOR TO THE COMMENCEMENT OF WORKS.

9. NO CLEARED VEGETATION IS TO BE BURNED ON SITE. ALL NATIVE VEGETATION WASTE IS TO BE MULCHED AND RETAINED ON SITE FOR USE AS PART OF THE LANDSCAPING OR REVEGETATION WORKS. ALL ORGANIC MATTER NOT SUITABLE FOR MULCHING SHALL BE LAWFULLY DISPOSED OFF SITE.

10. ANY ADDITIONAL CONTROL MEASURES AS DIRECTED BY THE SUPERINTENDENT (OR DESIGNATED AUTHORITY) DURING THE CONSTRUCTION OR MAINTENANCE PERIOD ARE TO BE IMPLEMENTED AT THE EARLIEST TIME POSSIBLE AND WITHIN 24 HOURS OF THE TIME OF THE REQUEST.

11. ANY CAPTURED RUNOFF IS TO BE TREATED AND TESTED. THE TREATED RUNOFF IS TO ACHIEVE COMPLIANCE WITH THE WATER QUALITY GUIDELINES AND THE SATISFACTION OF THE SUPERINTENDENT PRIOR TO RELEASE.

12. AREAS USED FOR STORAGE OF CHEMICALS USED FOR CONSTRUCTION PURPOSES SHALL HAVE SUITABLE CONTROL DEVICES INSTALLED. UPON COMPLETION OF WORKS, THE WASTE PRODUCTS ARE TO BE DISPOSED OF IN ACCORDANCE WITH THE STATUTORY REQUIREMENTS AND THE AREA REHABILITATED.

LONGREACH REGIONAL COUNCIL

DIGITALLY STAMPED
APPROVED PLAN

Development Application: Development Permit for Carrying Out Operational Work (Road Works, Access and Parking Works, Earthworks and Stormwater and Drainage Works)

Lot: Lot 1651 on SP309934

Referred to in Council's Decision Notice

Approval Date: 21 October 2021
Application Number: DA 21/22-007

SCALE:		SURVEYED:		CLIENT:		NORTH POINT		TITLE:	
PROJECT NO: 130-002		DATE 01/08/21		BJNORTH SURVEY		OUTBACK AUSSIE TOURS		GENERAL NOTES	
CHECKED GWA		APPROVED:		DATUM: AHD		PROJECT:		PLAN No	
LOCAL AUTHORITY APPROVAL NO:		DRAWN TG				95 EAGLE STREET, LONGREACH		130-002-002	
DESIGNED TG		FOR AND ON BEHALF OF BAX ENGINEERING PTY. LTD.				REVISION		A A1	
No.		DATE		REVISIONS		BY		CKD	

LONGREACH REGIONAL COUNCIL
DIGITALLY STAMPED
APPROVED PLAN

Development Application: Development Permit for Carrying Out Operational Work (Road Works, Access and Parking Works, Earthworks and Stormwater and Drainage Works)

Lot: Lot 1651 on SP309934

Referred to in Council's Decision Notice

Approval Date: 21 October 2021
Application Number: DA 21/22-007

- LEGEND:**
- ADJACENT BOUNDARY
 - SITE BOUNDARY
 - EXISTING CONTOUR (0.1m INTERVAL)
 - EXISTING EASEMENT
 - EXISTING KERB & CHANNEL
 - EXISTING FENCE
 - EXISTING OVERHEAD ELECTRICITY
 - EXISTING WATER
 - EXISTING TELEPHONE
 - PROPOSED CLOSED ROAD

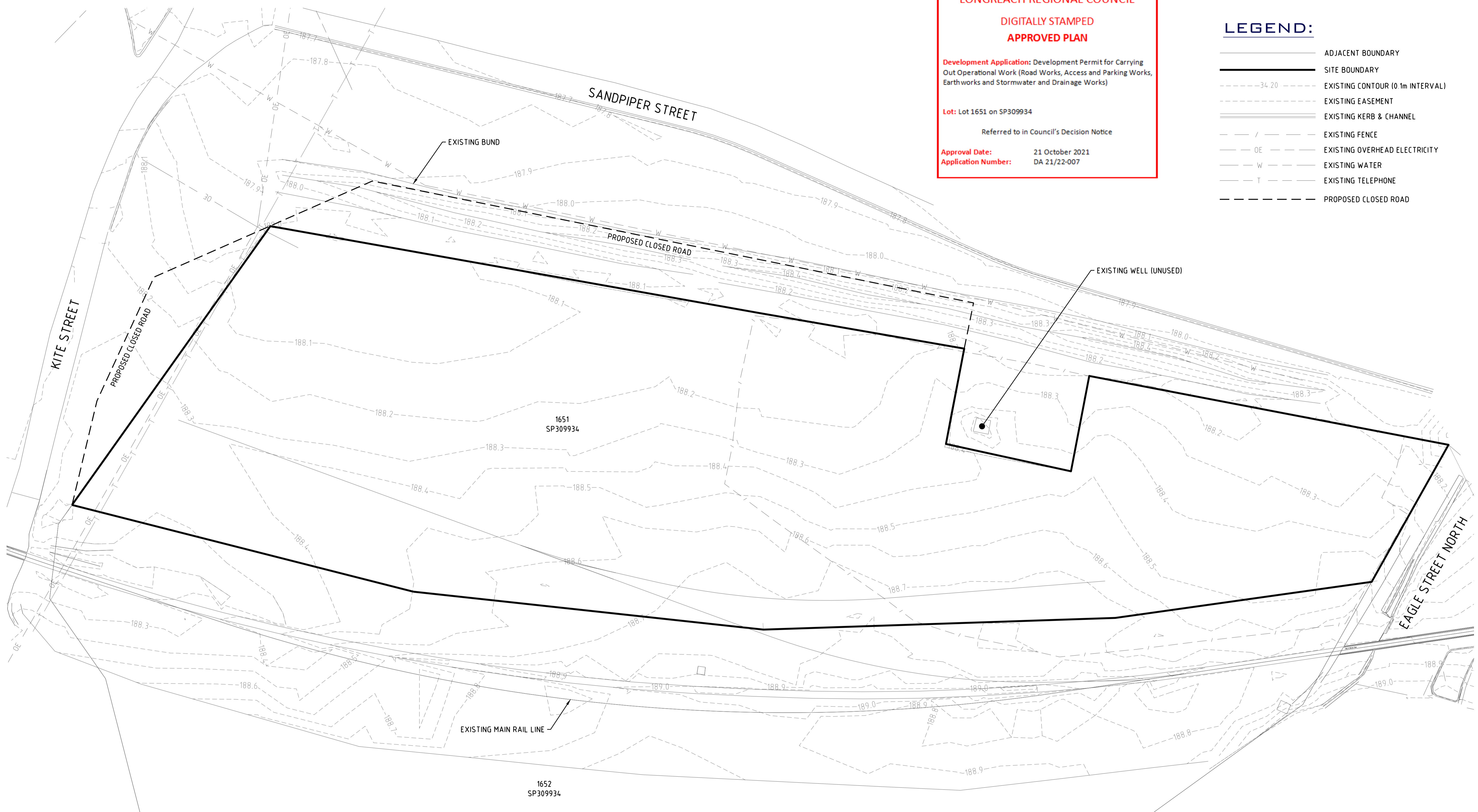

No.	DATE	REVISIONS	BY	CKD

SCALE: Scale 1:300 - A1 (1:600 - A3)

PROJECT NO: 130-002

DATE: 01/08/21

CHECKED: GWA

DRAWN: TG

DESIGNED: TG

LOCAL AUTHORITY APPROVAL NO:

SURVEYED: BJNORTH SURVEY

DATUM: AHD

APPROVED:

GLENN AINSWORTH
 CPESC No: 7676
 RPEQ No: 19204

FOR AND ON BEHALF OF BAX ENGINEERING PTY. LTD.

BAX
 Engineering PTY. LTD.

2261 DAVID LOW WAY, PEREBIAN BEACH, QLD 4573
 INFO@BAXENGINEERING.COM.AU

CLIENT: OUTBACK AUSSIE TOURS

PROJECT: 95 EAGLE STREET, LONGREACH

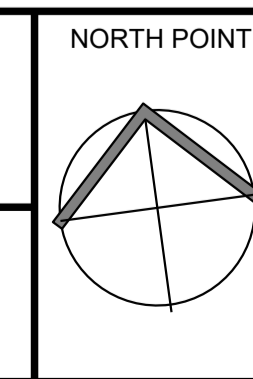

TITLE: EXISTING FEATURE PLAN

PLAN No: 130-002-100

REVISION: A

A1

LONGREACH REGIONAL COUNCIL
DIGITALLY STAMPED
APPROVED PLAN

Development Application: Development Permit for Carrying Out Operational Work (Road Works, Access and Parking Works, Earthworks and Stormwater and Drainage Works)

Lot: Lot 1651 on SP309934

Referred to in Council's Decision Notice

Approval Date: 21 October 2021
Application Number: DA 21/22-007

- LEGEND:**
- ADJACENT BOUNDARY
 - BOUNDARY
 - BOUNDARY SETBACKS
 - EXISTING FENCE
 - EXISTING EDGE OF CONCRETE
 - EXISTING OVERHEAD ELECTRICITY
 - EXISTING WATER
 - EXISTING TELEPHONE
 - EXISTING KERB & CHANNEL
 - PROPOSED CLOSED ROAD
 - FLOODED AREA 125m³

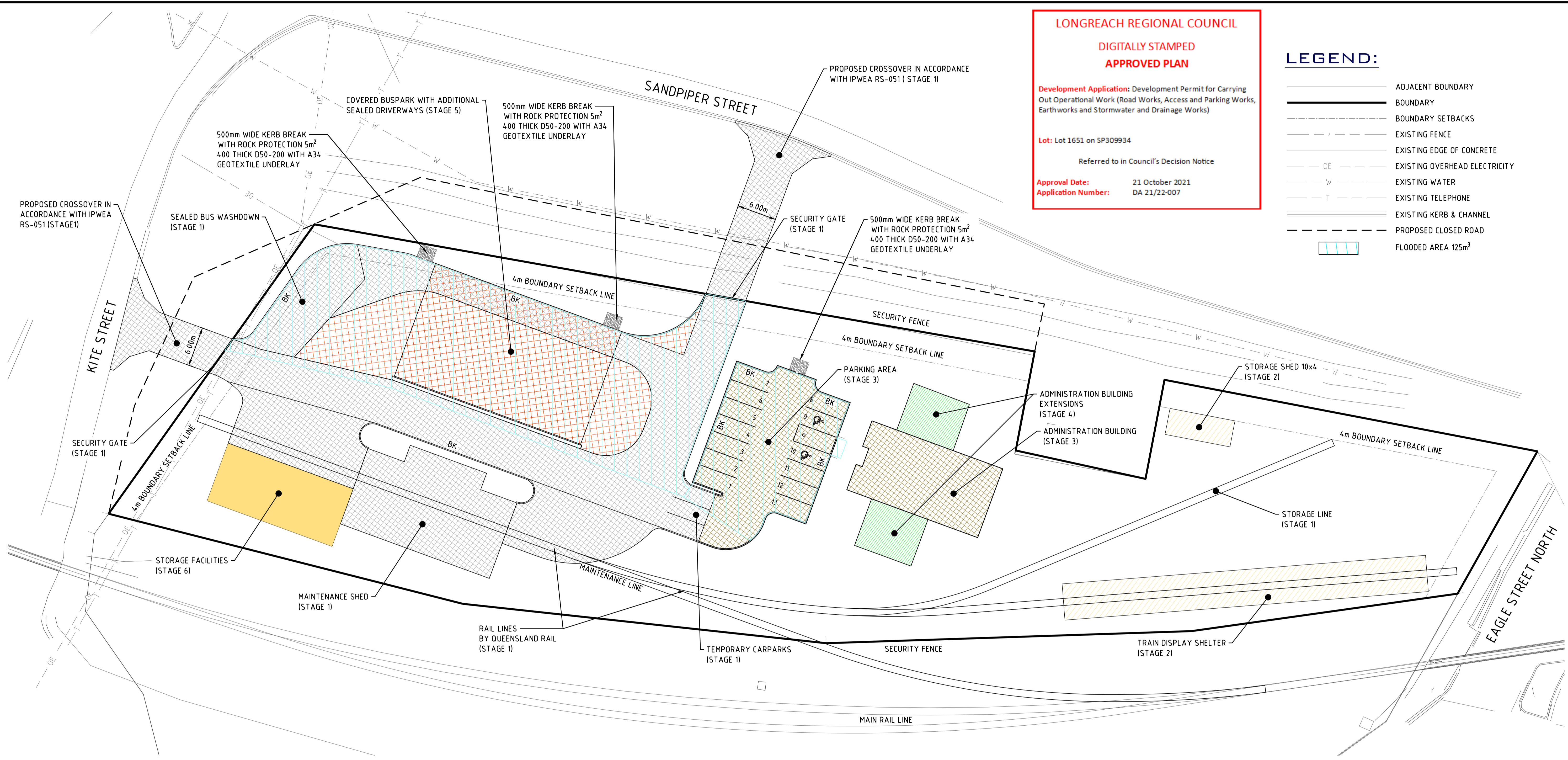

STAGE	1	2	3	4	5	6
ITEMS	MAINTENANCE SHED	DISPLAY SHELTER	ADMINISTRATION BUILDING (231m ²)	ADMINISTRATION BUILDING EXTENSIONS(135m ²)	COVERED BUS PARK	STORAGE SHED (180m ²)
	BUS WASHDOWN	STORAGE SHED (40m ²)	PARKING AREA		REMAINING ACCESS PAVEMENT	
	KITE ST ENTRY					
	SANDPIPER ST ENTRY					
	3 TEMPORARY CARPARKS					
	ACCESS LOOP FOR BUS WASHDOWN					
	MAINTENANCE RAIL LINE					
	DISPLAY RAIL LINE					
STORAGE LINE						
LEGEND						

DRAWING TO BE READ WITH QR PLAN SET REFER QUEENSLAND RAIL DRAWING SET QR-C-D92578, QR-C-D92580 AND QR-C-D92581 FOR RAIL SET OUT DETAILS AND LEVELS

	SCALE: Scale 1:300 - A1(1:600 - A3)	SURVEYED: BJNORTH SURVEY DATUM: AHD	 BAX Engineering PTY. LTD. 2261 DAVID LOW WAY, PEREGRINE BEACH, QLD 4573 INFO@BAXENGINEERING.COM.AU	CLIENT: OUTBACK AUSSIE TOURS PROJECT: 95 EAGLE STREET, LONGREACH	NORTH POINT 	TITLE: STAGING LAYOUT PLAN PLAN No 130-002-101
PROJECT NO: 130-002	DATE: 01/08/21	APPROVED: GLENN AINSWORTH CPESC No: 7878 RPEQ No: 19204		REVISIONS:	REVISION: A	PLAN No: 130-002-101
No. DATE REVISIONS BY CKD	TG GWA	LOCAL AUTHORITY APPROVAL NO:	DESIGNED: TG	REVISION: A	REVISION: A	PLAN No: 130-002-101

LONGREACH REGIONAL COUNCIL
DIGITALLY STAMPED
APPROVED PLAN

Development Application: Development Permit for Carrying Out Operational Work (Road Works, Access and Parking Works, Earthworks and Stormwater and Drainage Works)

Lot: Lot 1651 on SP309934

Referred to in Council's Decision Notice

Approval Date: 21 October 2021
Application Number: DA 21/22-007



1652
SP309934

LEGEND:

- ADJACENT BOUNDARY
- BOUNDARY
- EXISTING EASEMENT
- EXISTING FENCE
- EXISTING EDGE OF CONCRETE
- EXISTING KERB & CHANNEL
- EXISTING OVERHEAD ELECTRICITY
- EXISTING WATER
- EXISTING TELEPHONE
- PROPOSED CLOSED ROAD
- PROPOSE BARRIER KERB
- DESIGN CONTOUR MINOR
- DESIGN CONTOUR MAJOR
- PROPOSED FILL AREA
- PROPOSED CUT AREA
- PROPOSED SWALE

EARTHWORKS VOLUME
 EARTHWORKS VOLUME FROM EXISTING SURFACE TO DESIGN SURFACE
 CUT = 175 m³
 FILL = 1,275 m³
 BALANCE = 1,100 m³

SCALE: 0 3 6 9 12 15m Scale 1:300 - A1(1:600 - A3)		SURVEYED: BJNORTH SURVEY			CLIENT: OUTBACK AUSSIE TOURS		NORTH POINT 	TITLE: EARTHWORKS PLAN	
		PROJECT NO: 130-002			DATE: 01 08 21			PROJECT: 95 EAGLE STREET, LONGREACH	
CHECKED: GWA DRAWN: TG		APPROVED: 		2261 DAVID LOW WAY, PEREGRINE BEACH, QLD 4573 INFO@BAXENGINEERING.COM.AU		REVISION A		A1	
LOCAL AUTHORITY APPROVAL NO: _____		FOR AND ON BEHALF OF BAX ENGINEERING PTY. LTD.				REVISION A		A1	
No. DATE REVISIONS BY CKD									

Development Application: Development Permit for Carrying Out Operational Work (Road Works, Access and Parking Works, Earthworks and Stormwater and Drainage Works)

Lot: Lot 1651 on SP309934

Referred to in Council's Decision Notice

Approval Date: 21 October 2021
Application Number: DA 21/22-007

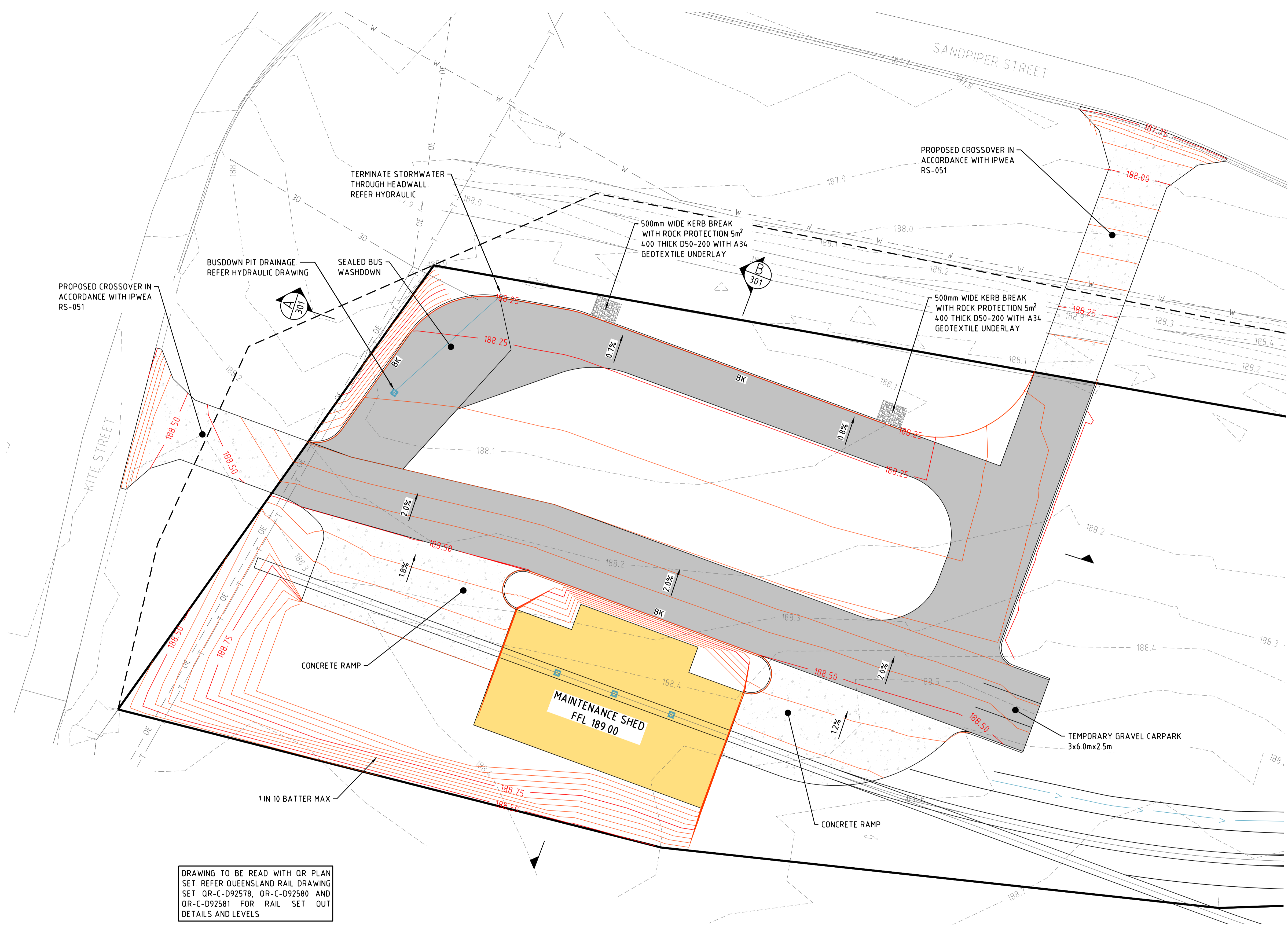

DRAWING TO BE READ WITH QR PLAN SET. REFER QUEENSLAND RAIL DRAWING SET QR-C-D92578, QR-C-D92580 AND QR-C-D92581 FOR RAIL SET OUT DETAILS AND LEVELS

LEGEND:

	ADJACENT BOUNDARY
	BOUNDARY
	EXISTING EASEMENT
	EXISTING FENCE
	EXISTING EDGE OF CONCRETE
	EXISTING KERB & CHANNEL
	EXISTING OVERHEAD ELECTRICITY
	EXISTING WATER
	EXISTING TELSTRA
	PROPOSED CLOSED ROAD
	PROPOSE BARRIER KERB
	PROPOSED CONCRETE PAVEMENT
	PROPOSED ASPHALT PAVEMENT

No.	DATE	REVISIONS	BY	CHKD
A	01/08/2021	ISSUED FOR INFORMATION	TG	GWA

SCALE:	0 2 4 6 8 10m
	Scale 1:200 - A1(1:400 - A3)
PROJECT NO:	130-002
DATE	01/08/21
CHECKED	GWA
DRAWN	TG
DESIGNED	TG

SURVEYED:	BJNORTH SURVEY
DATUM:	AHD
APPROVED:	
	GLENN AINSWORTH CPESC No: 7878 RPEQ No: 19204
	FOR AND ON BEHALF OF BAX ENGINEERING PTY. LTD.

BAX Engineering PTY. LTD.
2261 DAVID LOW WAY, PEREGRINE BEACH, QLD 4573
INFO@BAXENGINEERING.COM.AU

CLIENT:	OUTBACK AUSSIE TOURS
PROJECT:	95 EAGLE STREET, LONGREACH

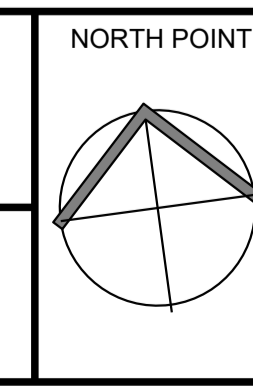

TITLE:	STAGE 1 GRADING AND DRAINAGE LAYOUT PLAN
PLAN No	130-002-300
REVISION	A
	A1

LONGREACH REGIONAL COUNCIL

DIGITALLY STAMPED
APPROVED PLAN

Development Application: Development Permit for Carrying Out Operational Work (Road Works, Access and Parking Works, Earthworks and Stormwater and Drainage Works)

Lot: Lot 1651 on SP309934

Referred to in Council's Decision Notice

Approval Date: 21 October 2021
Application Number: DA 21/22-007

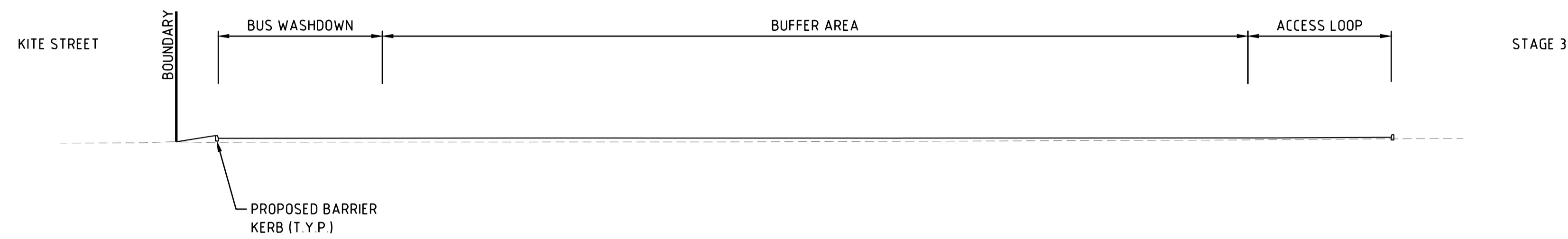

SECTION A
SCALE 1:200 130-002-300

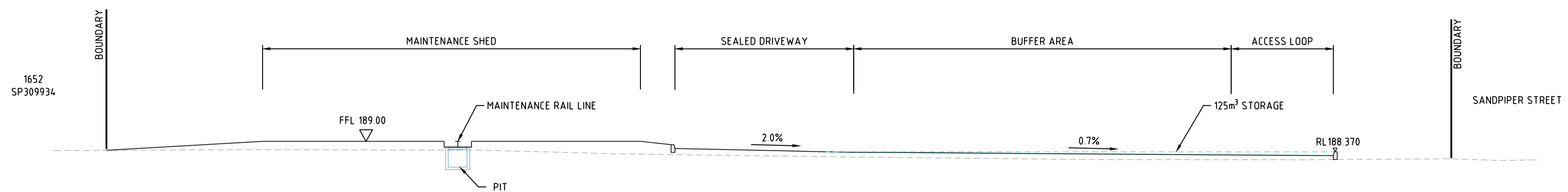

SECTION B
SCALE 1:100 130-002-300

SCALE:		SURVEYED:		CLIENT:		NORTH POINT		TITLE:	
PROJECT NO: 130-002		DATE: 01/08/21		OUTBACK AUSSIE TOURS				STAGE 1 SITE SECTIONS	
CHECKED: GWA		APPROVED:		PROJECT: 95 EAGLE STREET, LONGREACH				PLAN No 130-002-301	
DRAWN: TG		FOR AND ON BEHALF OF BAX ENGINEERING PTY. LTD.		2261 DAVID LOW WAY, PEREBIAN BEACH, QLD 4573 INFO@BAXENGINEERING.COM.AU				REVISION A A1	
DESIGNED: TG									
No.	DATE	REVISIONS	BY	CKD					

KITE STREET

SANDPIPER STREET

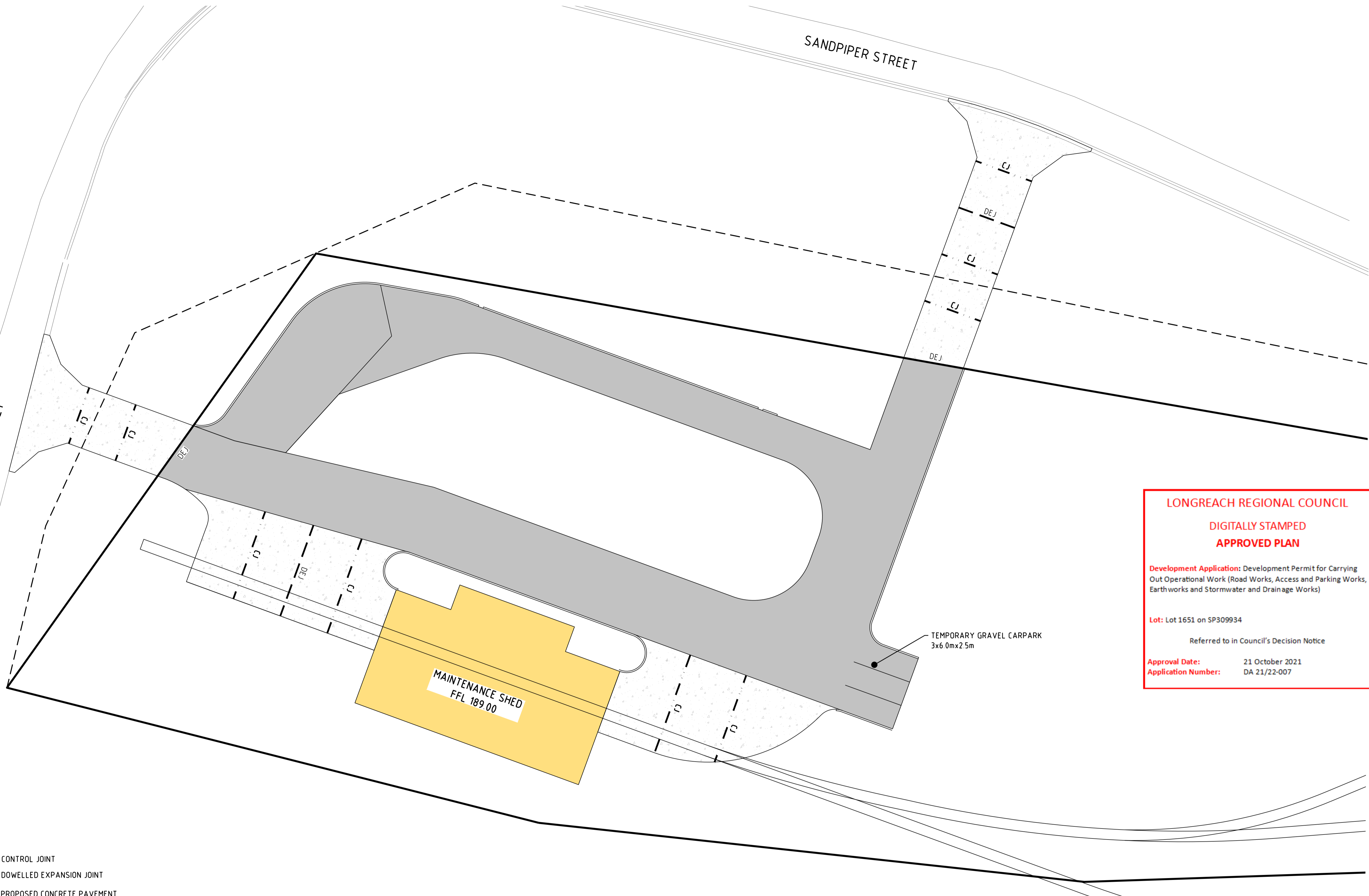

MAINTENANCE SHED
FFL 189.00

TEMPORARY GRAVEL CARPARK
3x6.0m x 2.5m

LONGREACH REGIONAL COUNCIL
DIGITALLY STAMPED
APPROVED PLAN

Development Application: Development Permit for Carrying Out Operational Work (Road Works, Access and Parking Works, Earthworks and Stormwater and Drainage Works)

Lot: Lot 1651 on SP309934

Referred to in Council's Decision Notice

Approval Date: 21 October 2021
Application Number: DA 21/22-007

LEGEND:

- CJ CONTROL JOINT
- DEJ DOWELLED EXPANSION JOINT
- PROPOSED CONCRETE PAVEMENT
- PROPOSED ASPHALT PAVEMENT

No.	DATE	REVISIONS	BY	CKD
A	01/08/2021	ISSUED FOR INFORMATION	TG	GWA

SCALE:	
Scale 1:200 - A1(1:4.00 - A3)	
PROJECT NO:	130-002
DATE	01/08/21
CHECKED	GWA
DRAWN	TG
DESIGNED	TG

SURVEYED:	BJNORTH SURVEY
DATUM:	AHD
APPROVED:	
GLENN AINSWORTH	CPESC No: 7878
RPEQ No: 19204	
FOR AND ON BEHALF OF BAX ENGINEERING PTY. LTD.	

BAX Engineering PTY. LTD.

2261 DAVID LOW WAY, PEREGRINE BEACH, QLD 4573
INFO@BAXENGINEERING.COM.AU

CLIENT:	OUTBACK AUSSIE TOURS
PROJECT:	95 EAGLE STREET, LONGREACH

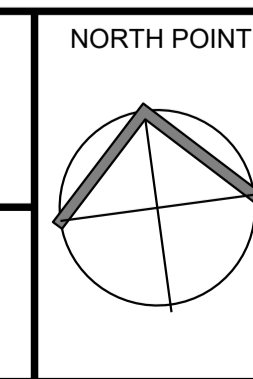

TITLE:	STAGE 1 PAVEMENT JOINTING PLAN
PLAN No	130-002-302
REVISION	A
	A1

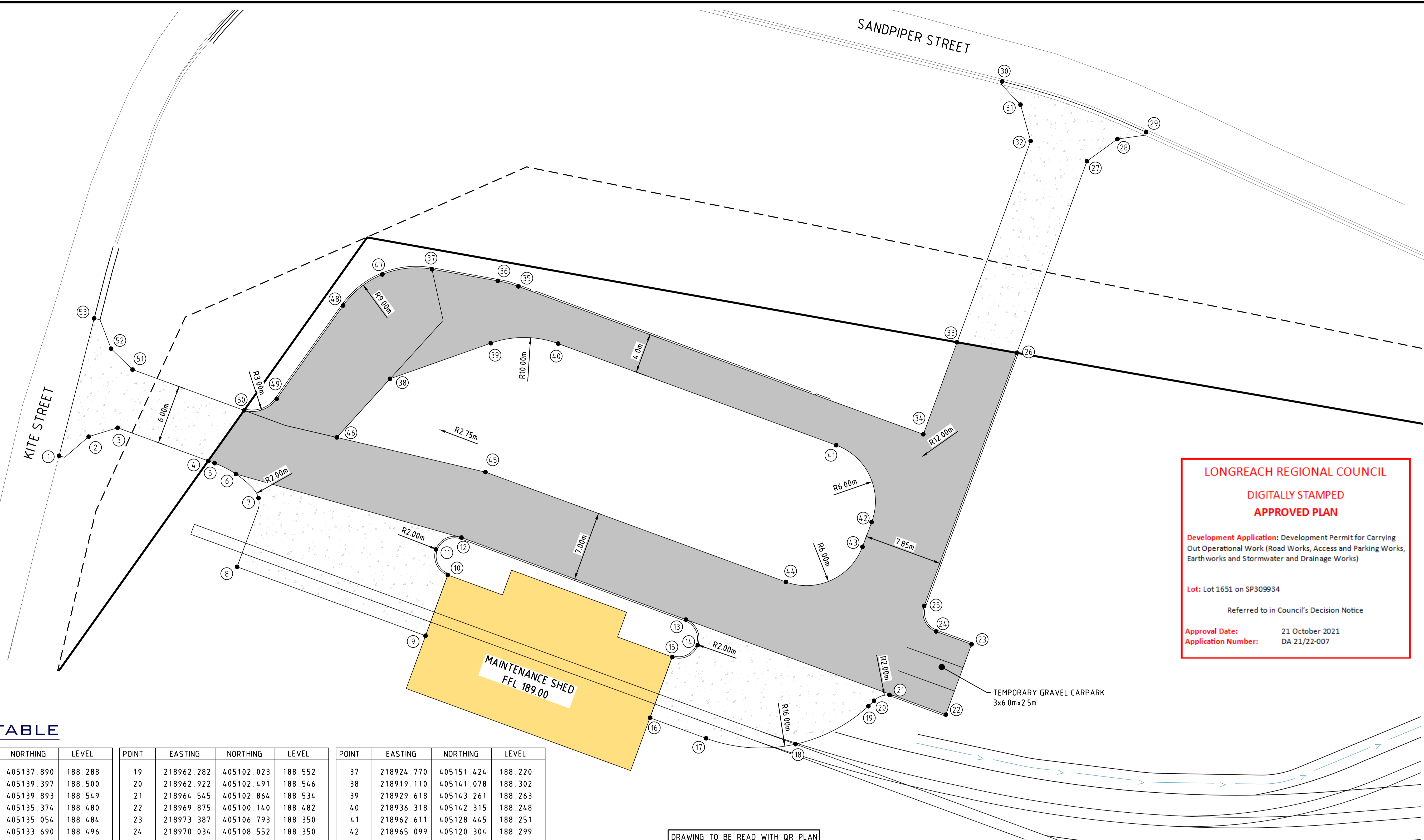

LONGREACH REGIONAL COUNCIL
DIGITALLY STAMPED
APPROVED PLAN

Development Application: Development Permit for Carrying Out Operational Work (Road Works, Access and Parking Works, Earthworks and Stormwater and Drainage Works)

Lot: Lot 1651 on SP309934

Referred to in Council's Decision Notice

Approval Date: 21 October 2021
Application Number: DA 21/22-007

SETOUT TABLE

POINT	EASTING	NORTHING	LEVEL	POINT	EASTING	NORTHING	LEVEL	POINT	EASTING	NORTHING	LEVEL
1	218885.142	405137.890	188.288	19	218962.282	405102.023	188.552	37	218924.770	405151.424	188.220
2	218888.345	405139.397	188.500	20	218962.922	405102.491	188.546	38	218919.110	405141.078	188.302
3	218891.355	405139.893	188.549	21	218964.545	405102.864	188.534	39	218929.618	405143.261	188.263
4	218899.916	405135.374	188.480	22	218969.875	405100.140	188.482	40	218936.318	405142.315	188.248
5	218900.522	405135.054	188.484	23	218973.387	405106.793	188.350	41	218962.611	405128.445	188.251
6	218902.492	405133.690	188.496	24	218970.034	405108.552	188.350	42	218965.099	405120.304	188.299
7	218904.422	405130.981	188.551	25	218969.195	405111.257	188.352	43	218963.851	405117.976	188.318
8	218901.357	405124.434	188.648	26	218981.830	405135.192	188.370	44	218955.762	405115.505	188.358
9	218919.174	405115.032	189.648	27	218991.398	405153.318	188.008	45	218927.343	405130.508	188.350
10	218922.212	405120.777	188.576	28	218994.736	405155.113	187.941	46	218913.022	405135.967	188.350
11	218921.372	405123.482	188.538	29	218997.676	405155.411	187.744	47	218919.760	405151.570	188.262
12	218924.075	405124.317	188.501	30	218984.055	405162.403	187.725	48	218915.450	405149.013	188.253
13	218945.299	405113.113	188.500	31	218985.553	405159.851	187.926	49	218907.571	405140.613	188.324
14	218946.134	405110.411	188.634	32	218986.075	405156.086	187.996	50	218904.172	405139.912	188.347
15	218943.432	405109.576	188.569	33	218976.029	405137.056	188.370	51	218893.620	405145.482	188.519
16	218940.398	405103.827	188.618	34	218971.432	405128.347	188.313	52	218891.773	405147.849	188.460
17	218945.702	405101.027	188.618	35	218933.141	405148.540	188.220	53	218890.499	405151.102	188.235
18	218954.526	405099.234	188.610	36	218931.166	405149.373	188.220				

DRAWING TO BE READ WITH QR PLAN
 SET REFER QUEENSLAND RAIL DRAWING
 SET QR-C-D92578, QR-C-D92580 AND
 QR-C-D92581 FOR RAIL SET OUT
 DETAILS AND LEVELS

LEGEND:

- BK PROPOSED CLOSED ROAD
- PROPOSE BARRIER KERB
- PROPOSED CONCRETE PAVEMENT
- PROPOSED ASPHALT PAVEMENT

	SCALE: 0 2 4 6 8 10m Scale 1:200 - A1(1:400 - A3)	SURVEYED: BJNORTH SURVEY DATUM: AHD		CLIENT: OUTBACK AUSSIE TOURS	NORTH POINT 	TITLE: STAGE 1 SETOUT PLAN
	PROJECT NO: 130-002	DATE: 01/08/21	APPROVED: 	PROJECT: 95 EAGLE STREET, LONGREACH	PLAN No 130-002-305	REVISION A
No. DATE REVISIONS BY CKD	LOCAL AUTHORITY APPROVAL NO: TOWN PLANNING GWA	CHECKED: GWA	DESIGNED: TG	FOR AND ON BEHALF OF BAX ENGINEERING PTY. LTD.	2261 DAVID LOW WAY, PEREGRINE BEACH, QLD 4573 INFO@BAXENGINEERING.COM.AU	A1

LONGREACH REGIONAL COUNCIL

DIGITALLY STAMPED
APPROVED PLAN

Development Application: Development Permit for Carrying Out Operational Work (Road Works, Access and Parking Works, Earthworks and Stormwater and Drainage Works)

Lot: Lot 1651 on SP309934

Referred to in Council's Decision Notice

Approval Date: 21 October 2021
Application Number: DA 21/22-007

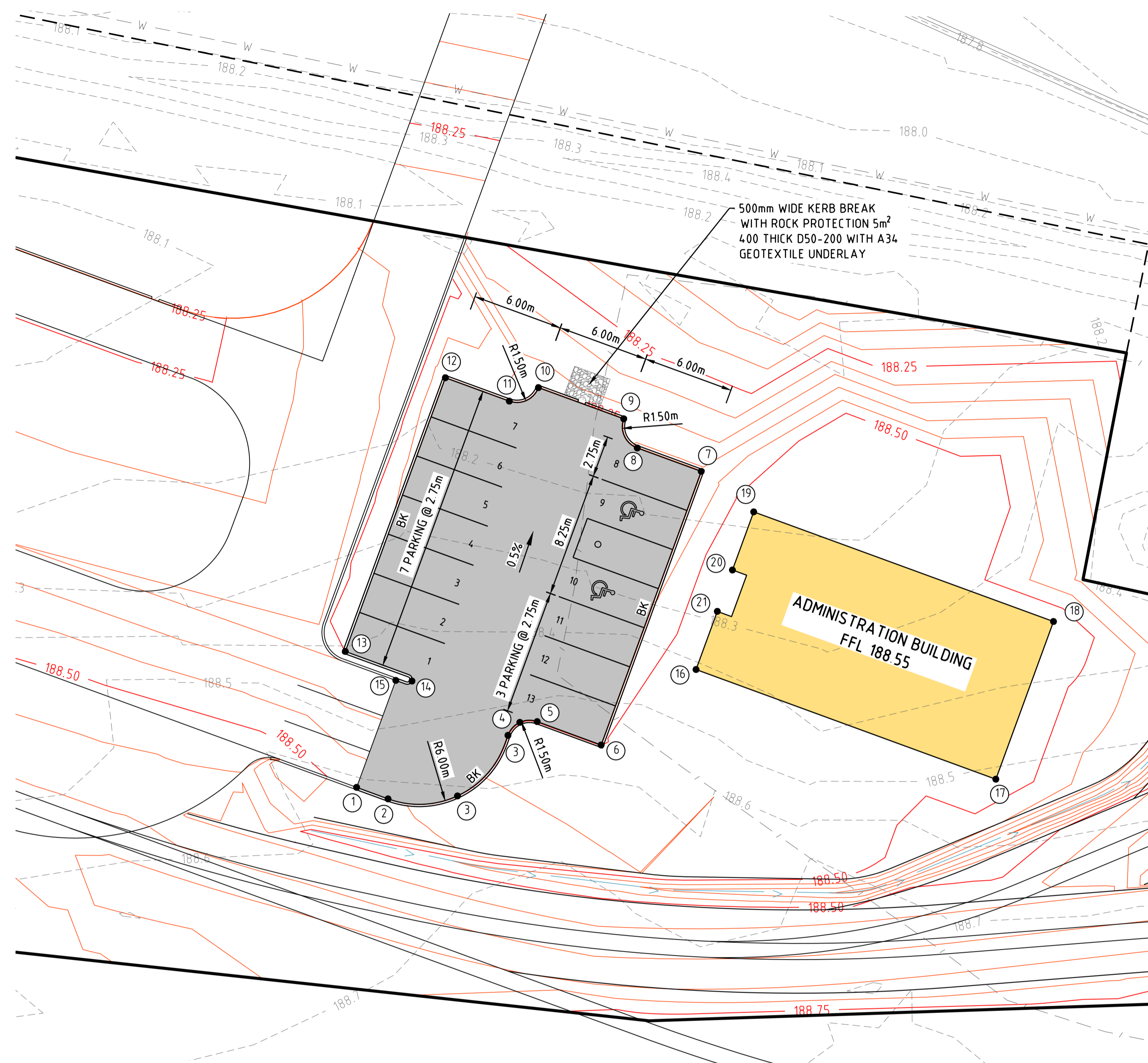

SETOUT TABLE

POINT	EASTING	NORTHING	LEVEL	POINT	EASTING	NORTHING	LEVEL
1	218969.875	405100.140	188.482	12	218983.305	405124.063	188.254
2	218971.828	405099.109	188.462	13	218979.326	405126.164	188.254
3	218976.401	405098.682	188.435	14	218970.339	405109.140	188.351
4	218980.244	405102.199	188.372	15	218974.442	405106.606	188.350
5	218981.135	405102.945	188.361	16	218973.387	405106.793	188.350
6	218982.278	405102.838	188.351	17	218993.142	405104.835	188.550
7	218986.257	405100.737	188.351	18	219011.793	405094.990	188.550
8	218995.244	405117.761	188.254	19	219016.970	405104.797	188.550
9	218991.264	405119.862	188.250	20	218998.320	405114.643	188.550
10	218990.638	405121.888	188.220	21	218996.410	405111.026	188.550
11	218985.332	405124.689	188.220	22	218995.052	405108.452	188.550

LEGEND:

	ADJACENT BOUNDARY		PROPOSED CLOSED ROAD
	BOUNDARY		PROPOSE BARRIER KERB
	EXISTING EASEMENT		PROPOSED ASPHALT PAVEMENT
	EXISTING FENCE		DESIGN CONTOUR MINOR
	EXISTING EDGE OF CONCRETE		DESIGN CONTOUR MAJOR
	EXISTING KERB & CHANNEL		PROPOSED SWALE
	EXISTING OVERHEAD ELECTRICITY		
	EXISTING WATER		
	EXISTING TELEPHONE		

SCALE: 0 2 4 6 8 10m Scale 1:200 - A1(1:400 - A3)		SURVEYED: BJNORTH SURVEY DATUM: AHD		CLIENT: OUTBACK AUSSIE TOURS		NORTH POINT 		TITLE: STAGE 3 LAYOUT PLAN & DETAILS	
PROJECT NO: 130-002		DATE: 01/08/21		APPROVED: 		PROJECT: 95 EAGLE STREET, LONGREACH		PLAN No 130-002-311	
CHECKED: GWA		DRAWN: TG		DESIGNED: TG		REVISION: A		A1	
LOCAL AUTHORITY APPROVAL NO:		FOR AND ON BEHALF OF BAX ENGINEERING PTY. LTD.		 2261 DAVID LOW WAY, PEREGRINE BEACH, QLD 4573 INFO@BAXENGINEERING.COM.AU		REVISION: A PLAN No: 130-002-311		REVISION: A A1	
No. DATE REVISIONS BY CKD		01/08/2021 ISSUED FOR INFORMATION TG GWA							

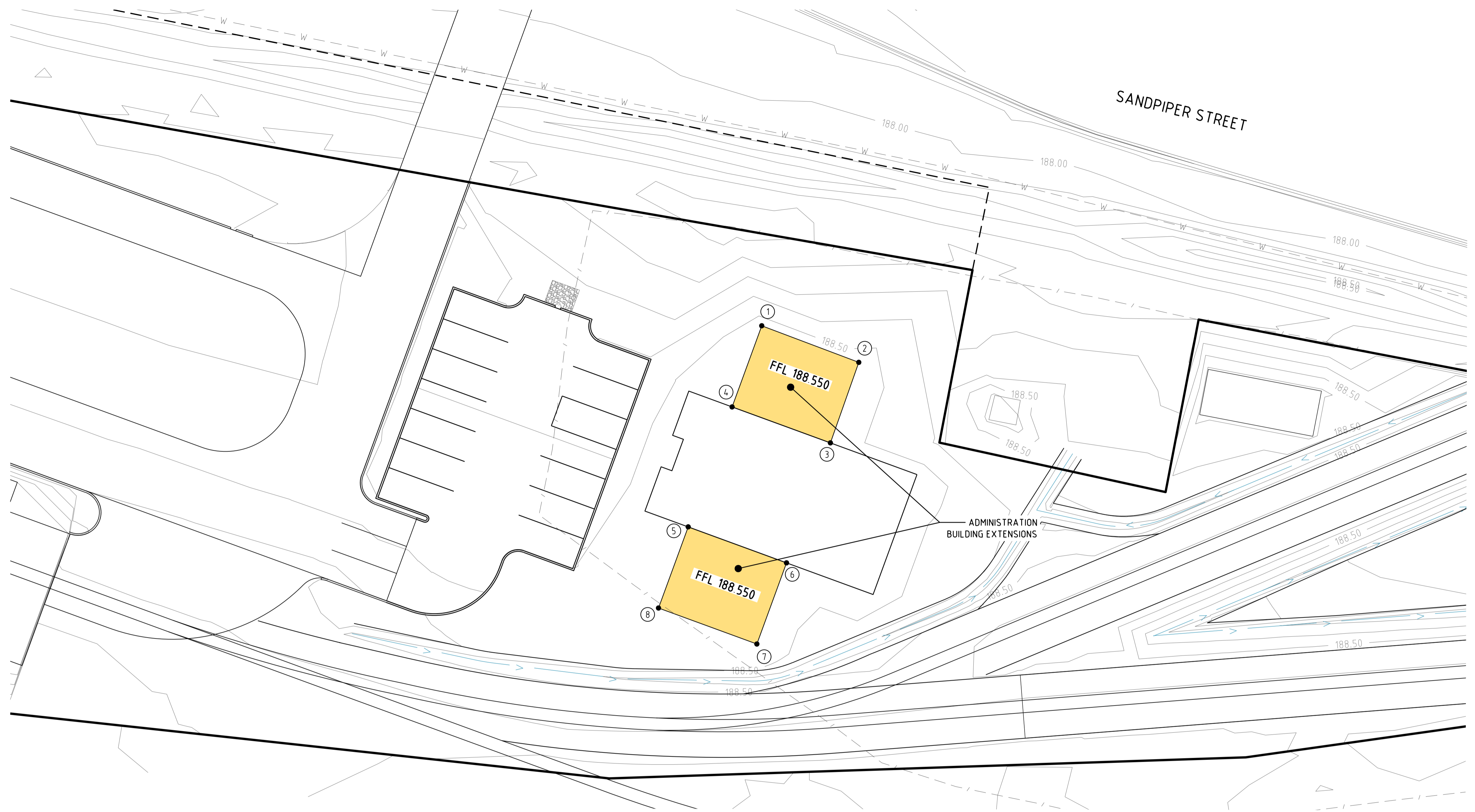

SETOUT TABLE

POINT	EASTING	NORTHING	LEVEL
1	219005.358	405119.408	188.550
2	219013.275	405115.127	188.550
3	219009.896	405108.532	188.550
4	219001.857	405112.775	188.550
5	218996.680	405102.968	188.550
6	219004.718	405098.724	188.550
7	219001.217	405092.092	188.550
8	218993.179	405096.335	188.550

LONGREACH REGIONAL COUNCIL

DIGITALLY STAMPED
APPROVED PLAN

Development Application: Development Permit for Carrying Out Operational Work (Road Works, Access and Parking Works, Earthworks and Stormwater and Drainage Works)

Lot: Lot 1651 on SP309934

Referred to in Council's Decision Notice

Approval Date: 21 October 2021
Application Number: DA 21/22-007

LEGEND:

- ADJACENT BOUNDARY
- BOUNDARY
- EXISTING EASEMENT
- EXISTING FENCE
- EXISTING EDGE OF CONCRETE
- EXISTING KERB & CHANNEL
- EXISTING OVERHEAD ELECTRICITY
- EXISTING WATER
- EXISTING TELSTRA
- FINISHED CONTOUR
- PROPOSED SWALE

	SCALE: Scale 1:200 - A1(1:400 - A3)	SURVEYED: BJNORTH SURVEY DATUM: AHD	 BAX Engineering PTY. LTD. 2261 DAVID LOW WAY, PEREBIAN BEACH, QLD 4573 INFO@BAXENGINEERING.COM.AU	CLIENT: OUTBACK AUSSIE TOURS PROJECT: 95 EAGLE STREET, LONGREACH	NORTH POINT 	TITLE: STAGE 4 LAYOUT PLAN & DETAILS
	PROJECT NO: 130-002	DATE: 01/08/21 CHECKED: GWA DRAWN: TG DESIGNED: TG	APPROVED: GLENN AINSWORTH CPESC No: 7678 RPEQ No: 19204 ISO 9001 UKAS			PLAN No 130-002-312 REVISION A A1
No. DATE REVISIONS BY CKD	A 01/08/2021 ISSUED FOR INFORMATION TG GWA	LOCAL AUTHORITY APPROVAL NO:	FOR AND ON BEHALF OF BAX ENGINEERING PTY. LTD.			

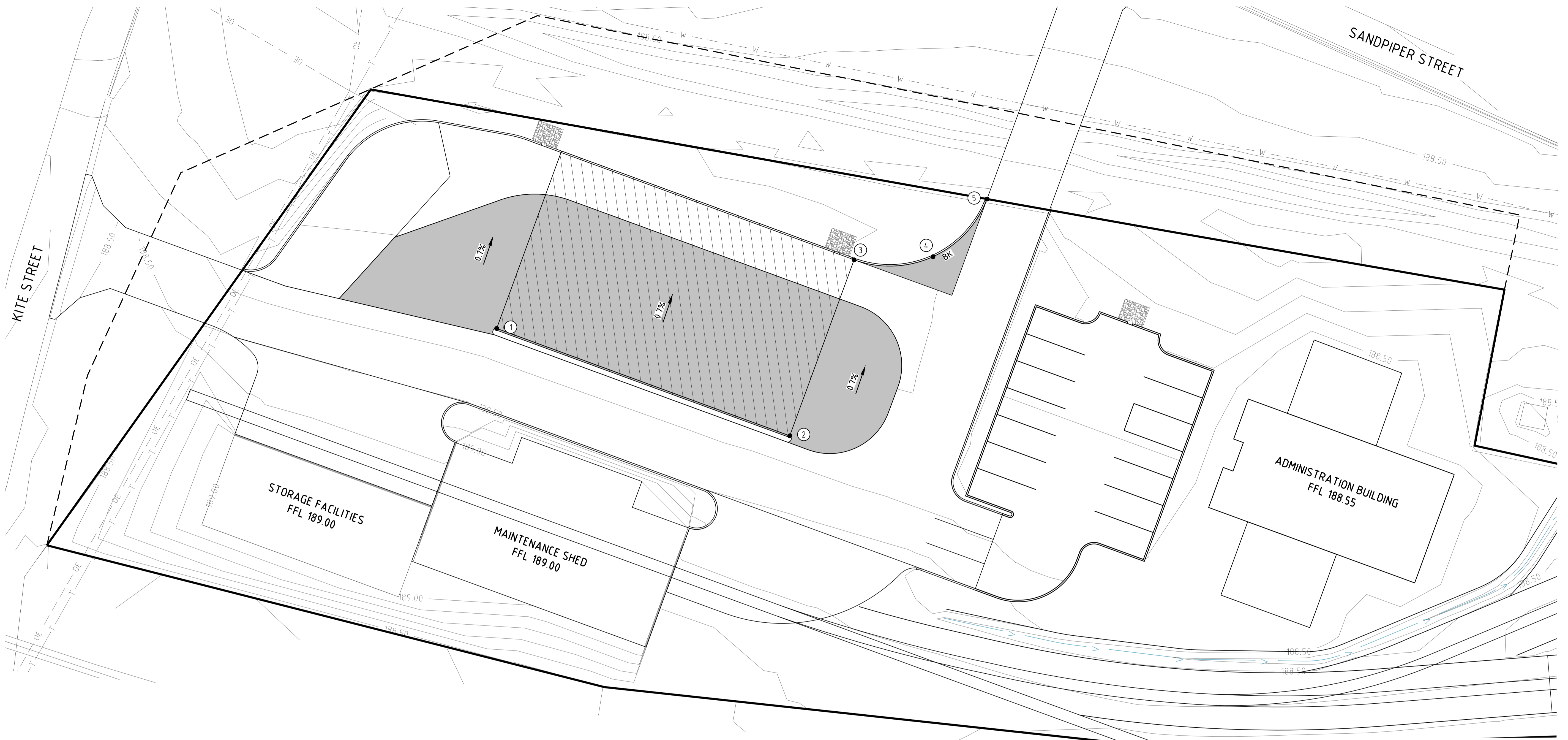

SETOUT TABLE

POINT	EASTING	NORTHING	LEVEL
1	218927.646	405131.083	188.346
2	218954.176	405117.077	188.350
3	218962.577	405132.995	188.220
4	218970.136	405132.265	188.300
5	218976.029	405137.056	188.370

LONGREACH REGIONAL COUNCIL

**DIGITALLY STAMPED
APPROVED PLAN**

Development Application: Development Permit for Carrying Out Operational Work (Road Works, Access and Parking Works, Earthworks and Stormwater and Drainage Works)

Lot: Lot 1651 on SP309934

Referred to in Council's Decision Notice

Approval Date: 21 October 2021
Application Number: DA 21/22-007

LEGEND:

	ADJACENT BOUNDARY
	BOUNDARY
	EXISTING EASEMENT
	EXISTING FENCE
	EXISTING EDGE OF CONCRETE
	EXISTING KERB & CHANNEL
	EXISTING OVERHEAD ELECTRICITY
	EXISTING WATER
	EXISTING TELEPHONE
	PROPOSED CLOSED ROAD
	PROPOSE BARRIER KERB
	PROPOSED ASPHALT PAVEMENT
	FINISHED CONTOUR

	SCALE: Scale 1:200 - A1(1:400 - A3)	SURVEYED: BJNORTH SURVEY DATUM: AHD	 BAX Engineering PTY. LTD. 2261 DAVID LOW WAY, PEREBIAN BEACH, QLD 4573 INFO@BAXENGINEERING.COM.AU	CLIENT: OUTBACK AUSSIE TOURS PROJECT: 95 EAGLE STREET, LONGREACH	NORTH POINT 	TITLE: STAGE 5 LAYOUT PLAN & DETAILS
PROJECT NO: 130-002	DATE: 01 08 21	APPROVED: 	GLENN AINSWORTH CPESC No: 7678 RPEQ No: 19204 	CHECKED: GWA DRAWN: TG DESIGNED: TG	LOCAL AUTHORITY APPROVAL NO: TG GWA BY: CKD	PLAN No 130-002-313 REVISION A A1
No. DATE REVISIONS						No. DATE REVISIONS

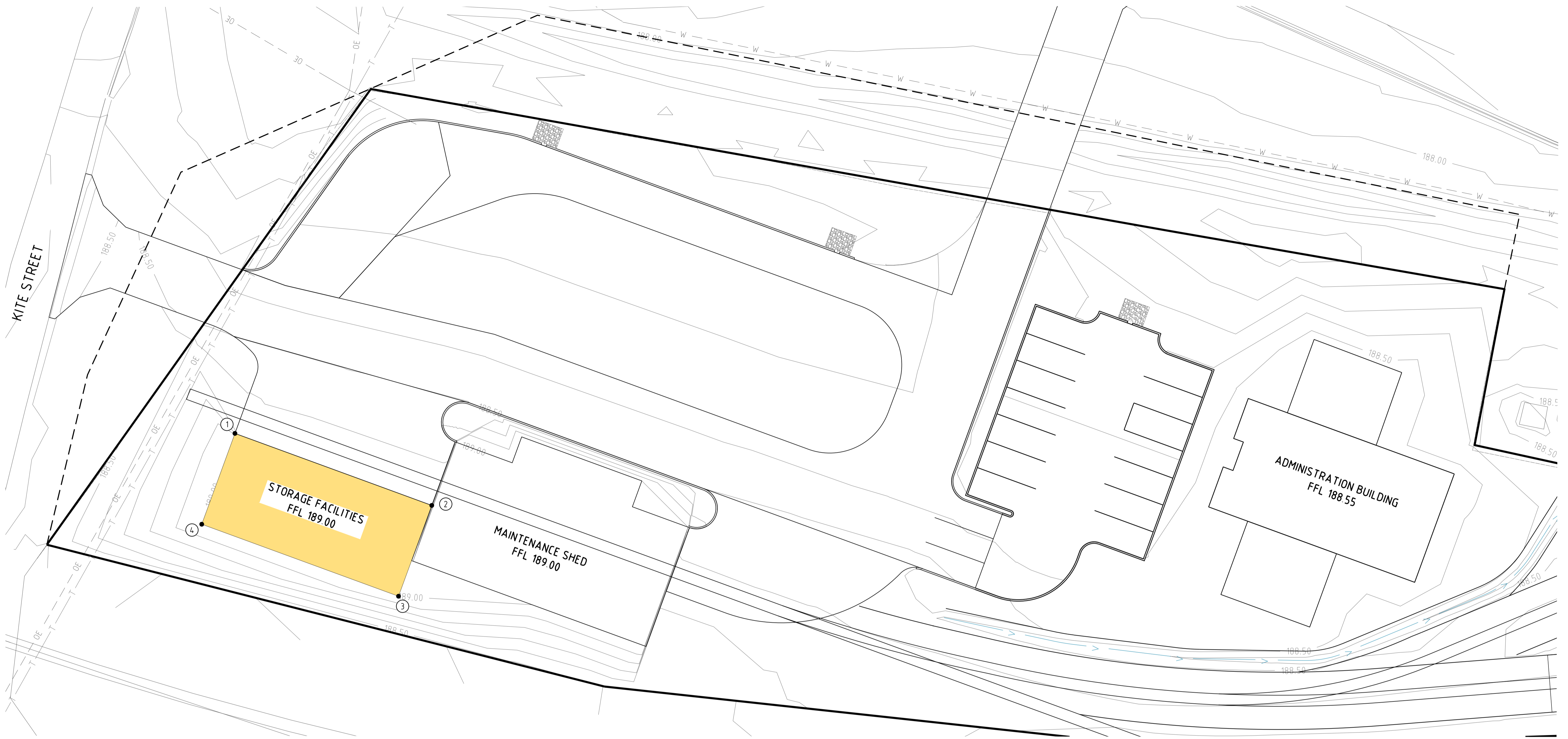

SETOUT TABLE

POINT	EASTING	NORTHING	LEVEL
1	218901.356	405124.432	189.000
2	218919.174	405115.033	189.000
3	218914.830	405106.814	189.000
4	218897.019	405116.217	189.000

LONGREACH REGIONAL COUNCIL

**DIGITALLY STAMPED
APPROVED PLAN**

Development Application: Development Permit for Carrying Out Operational Work (Road Works, Access and Parking Works, Earthworks and Stormwater and Drainage Works)

Lot: Lot 1651 on SP309934

Referred to in Council's Decision Notice

Approval Date: 21 October 2021
Application Number: DA 21/22-007

LEGEND:

- ADJACENT BOUNDARY
- BOUNDARY
- EXISTING EASEMENT
- EXISTING FENCE
- EXISTING EDGE OF CONCRETE
- EXISTING KERB & CHANNEL
- EXISTING OVERHEAD ELECTRICITY
- EXISTING WATER
- EXISTING TELEPHONE
- FINISHED CONTOUR

	SCALE: Scale 1:200 - A1(1:400 - A3)	SURVEYED: BJNORTH SURVEY DATUM: AHD	 BAX Engineering PTY. LTD. 2261 DAVID LOW WAY, PEREBIAN BEACH, QLD 4573 INFO@BAXENGINEERING.COM.AU	CLIENT: OUTBACK AUSSIE TOURS PROJECT: 95 EAGLE STREET, LONGREACH	NORTH POINT 	TITLE: STAGE 6 LAYOUT PLAN & DETAILS
		PROJECT NO: 130-002 LOCAL AUTHORITY APPROVAL NO:	DATE: 01 08 21 CHECKED: GWA DRAWN: TG DESIGNED: TG	APPROVED: GLENN AINSWORTH CPESC No: 7676 RPEQ No: 19204 FOR AND ON BEHALF OF BAX ENGINEERING PTY. LTD.		PLAN No 130-002-314 REVISION A A1
No. DATE REVISIONS BY CKD	A 01 08 2021 ISSUED FOR INFORMATION TG GWA					

Development Application: Development Permit for Carrying Out Operational Work (Road Works, Access and Parking Works, Earthworks and Stormwater and Drainage Works)

Lot: Lot 1651 on SP309934

Referred to in Council's Decision Notice

Approval Date: 21 October 2021
Application Number: DA 21/22-007

RAIL CONSTRUCTION IN ACCORDANCE WITH QR STANDARD DRAWINGS QR-C-S3307 TO QR-C-S3313 AND SPECIFICATION QR-CTS-PART 06

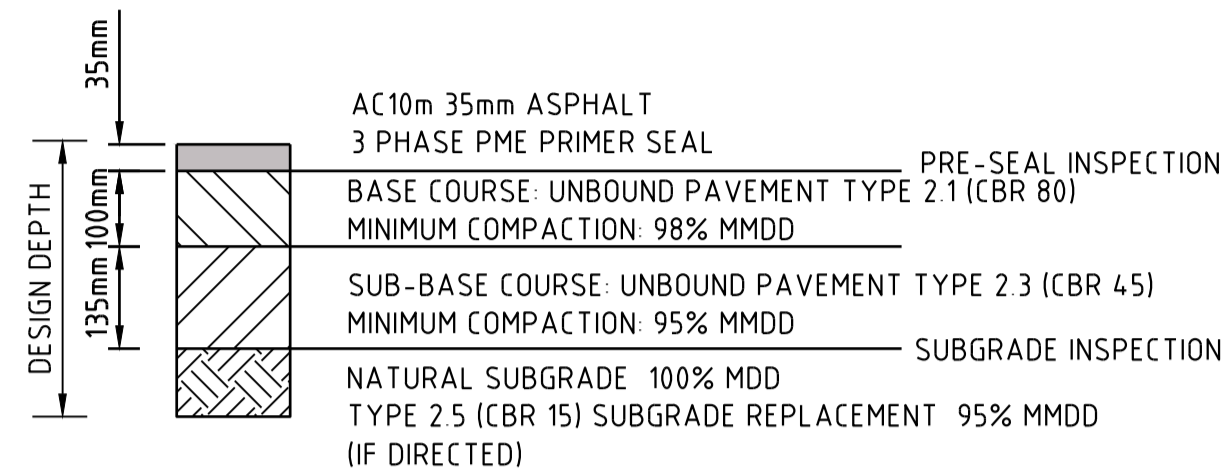

PRIMER SEAL TO COMPRISE OF A 10mm AGGREGATE AND A MINIMUM COVERAGE OF 170m²/m³
FINAL PAVEMENT DEPTH TO BE DETERMINED FOLLOWING SOIL TESTS BY GEOTECHNICAL ENGINEER.
SUBGRADE COMPACTED TO 100% STANDARD COMPACTION.
SUBSOIL DRAINAGE BENEATH ALL KERBS.
MMDD : MODIFIED MAXIMUM DRY DENSITY
MDD : STANDARD MAXIMUM DRY DENSITY
REFER PAVEMENT NOTES

ASPHALT PAVEMENT DETAIL
SCALE 1:10

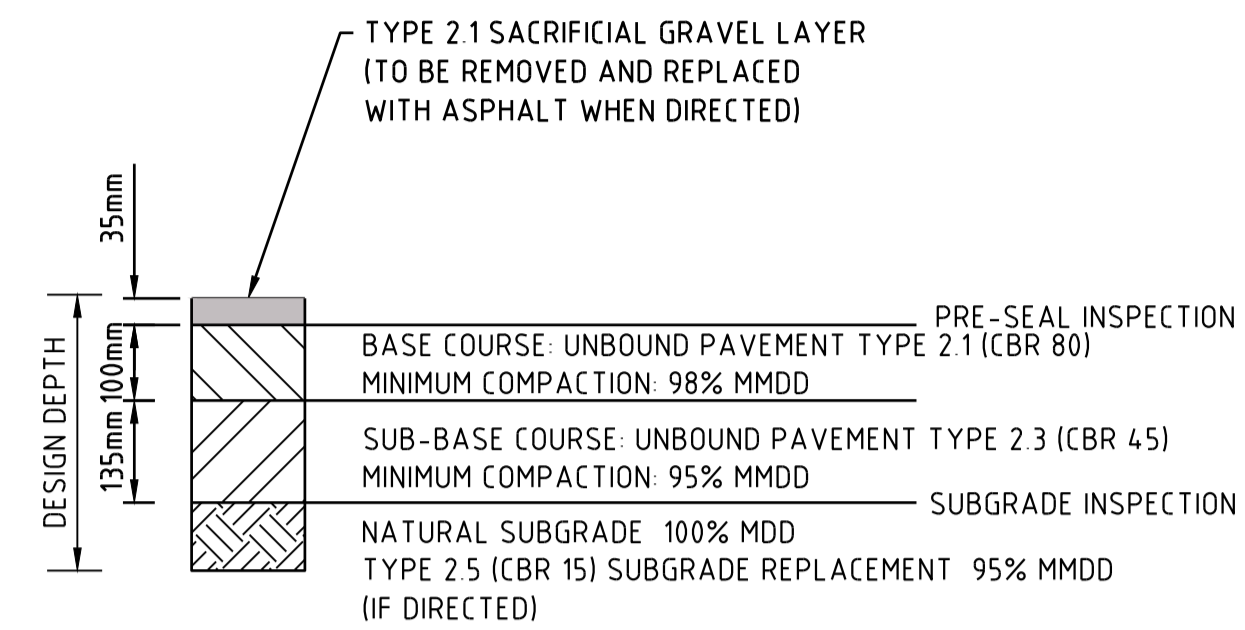

PRIMER SEAL TO COMPRISE OF A 10mm AGGREGATE AND A MINIMUM COVERAGE OF 170m²/m³
FINAL PAVEMENT DEPTH TO BE DETERMINED FOLLOWING SOIL TESTS BY GEOTECHNICAL ENGINEER.
SUBGRADE COMPACTED TO 100% STANDARD COMPACTION.
SUBSOIL DRAINAGE BENEATH ALL KERBS.
MMDD : MODIFIED MAXIMUM DRY DENSITY
MDD : STANDARD MAXIMUM DRY DENSITY
REFER PAVEMENT NOTES

GRAVEL PAVEMENT DETAIL
SCALE 1:10

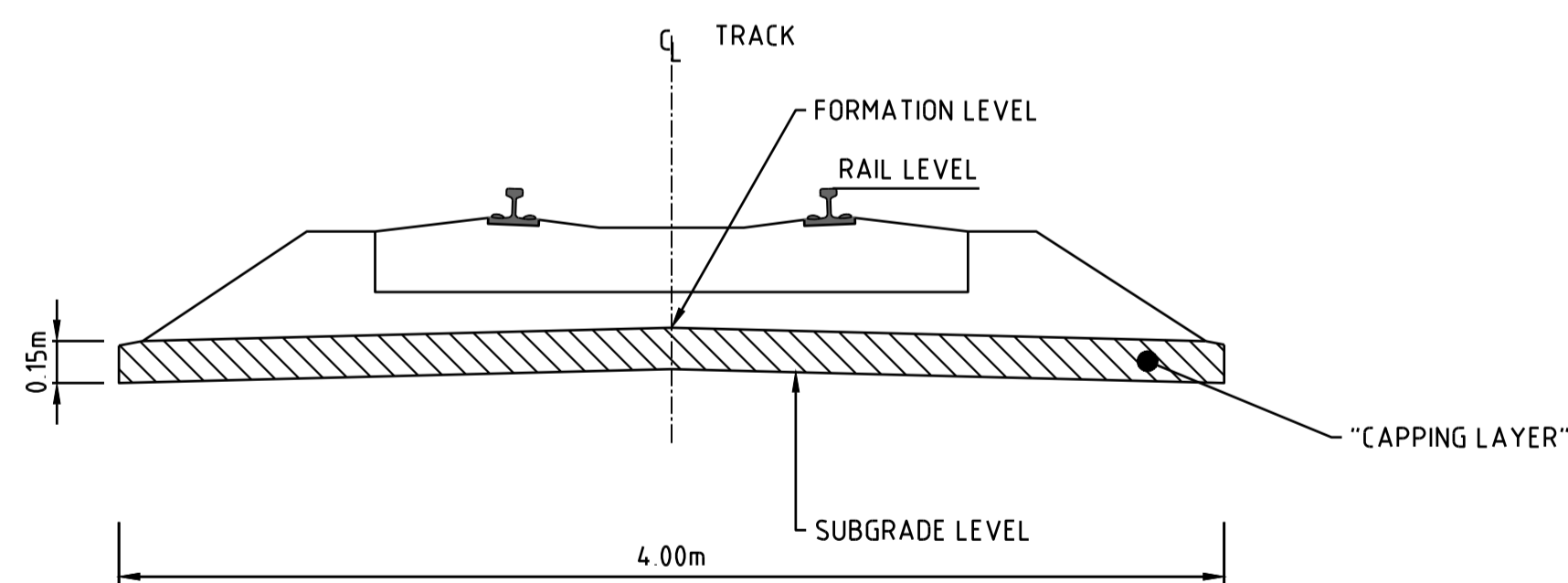

INTERNAL RAIL DETAIL
SCALE 1:25

DRAWING TO BE READ WITH QR PLAN SET. REFER QUEENSLAND RAIL DRAWING SET QR-C-D92578, QR-C-D92580 AND QR-C-D92581 FOR RAIL SET OUT DETAILS AND LEVELS

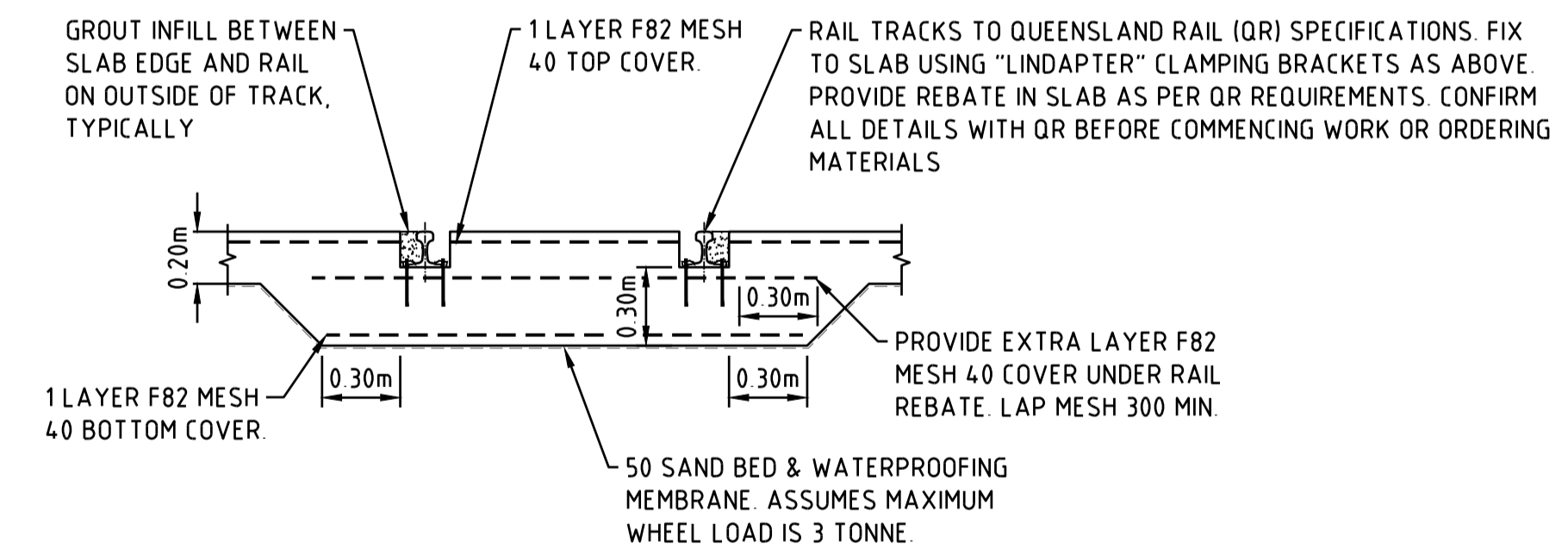

MAINTENANCE SHED AND RAMP
RAIL DETAIL
SCALE 1:25

<p>SCALE: 0 0.1 0.2 0.3 0.4 0.5m Scale 1:10 - A1 (1:20 - A3)</p>		<p>SURVEYED: BJNORTH SURVEY DATUM: AHD</p>		<p>CLIENT: OUTBACK AUSSIE TOURS PROJECT: 95 EAGLE STREET, LONGREACH</p>		<p>NORTH POINT: TITLE: DETAIL OF RAIL AND ROAD</p>	
<p>PROJECT NO: 130-002 DATE: 01/08/21 CHECKED: GWA DRAWN: TG DESIGNED: TG</p>		<p>APPROVED: GLENN AINSWORTH CPESC No: 7878 RPEQ No: 19204 FOR AND ON BEHALF OF BAX ENGINEERING PTY. LTD.</p>		<p>PLAN No: 130-002-320</p>		<p>REVISION: A A1</p>	
<p>01/08/2021 ISSUED FOR INFORMATION TG GWA</p>		<p>01/08/2021 ISSUED FOR INFORMATION TG GWA</p>		<p>01/08/2021 ISSUED FOR INFORMATION TG GWA</p>		<p>01/08/2021 ISSUED FOR INFORMATION TG GWA</p>	

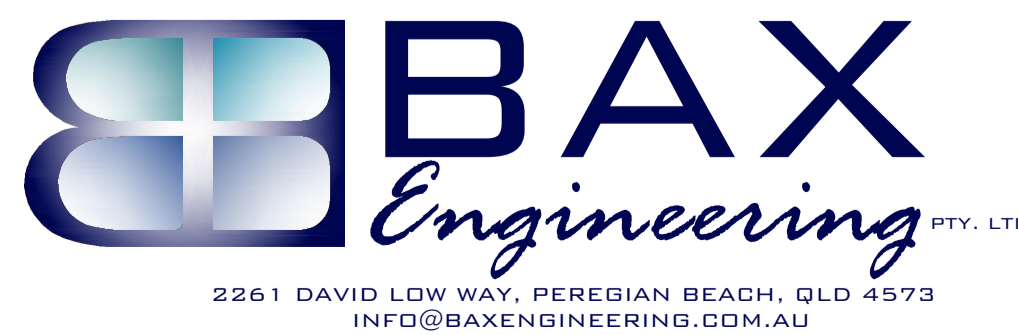

LONGREACH REGIONAL COUNCIL
DIGITALLY STAMPED
APPROVED PLAN

Development Application: Development Permit for Carrying Out Operational Work (Road Works, Access and Parking Works, Earthworks and Stormwater and Drainage Works)

Lot: Lot 1651 on SP309934

Referred to in Council's Decision Notice

Approval Date: 21 October 2021
Application Number: DA 21/22-007

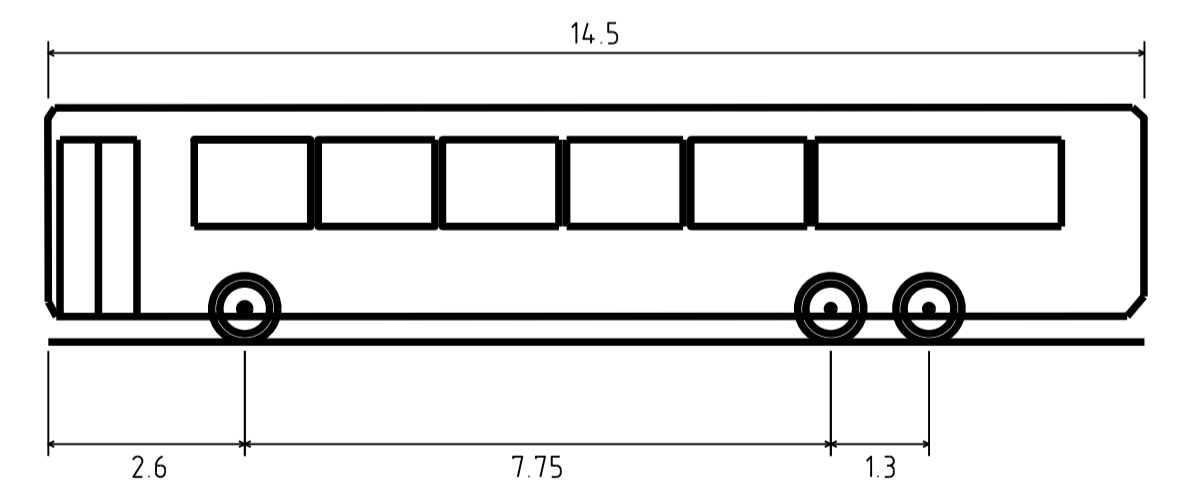
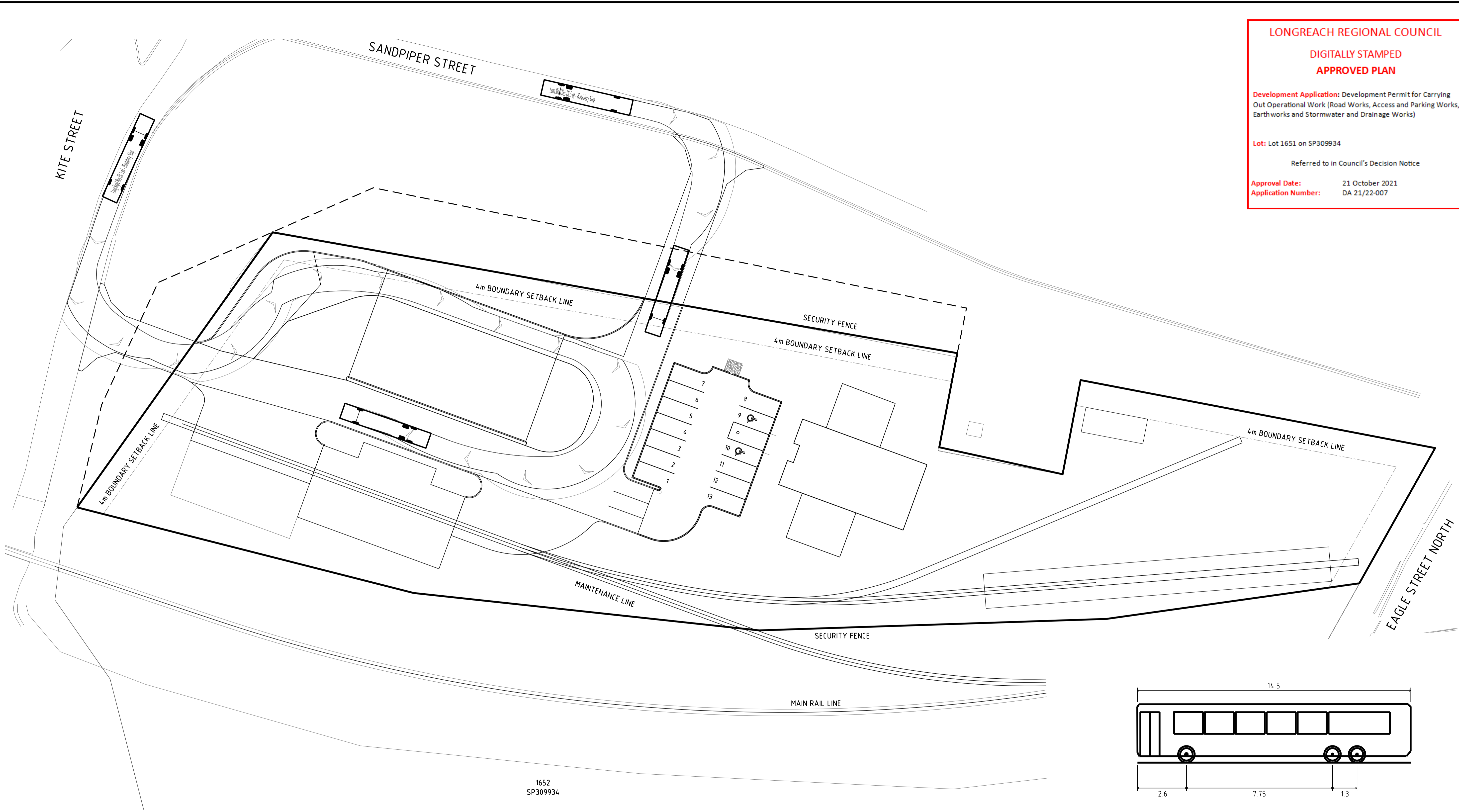

LONG RIGID BUS (14.5 m)	
OVERALL LENGTH	14.500m
OVERALL WIDTH	2.500m
OVERALL BODY HEIGHT	3.102m
MIN BODY GROUND CLRRANCE	0.337m
TRACK WIDTH	2.500m
LOCK-TO-LOCK TIME	6.00s
KERB TO KERB TURNING RADIUS	15.000m

1652
SP309934

	SCALE: 0 3 6 9 12 15m Scale 1:300 - A1(1:600 - A3)	SURVEYED: BJNORTH SURVEY DATUM: AHD	 2261 DAVID LOW WAY, PEREBIAN BEACH, QLD 4573 INFO@BAXENGINEERING.COM.AU	CLIENT: OUTBACK AUSSIE TOURS PROJECT: 95 EAGLE STREET, LONGREACH	NORTH POINT TITLE: SWEPT PATH PLAN
PROJECT NO: 130-002	DATE: 01/08/21	APPROVED: GLENN AINSWORTH CPESC No: 7878 RPEQ No: 19204			
LOCAL AUTHORITY APPROVAL NO: TG GWA	CHECKED: GWA	DRAWN: TG	DESIGNED: TG		
No. DATE REVISIONS BY CKD					PLAN No 130-002-360 REVISION A A1